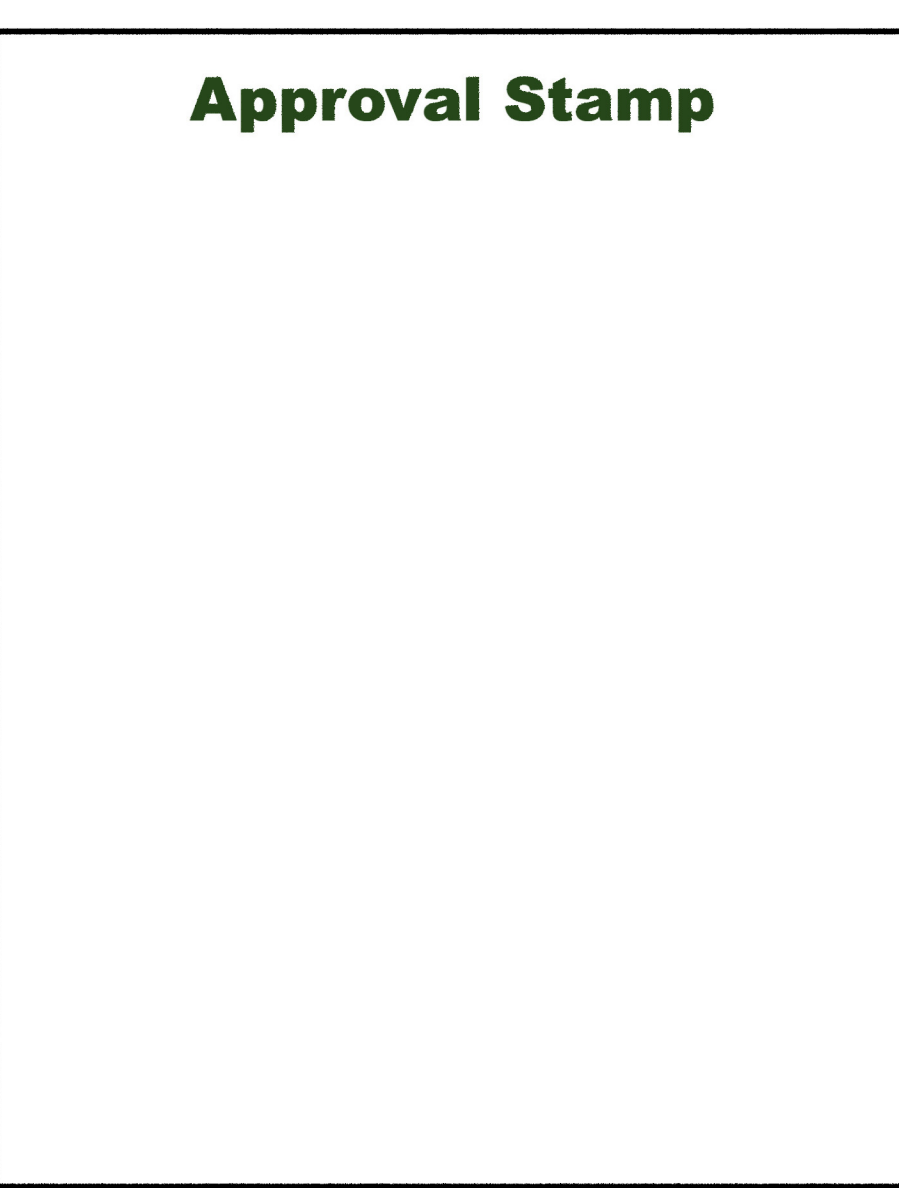
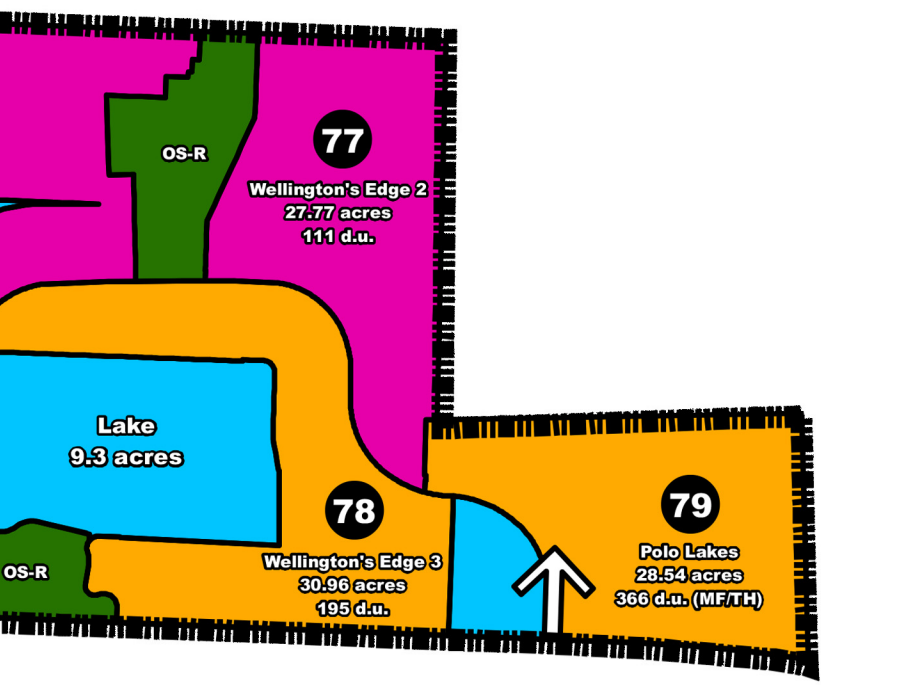
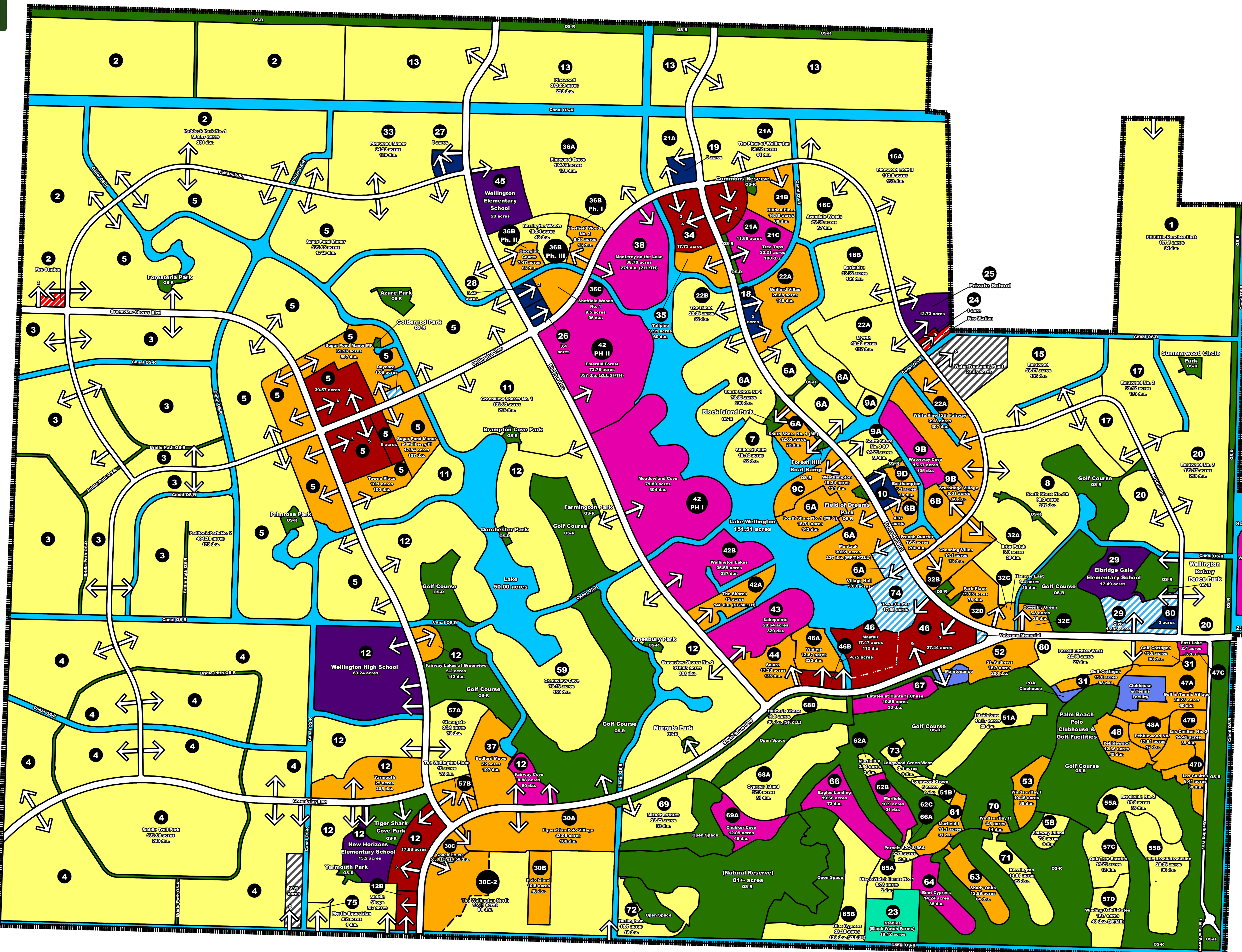
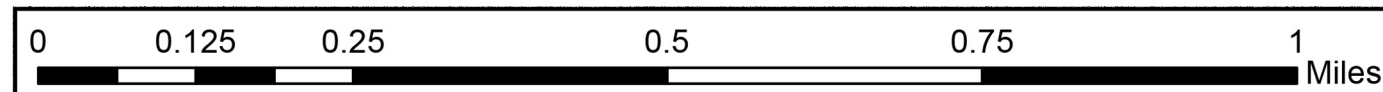
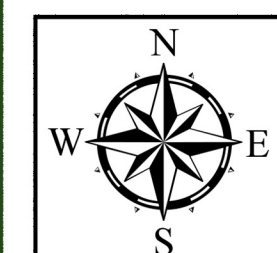
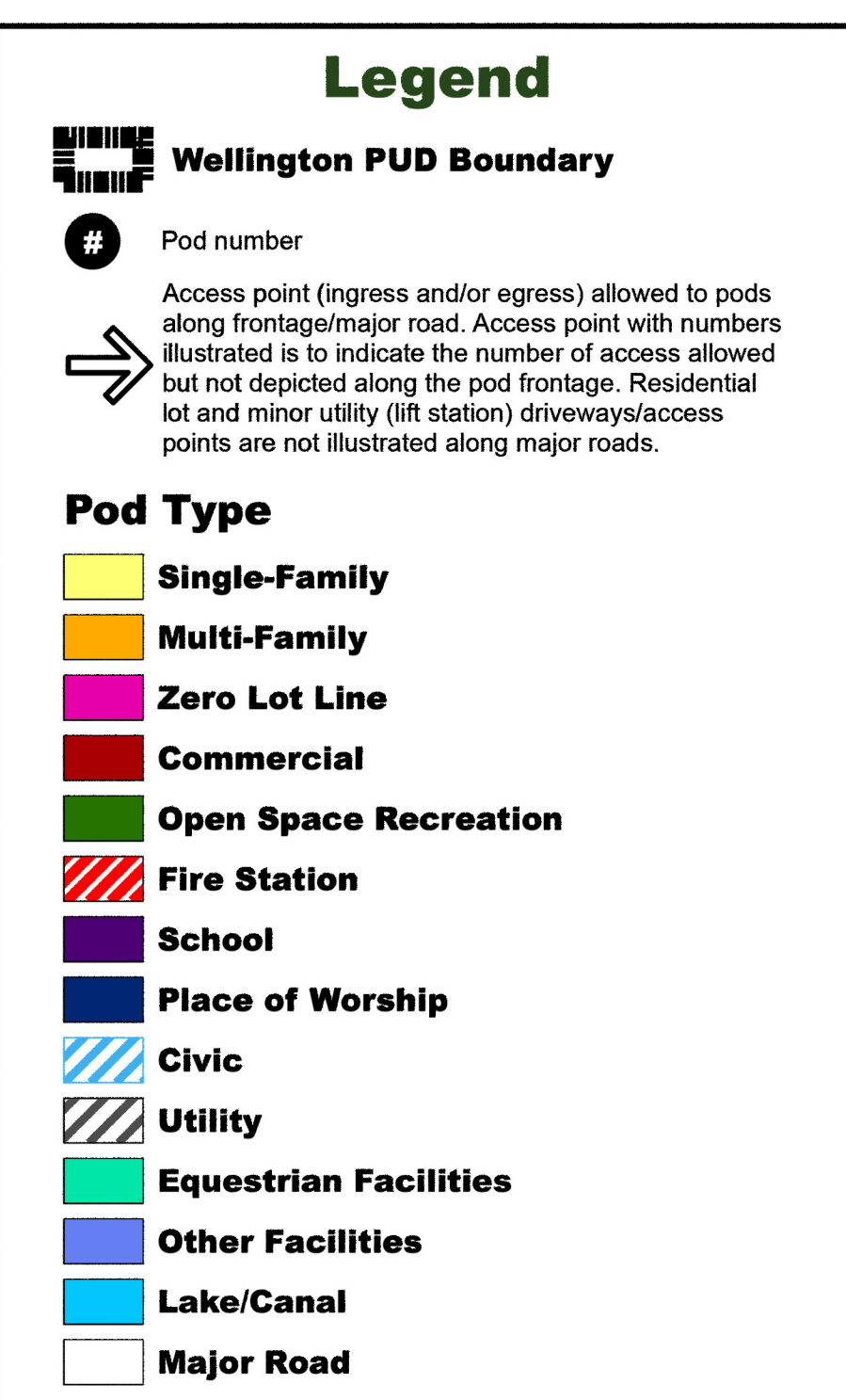
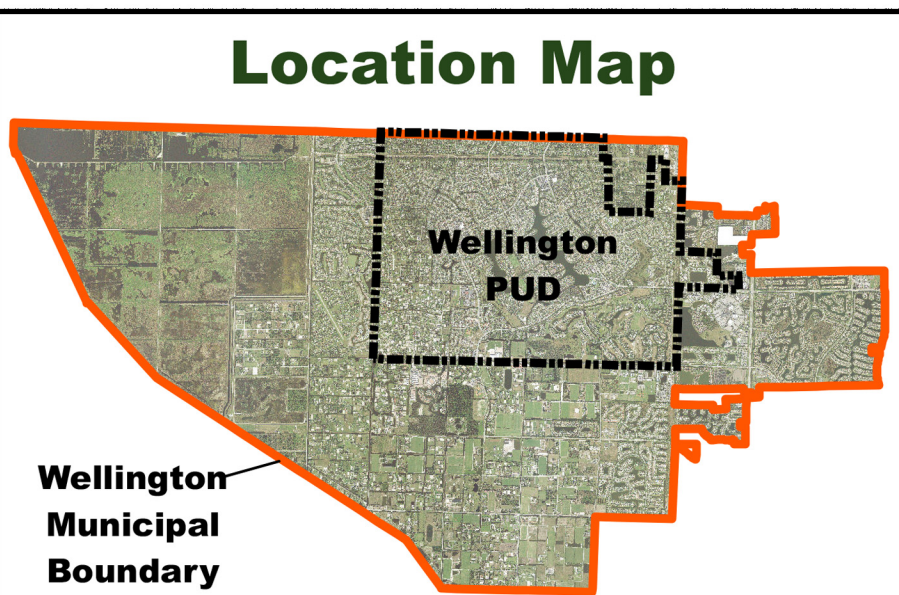

Exhibit J - Proposed Wellington PUD Master Plan





Pod Number	Pod Name	Number of Units	Pod Type	Acreage	Density
32C	Hanover East	15	Townhome	3.40	4.41
32D	Park Place	78	Townhome/Zero Lot Line	15.85	4.92
32E	Coventry Green	28	Townhome	5.80	4.83
33	Pinewood Manor	120	Single Family	64.23	1.87
34	Wellington Country Plaza	-	Commercial	17.73	-
35	Tallpine	60	Townhome	9.91	6.05
36A	Pinewood Grove	138	Single Family	104.84	1.32
36B Ph. I	Sheffield Woods No. 2	96	Multifamily	9.35	10.26
36B Ph. II	Georgian Courts	86	Townhome	7.47	11.51
36B Ph. III	Barrington Woods	45	Single Family	19.04	2.36
36C	Sheffield Woods No. 1	96	Multifamily	9.50	10.11
37	Bedford Mews	107	Townhome	22.00	4.86
38	Monterey on the Lake	271	Zero Lot Line/Townhome/Duplex	38.70	7.00
42 Ph. I	Meadowland Cove	304	Zero Lot Line	79.80	3.81
42 Ph. II	Emerald Forest	357	Zero Lot Line/Single Family/Townhome	72.78	4.91
42A	The Shores	140	Multifamily/Townhome/Single Family	15.00	9.33
42B	Wellington Lakes	237	Zero Lot Line	35.59	6.66
43	Lakepointe	320	Zero Lot Line	28.64	11.18
44	Solara	135	Multifamily	17.33	7.79
45	Wellington Elementary School	-	School	20.00	-
46	Town Square at Wellington/Mayfair	112	Commercial/Townhome	44.91	2.49
46A	Vinings	222	Multifamily	12.67	17.52
46B	Village Place	-	Commercial	4.75	-
47A	Golf & Tennis Village	60	Townhome	24.23	2.48
47B	Las Casitas No. 2	35	Townhome	14.42	2.43
47C	East Lake	6	Zero Lot Line	2.40	2.50
47D	Las Casitas	38	Townhome	9.41	4.04
48	Pebblewood	45	Multifamily	12.35	3.64
48A	Pebblewood No. 2	17	Townhome	7.61	2.23
51A	Maidstone	28	Single Family	19.17	1.46
51B	Longwood Green	9	Single Family	5.00	1.80
52	St. Andrews	200	Multifamily	16.70	11.98
53	Windsor Bay I	38	Townhome	10.46	3.63
55A	Brookside No. 2	35	Single Family	14.60	2.40
55B	Isle Brook/Brookside	38	Single Family	28.09	1.35
57A	Stonegate	76	Single Family	24.60	3.09
57B	The Wellington Place	78	Townhome	10.00	7.80
57C	Oak Tree Estates	12	Single Family	14.23	0.84
57D	Winding Oak Estates	40	Single Family/Multifamily	16.70	2.40
58	Fairway Island	9	Single Family	7.30	1.23
59	Greenview Cove	159	Single Family	76.19	2.09
60	St. Michael Lutheran Place of Worship	-	Place of Worship	3.00	-
61	Murfield I	31	Townhome	11.10	2.79
62A	Murfield A	3	Single Family	2.54	1.18
62B	Murfield	31	Zero Lot Line	10.90	2.84
62C/66A	Parcels 62C & 66A	2	Single Family	2.79	0.72
63	Shady Oaks	64	Duplex	12.89	4.97
64	Bent Cypress	38	Zero Lot Line	14.24	2.67
65A	Black Watch Farms No. 1	2	Single Family	9.73	0.21
65B	Blue Cypress	109	Single Family/Zero Lot Line	28.25	3.86
66	Eagles Landing	73	Zero Lot Line	19.56	3.73
67	Estates at Hunter's Chase	30	Zero Lot Line	10.55	2.84
68A	Cypress Island	31	Single Family	37.30	0.83
68B	Hunter's Chase	36	Single Family/Zero Lot Line	16.90	2.13
69	Mizner Estates	33	Single Family	23.22	1.42
69A	Chukker Cove	48	Zero Lot Line	12.09	3.97
70	Windsor Bay II	14	Townhome	4.50	3.11
71	Kensington	22	Single Family	14.88	1.48
72	Hurlingham	19	Single Family	15.70	1.21
73	Longwood Green West	9	Single Family	3.40	2.65
74	Town Center	-	Civic	17.65	-
75	Mystic Equestrian	1	Single Family	4.20	0.24
76	Wellington's Edge 1	199	Zero Lot Line	44.14	4.51
77	Wellington's Edge 2	111	Zero Lot Line	27.77	4.00
78	Wellington's Edge 3	195	Townhome	30.96	6.30
79	Polo Lakes	366	Multifamily	28.54	12.83
80	Farrell Estates West	27	Single Family	22.98	1.17
	Total Units	14472			

Approval Stamp

 THE VILLAGE OF
WELLINGTON



Planning and Zoning Division

Certification

Resolution No. R2023-11

Approved by Council: Judy 11.
2023

DRM: Kelly Ferraiolo

Refer to Resolutions listed in the Revisions table for conditions for each approval.