

GENERAL NOTES:

- ALL ELEVATIONS ARE REFERENCED TO THE NORTH AMERICAN VERTICAL DATUM OF 1988 (NAVD88).
- ALL COORDINATES ARE NORTH AMERICAN DATUM OF 8390.
- ALL LOCATIONS AND ELEVATIONS SHOWN FOR EXISTING GRADES FOR SURFACE AND SUBSURFACE STRUCTURES, PIPING, ETC. ARE BASED ON RECORD DRAWINGS AND THE BEST AVAILABLE INFORMATION. WHILE EVERY ATTEMPT HAS BEEN MADE TO PROVIDE ACCURATE DATA, THE CONTRACTOR SHALL CONSIDER ALL LOCATIONS AND ELEVATIONS APPROXIMATE IN NATURE. PRIOR TO THE START OF CONSTRUCTION AND/OR ORDERING OF ANY MATERIALS OR FABRICATED ITEMS, THE CONTRACTOR SHALL PRETRENCH TO CONFIRM THE EXACT LOCATIONS, ELEVATIONS, AND ALL CONFLICTS. IN ADDITION, THE CONTRACTOR SHALL BE RESPONSIBLE TO VERIFY IF "OTHER" STRUCTURES, UTILITIES, ETC. NOT SHOWN ON THE DRAWINGS EXIST WITHIN THE AREA OF CONSTRUCTION. THE CONTRACTOR SHALL PROVIDE AS-BUILT INFORMATION AND WRITTEN NOTIFICATION OF ALL CONFLICTS WITH THE PROPOSED CONSTRUCTION TO THE ENGINEER. THE CONTRACTOR SHALL NOT PROCEED WITH ANY WORK UNTIL ALL CONFLICTS HAVE BEEN RESOLVED.
- ALL PROPOSED GRADES SHOWN ARE FINISHED GRADES, UNLESS OTHERWISE NOTED. THE CONTRACTOR SHALL SLOPE FINISHED GRADES UNIFORMLY BETWEEN OTHER FINISHED AND EXISTING GRADES.
- CONTRACTOR SHALL BE RESPONSIBLE FOR ALL REMOVAL, DISPOSAL, ABANDONMENT, AND RELOCATIONS NECESSARY TO COMPLETE THE WORK WHETHER SHOWN ON THE DRAWINGS OR NOT. CONTRACTOR SHALL COORDINATE RELOCATIONS WITH THE NECESSARY UTILITY COMPANIES.
- CONTRACTOR SHALL RESTORE ALL AREAS DISTURBED OUTSIDE THE LIMITS OF CONSTRUCTION BY THE CONTRACTOR'S ACTIVITIES INVOLVING CONSTRUCTION, STAGING AREAS, AND ACCESS ROADS IN KIND. ALL DISTURBED NON-PAVED AREAS SHALL BE SOODED WITH GRASS OF SIMILAR VARIETY AND PROVIDE WATER IF NECESSARY TO ENSURE GROWTH.
- CONTRACTOR SHALL COORDINATE WITH THE NECESSARY UTILITY COMPANIES AND SUNSHINE STATE ONE CALL (800-432-4770) FOR ALL UTILITY LOCATES 48 HOURS PRIOR TO COMMENCEMENT OF CONSTRUCTION.
- CONTRACTOR SHALL SUBMIT M.O.T. PLAN AS REQUIRED IN THE PROJECT SPECIFICATIONS FOR REVIEW BY THE VILLAGE OF WELLINGTON AND IS REQUIRED TO ACQUIRE ALL M.O.T. PERMITS FOR THE PROJECT.
- ALL DEMOLITION SHALL CONFORM TO ALL FEDERAL, STATE AND LOCAL LAWS, RULES, AND ORDINANCES PERTAINING TO THE DEMOLITION OF MATERIALS.
- CONTRACTOR SHALL MAINTAIN A NEAT, ORDERLY, AND SAFE SITE AT ALL TIMES.
- CONTRACTOR SHALL UTILIZE CONSTRUCTION METHODS AND DEVICES SUCH AS TURBIDITY CURTAINS, SILT FENCES AND FLOTTING SILT BARRIERS WHERE NECESSARY IN ORDER TO COMPLY WITH THE STATE AND LOCAL WATER QUALITY STANDARDS AND NATIONAL POLLUTION DISCHARGE ELIMINATION SYSTEM (N.P.D.E.S.) REQUIREMENTS.
- CONTRACTOR SHALL LIMIT ACCESS AND CONSTRUCTION OPERATIONS TO WITHIN LIMITS OF CONSTRUCTION. THE CONTRACTOR SHALL BE SOLELY RESPONSIBLE FOR ANY DAMAGES OUTSIDE THE LIMITS OF CONSTRUCTION.
- ALL SURVEY MONUMENTS WITHIN LIMITS OF CONSTRUCTION ARE TO BE PROTECTED. IF IN DANGER OF DAMAGE THE CONTRACTOR SHALL NOTIFY: NATIONAL GEODETIC INFORMATION SERVICES CENTER NOAA NATIONAL GEODETIC SURVEY, NCG 17 SMC 3, STATION 09202 SILVER SPRING, MARYLAND 20910 TELEPHONE NO. (301) 713-3242.
- ALL WORK SHALL BE PERFORMED IN ACCORDANCE WITH THE FLORIDA DEPARTMENT OF TRANSPORTATION (FDOT) STANDARD SPECIFICATIONS FOR ROAD AND BRIDGE CONSTRUCTION, 2017 EDITION, AND FDOT DESIGN STANDARDS, 2017 EDITION. ALL FDOT INDEXES ARE INCORPORATED AS PLAN REFERENCES HEREIN. CONTRACTOR IS RESPONSIBLE FOR OBTAINING COMPLETE 2017 EDITION OF FDOT INDEXES.
- PRIOR TO COMMENCEMENT OF ANY EXCAVATION, THE CONTRACTOR SHALL COMPLY WITH CHAPTER 556 OF THE FLORIDA STATUTES: THE UNDERGROUND FACILITY DAMAGE PREVENTION AND SAFETY ACT.
- SOURCE AND DATE OF AERIAL PHOTOGRAPHY: PISC GIS DATED 2019
- ALL WORK SHALL BE OPEN AND SUBJECT TO INSPECTION BY AUTHORIZED PERSONNEL OF THE VILLAGE, INVOLVED UTILITY COMPANIES, PROJECT ENGINEER AND REGULATORY AGENCIES.
- ALL STRUCTURES SHALL BE INSTALLED IN A CLEAN, DRY PIT. DEWATERING AS REQUIRED SHALL BE AT THE CONTRACTOR'S EXPENSE.
- WHERE EXCAVATIONS TO A DEPTH IN EXCESS OF FIVE FEET (5') ARE REQUIRED, THE CONTRACTOR SHALL INCLUDE THE FOLLOWING INFORMATION IN THE BID:
 - REFERENCE TO THE TRENCH SAFETY STANDARDS THAT WILL BE IN EFFECT DURING THE PERIOD OF CONSTRUCTION OF THE PROJECT.
 - WRITTEN ASSURANCES BY THE CONTRACTOR PERFORMING THE TRENCH EXCAVATION THAT SUCH CONTRACTOR WILL COMPLY WITH THE FLORIDA TRENCH SAFETY ACT.
 - A SEPARATE ITEM IDENTIFYING THE COST OF COMPLIANCE WITH THE APPLICABLE TRENCH SAFETY STANDARDS.
- ALL OPEN TRENCHES AND HOLES ADJACENT TO ROADWAYS OR WALKWAYS SHALL BE PROPERLY MARKED AND BARRICADED TO ASSURE THE SAFETY OF BOTH VEHICULAR AND PEDESTRIAN TRAFFIC. NO TRENCHES OR HOLES NEAR WALKWAYS OR IN ROADWAYS OR THEIR SHOULDERS ARE TO BE LEFT OPEN DURING NIGHT HOURS.
- PRIOR TO CONSTRUCTION, THE CONTRACTOR SHALL BE REQUIRED TO SUBMIT A CONSTRUCTION SCHEDULE DEPICTING EACH PHASE OF THE WORK.
- THE CONTRACTOR SHALL PROMPTLY REMOVE ALL MUD, DIRT OR OTHER MATERIALS TRACKED OR SPILLED ONTO EXISTING PUBLIC ROADS AND FACILITIES DUE TO CONSTRUCTION.
- ALL EXCESS FILL FROM THE SITE SHALL BE LEGALLY DISPOSED OF OFF SITE BY THE CONTRACTOR.
- ALL ORGANIC AND UNSUITABLE MATERIAL IN AREAS TO BE FILLED SHALL BE REMOVED AND REPLACED IN ACCORDANCE WITH SOUND CONSTRUCTION PRACTICES.
- ALL UTILITIES SHALL BE ADJUSTED TO NEW FINISH GRADES AND PROPERLY SET TO PAVEMENT CROSS SLOPE AS REQUIRED.
- THE CONTRACTOR SHALL COORDINATE WITH THE VILLAGE REPRESENTATIVE FOR THE SELECTION OF PROPOSED CONSTRUCTION STAGING AREAS AND/OR STOCKPILING OF MATERIALS.

SURVEY SYMBOL LEGEND:

	6" DIP 90° PIPE BEND
	AIR RELEASE VALVE
	BACKFLOW PREVENTER
	BENCH MARK
	CLEAN OUT
	CONTROL PANEL
	ELECTRIC METER BOX
	EXISTING ELEVATION
	EXISTING ELEVATION
	FENCE LINE
	IRRIGATION CONTROL VALVE
	METAL POST
	GREEN PAINT MARK
	RADIO TELEMETRY UNIT
	RECLAM WATER METER
	SANITARY MANHOLE
	SANITARY VALVE
	SPIGOT

SURVEY LEGEND:

BFP	BACKFLOW PREVENTER
CLF	CHAIN LINK FENCE
CONC	CONCRETE
E	EAST
EL	ELEVATION
INV	INVERT
IRR	IRRIGATION
LSA	LANDSCAPE AREA
N	NORTH
NAV	NORTH AMERICAN VERTICAL DATUM OF 1988
NGVD	NATIONAL GEODETIC VERTICAL DATUM OF 1929
PG(S)	PAGE(S)
PBC	PALM BEACH COUNTY
PRCR	PALM BEACH COUNTY RECORDS
PLD	PLANNED UNIT DEVELOPMENT
PVC	POLYVINYL CHLORIDE
PB	PLAT BOOK
RIW	RIGHT OF WAY
S	SOUTH
TN	TOP OF NUT
TOP	TOP OF PIPE
UNK	UNKNOWN
W	WEST, WIDTH

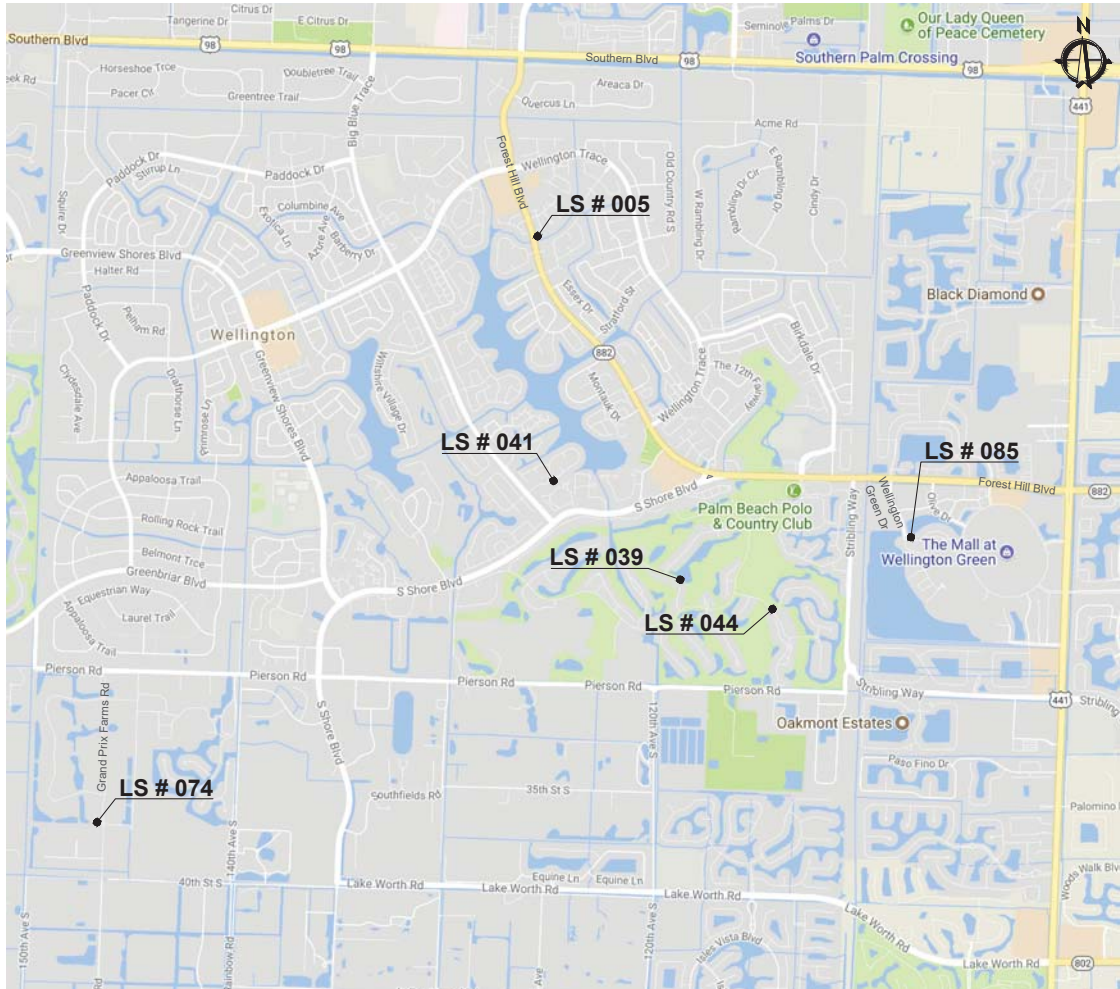

© 2017 GOOGLE - MAP DATA © 2017 GOOGLE

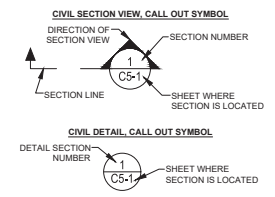

CONTRACTOR SHALL VERIFY ALL DIMENSIONS ACCORDINGLY
 DIMENSIONS SHALL BE EQUAL TO ONE INCH ON ORIGINAL DRAWING
 DIMENSIONS SHALL BE EQUAL TO ONE INCH ON ORIGINAL DRAWING

MOCK ROOS CONSULTING ENGINEERS 6720 S.W. 11th Way, Suite 407 Ft. Lauderdale, FL 33311 (561) 583-3113, www.mockroos.com	VICINITY MAP, GENERAL NOTES AND LEGENDS WASTEWATER PUMP STATION NO. 005, 039, 041, 044, 074, AND 085 REHABILITATION VILLAGE OF WELLINGTON PALM BEACH COUNTY, FLORIDA	M-H R.P.A. NO.: 87710.00 M-H R.DWG. NO.: 44-41-03-01 DWG INDEX C0-2 SHEET NO. 2 OF 71	JOHN P. CARNES FLORIDA P.E. NO. 74737 DATE	REVISION NO. DATE BY NO. DATE BY NO. DATE BY
DATES: SEPTEMBER 2018 DRAWN: JPC DESIGN: JPC APPR: GGG SCALE: 1" = 20' F.L. NO. 48				