

BIKE ROOM

DESIGN GUIDE



DERO
A PLAYCORE Company



A WELL-DESIGNED **BIKE ROOM**

considers everyone's needs, from the property owner looking to get the most value from their space to the end-user seeking convenient, functional, and secure bike parking. Taking into consideration the layout of your space, the anticipated capacity you will need to meet, and the different styles of bikes to be parked will ensure happy building owners and much appreciated peace-of-mind for end users.

**KNOW
YOUR
SPACE**

Carefully note the dimensions and details of your space, including a scalable measurement. This will expedite the drawing of your bike room and avoid issues when it comes time to install.

Submitting an architectural overhead works best, but please make sure there is at least one measurement so your designer can appropriately scale the room. Hand-drawings can work too, but require much more detail.

Note the vertical clearance of any obstructions like ductwork, pipes, and light fixtures.

Send us a drawing of your space including all doors, pillars, low-hanging pipes and obstructions. Verify with your designer to make sure the room has adequate vertical space for the racks you are interested in.

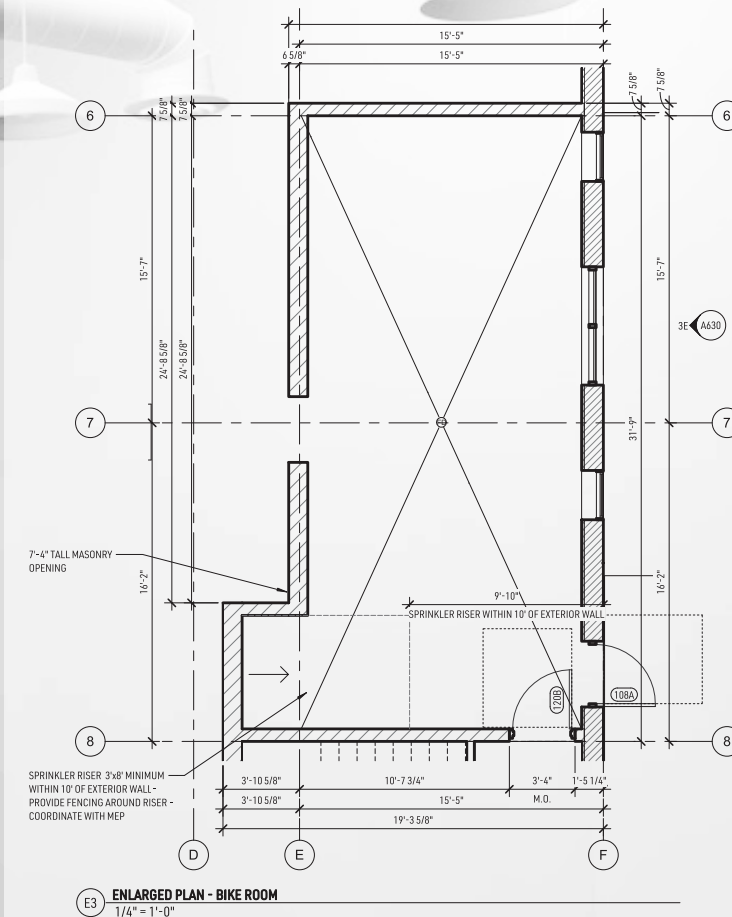

CONSIDER ALL USERS

The most space-efficient parking options do not necessarily work well for everyone, so a little variety will go a long way toward making your facility inclusive and accessible to all users.

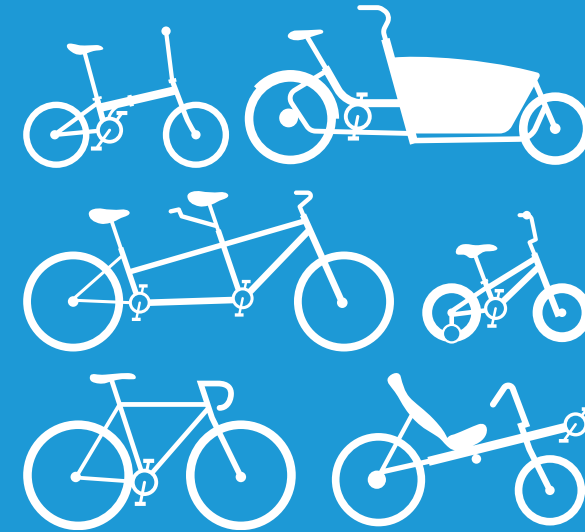

DIFFERENT SPOKES

Bikes vary a great deal in size, weight, and geometry. Be sure to consider users with larger and wider bikes like cargo and recumbent bikes.

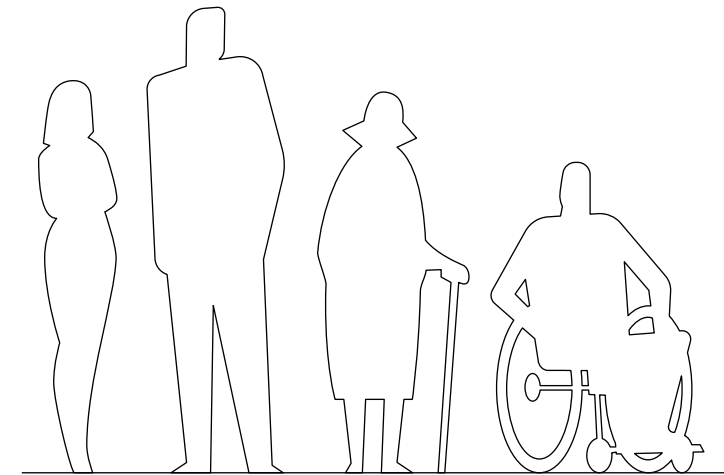

DIFFERENT FOLKS

People's physical abilities and needs vary a lot too. Not every user has the strength to hoist a bike into a top-tier or vertical rack.

RACK TYPES



HORIZONTAL PARKING

“Traditional-use” bike parking that is easily-accessible with a bike’s two wheels on the ground. These racks are highly versatile.



- » Cyclists are familiar with them
- » Easy to use and install
- » Cost-effective



- » Because the bikes have both wheels on the ground they take up more space



VERTICAL PARKING

“Max capacity” bike parking saves space on the ground by pivoting the bike onto its rear wheel and lifting it to the hook.



- » Higher-capacity
- » Often modular
- » Great for smaller spaces



- » Tough for heavier bikes, not everyone wants to or is physically able to lift their bike. Not suitable for trikes, bakfiets, cargo bikes, etc.



TWO-TIER PARKING

“Premium” bike parking that offers the space-efficiency of vertical racks and the broader accessibility of horizontal racks.



- » Space-efficient
- » Incorporates ground-level parking



- » Higher cost per bike parked than most other styles

TYPICAL SPACE USE BY TYPE

These diagrams give you an idea of the space occupied by parked bikes. Exact dimensions will vary by product.

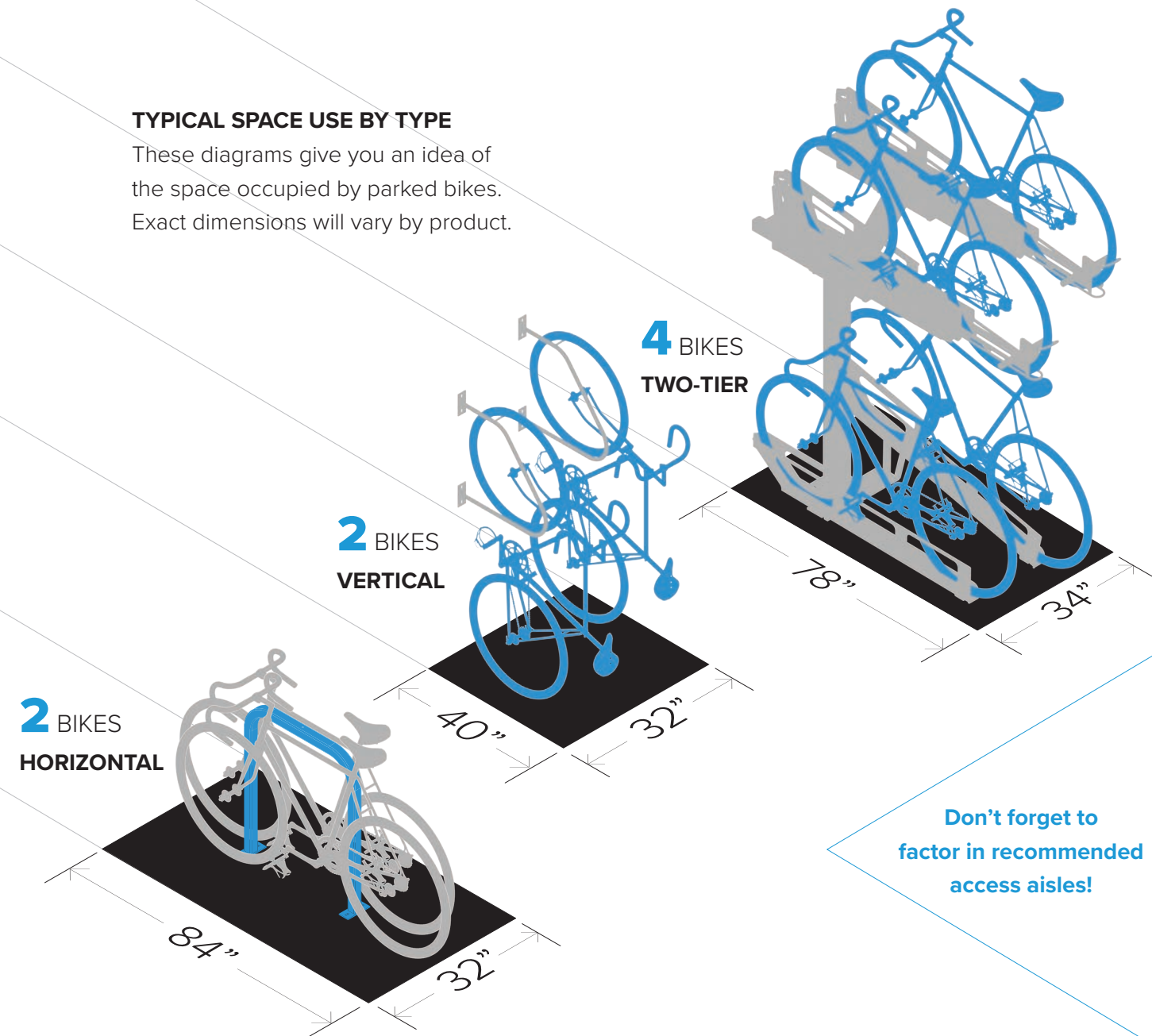

Don't forget to factor in recommended access aisles!

COMMON PITFALLS

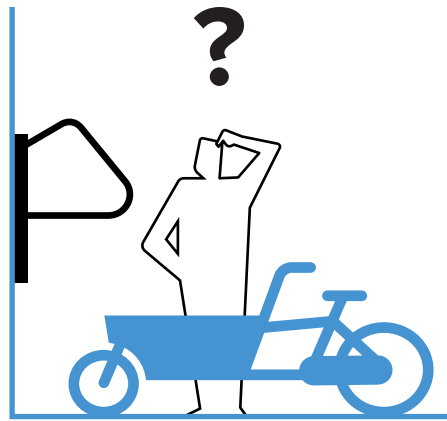

NOT ENOUGH PARKING OPTIONS

Provide both vertical and horizontal bike parking options for those who are unable to lift their bicycles onto vertical racks. Work with your designer to hit your quantities while making sure your parking is accessible to all end-users.

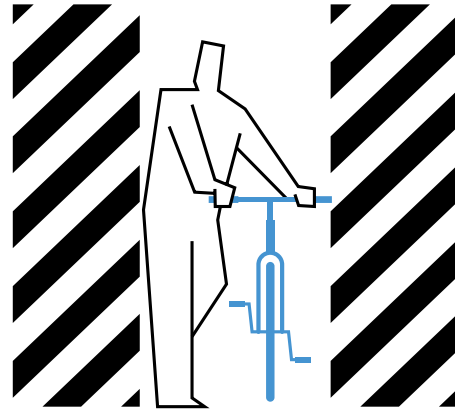

NOT ENOUGH AISLE SPACE

Aisle space is incredibly important for people to maneuver their bikes and to not feel cramped. Injuries and damage to bikes are more likely to occur when not enough space is provided between racks.

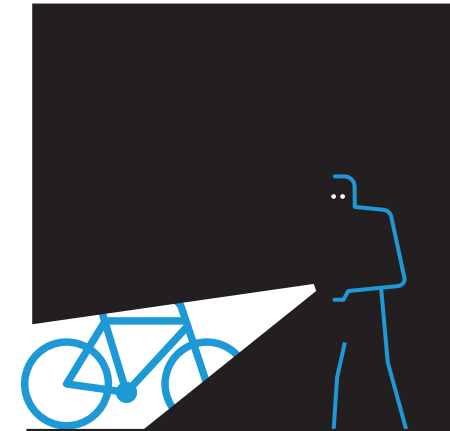

INSUFFICIENT LIGHTING

Users shouldn't have to worry about tripping hazards or bumping into things especially if the area is a corridor with light only at the front.

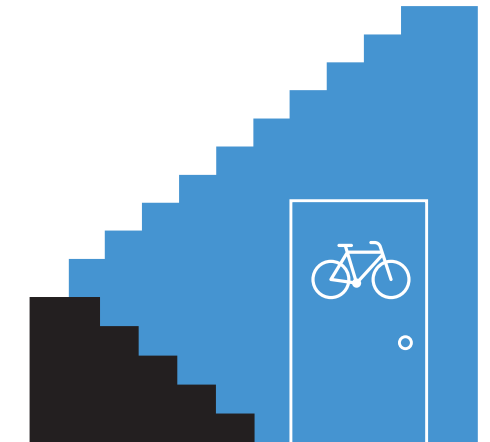

POOR ACCESS

Avoid steps, too many hallways, and corridors to gain access. Instead, locate your bike room near elevators and convenient places that have easy access to rest of the property.

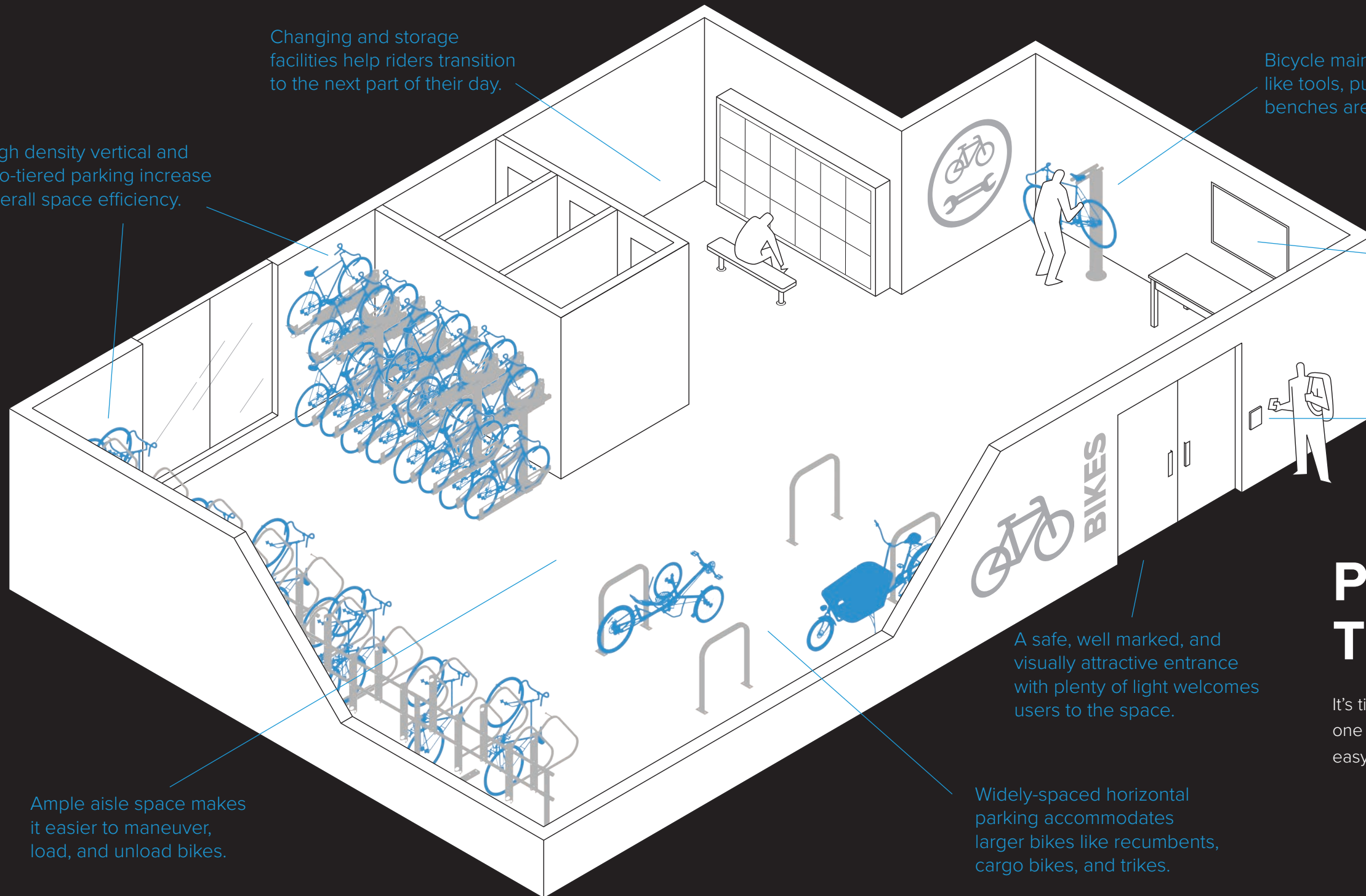

High density vertical and two-tiered parking increase overall space efficiency.

Changing and storage facilities help riders transition to the next part of their day.

Bicycle maintenance amenities like tools, pumps, and work benches are useful additions.

Message boards can offer maps of local routes and improve communication with your users.

Keyed or swipe-card access provides additional security.

Ample aisle space makes it easier to maneuver, load, and unload bikes.

A safe, well marked, and visually attractive entrance with plenty of light welcomes users to the space.

Widely-spaced horizontal parking accommodates larger bikes like recumbents, cargo bikes, and trikes.

PUTTING IT TOGETHER

It's time to combine everything you have learned into one great facility that is not only space efficient, but safe, easy, and enjoyable for everyone to use.

LEADING BY EXAMPLE



WELCOMING ENTRANCE

Friendly graphics, bright lighting, and a convenient work table greet riders at the entryway to this well-used bike room.



CHILL VIBES

A couple of comfortable chairs and bike-themed art invite cyclists to relax and hang out before or after their ride.



CONVENIENT ACCESS

A ramp from an elevated outdoor entry point lets people on wheels roll easily to this bike room.

We love to see a bike room done well, and so will your users. Here are some examples of facilities we have come across that thoughtfully included many of the ideas discussed in this guide.



AMENITY RICH

This room includes bike racks, a repair station, lockers, restrooms, and a lounge area – all wrapped in a striking, modern design scheme.

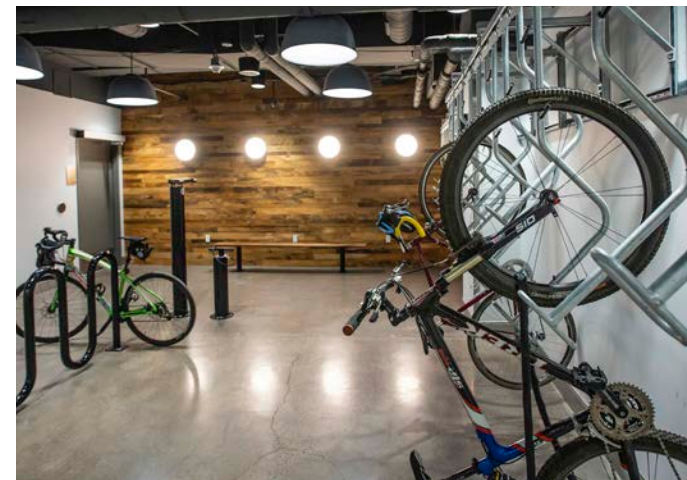

CHECKING ALL THE BOXES

Multiple parking options and public tools, along with places to change, clean up, and store items make this simple room very convenient.



A BIT OF EVERYTHING

Well-lit and spacious, with loads of amenities and parking options, this building's bike room is a top selling feature.