

LOTIS WELLINGTON
WELLINGTON, FL
SITE AMENITIES PLAN
ARCHITECTURAL REVIEW BOARD



Consultants:

Revisions:

7/17/2023 - RESUBMITTAL

0/02/2023 - REVISION

[illegible]

LOTIS WELLINGTON
Wellington, Florida

Drawn By: RG

Drawing #: 1076

ate: 01/31/2022

E AMENITIES
OVER PAGE

SHEET # SA.0

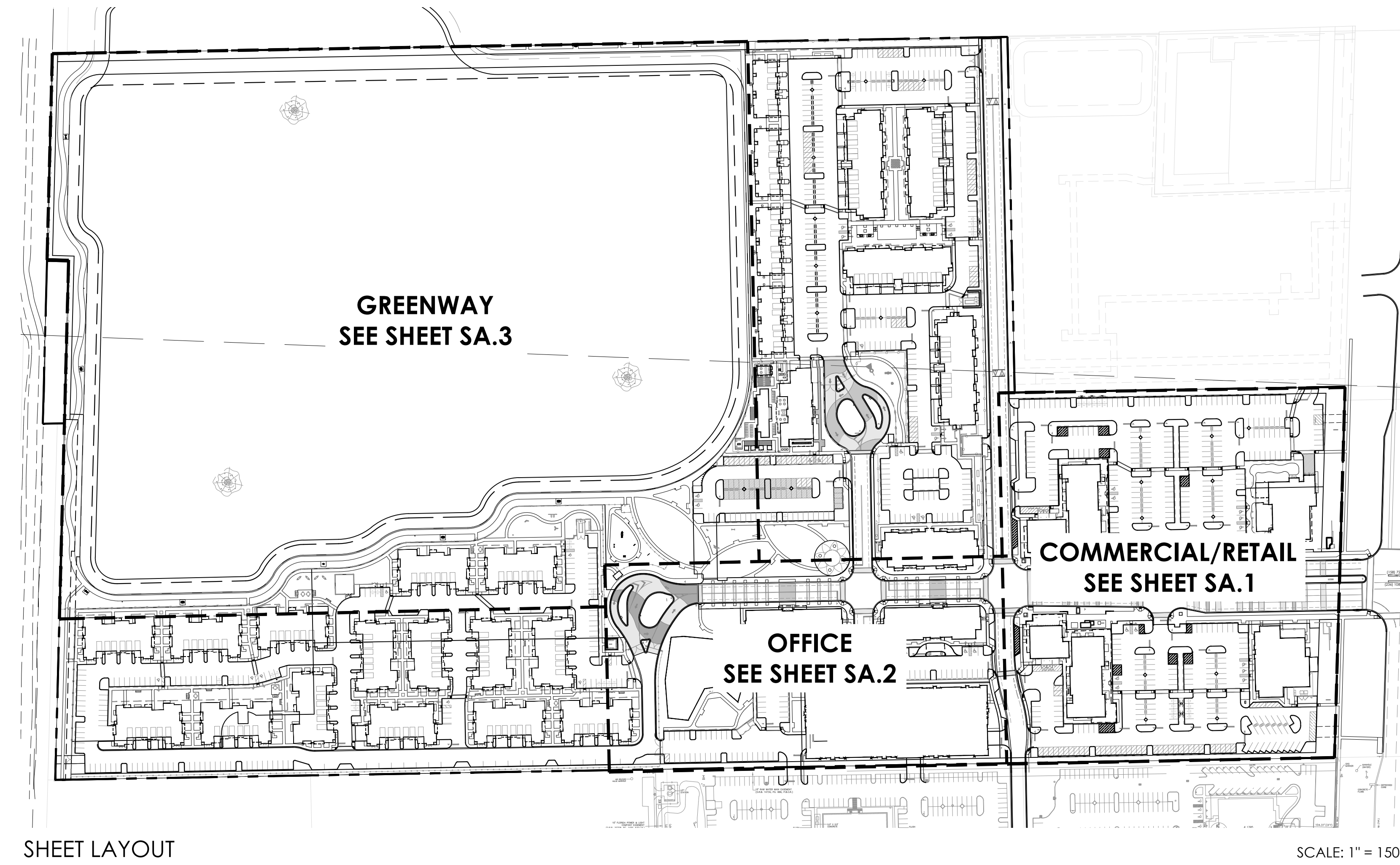

SHEET LAYOUT

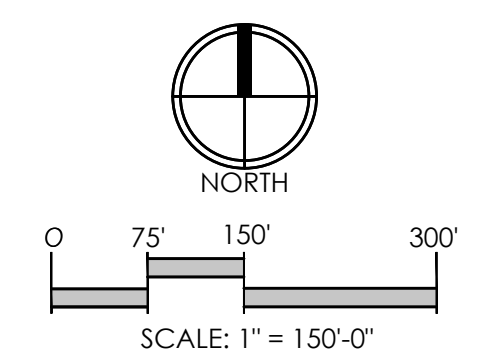

SCALE: 1" = 150'

NOTE: ALL REVISED OR ADDED ITEMS HAVE BEEN CLOUDED FOR EASE OF REFERENCE.

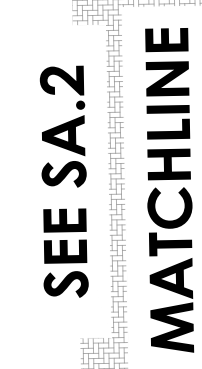



A close-up photograph of dark grey interlocking bricks. The bricks are arranged in a staggered pattern, showing their rectangular shape and the recessed grooves that allow them to lock together. The surface has a slightly textured, matte finish.



A close-up photograph of a stone wall, showing rectangular stones in shades of grey and brown, arranged in a regular pattern with visible mortar joints.

[illegible]

SITE AMENITIES
PLAN
(RETAIL/COMMERCIAL)

SHEET # SA.1

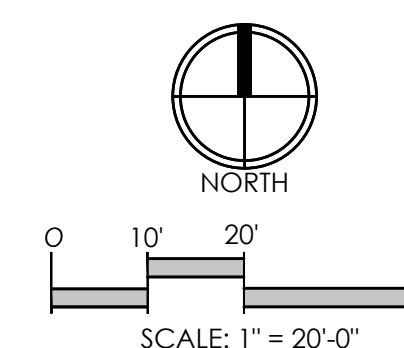

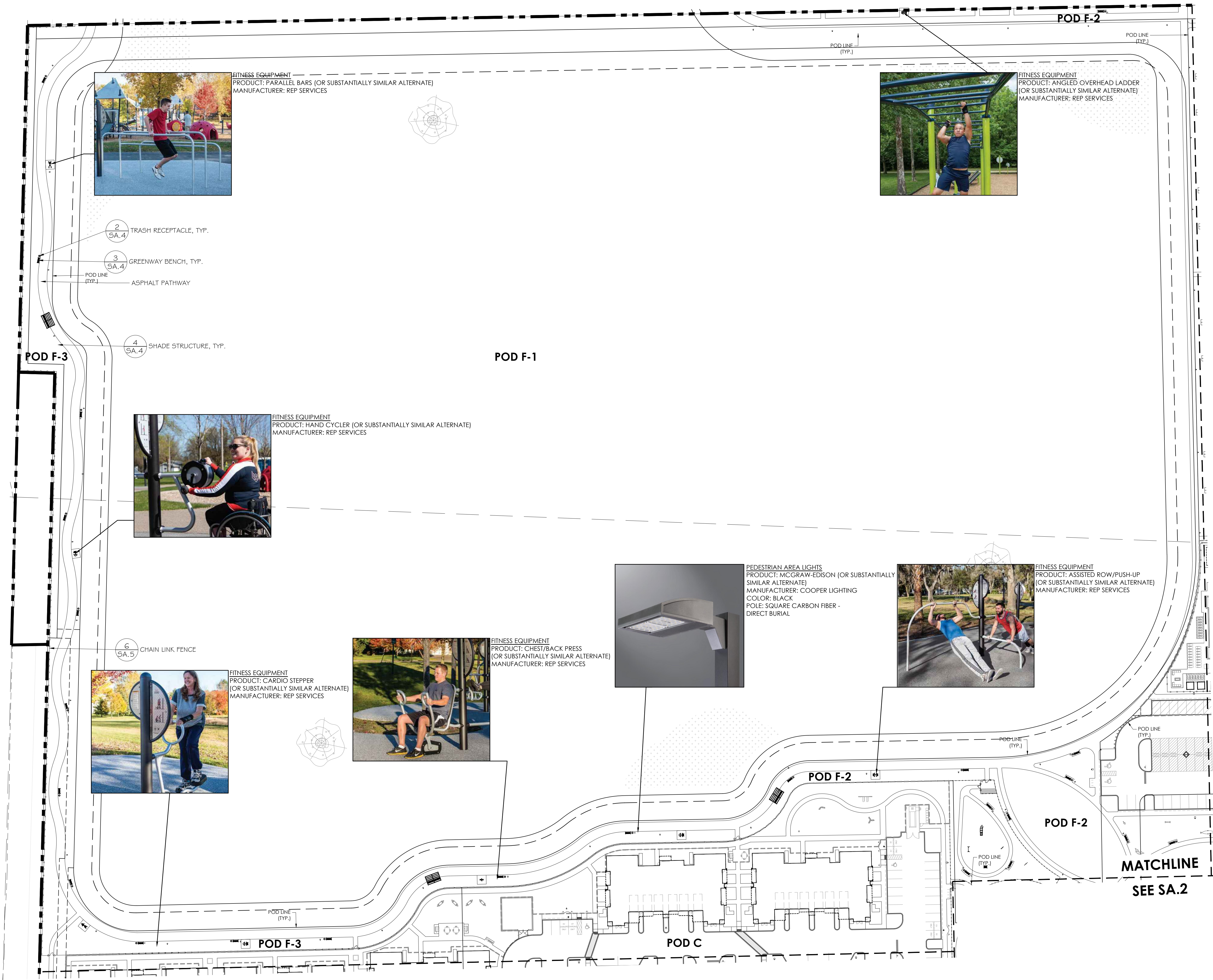

FITNESS EQUIPMENT
PRODUCT: PARALLEL BARS (OR SUBSTANTIALLY SIMILAR ALTERNATE)
MANUFACTURER: REP SERVICES



FITNESS EQUIPMENT
PRODUCT: ANGLED OVERHEAD LADDER
(OR SUBSTANTIALLY SIMILAR ALTERNATE)
MANUFACTURER: REP SERVICES

2
SA.4 TRASH RECEPTACLE, TYP.

3
SA.4 GREENWAY BENCH, TYP.

POD LINE (TYP.)
ASPHALT PATHWAY

4
SA.4 SHADE STRUCTURE, TYP.

POD F-1



FITNESS EQUIPMENT
PRODUCT: HAND CYCLER (OR SUBSTANTIALLY SIMILAR ALTERNATE)
MANUFACTURER: REP SERVICES

6
SA.5 CHAIN LINK FENCE



FITNESS EQUIPMENT
PRODUCT: CARDIO STEPPER
(OR SUBSTANTIALLY SIMILAR ALTERNATE)
MANUFACTURER: REP SERVICES



FITNESS EQUIPMENT
PRODUCT: CHEST/BACK PRESS
(OR SUBSTANTIALLY SIMILAR ALTERNATE)
MANUFACTURER: REP SERVICES



PEDESTRIAN AREA LIGHTS
PRODUCT: MCGRAW-EDISON (OR SUBSTANTIALLY
SIMILAR ALTERNATE)
MANUFACTURER: COOPER LIGHTING
COLOR: BLACK
POLE: SQUARE CARBON FIBER -
DIRECT BURIAL



FITNESS EQUIPMENT
PRODUCT: ASSISTED ROW/PUSH-UP
(OR SUBSTANTIALLY SIMILAR ALTERNATE)
MANUFACTURER: REP SERVICES

MATCHLINE
SEE SA.2

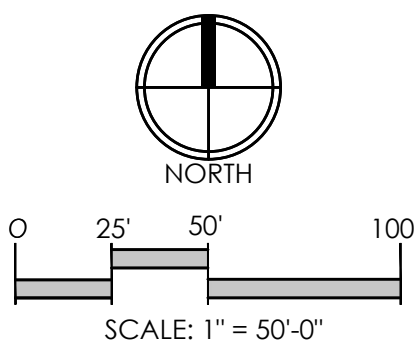

Consultants:

Revisions:
07/17/2023 - RESUBMITTAL
10/02/2023 - REVISION









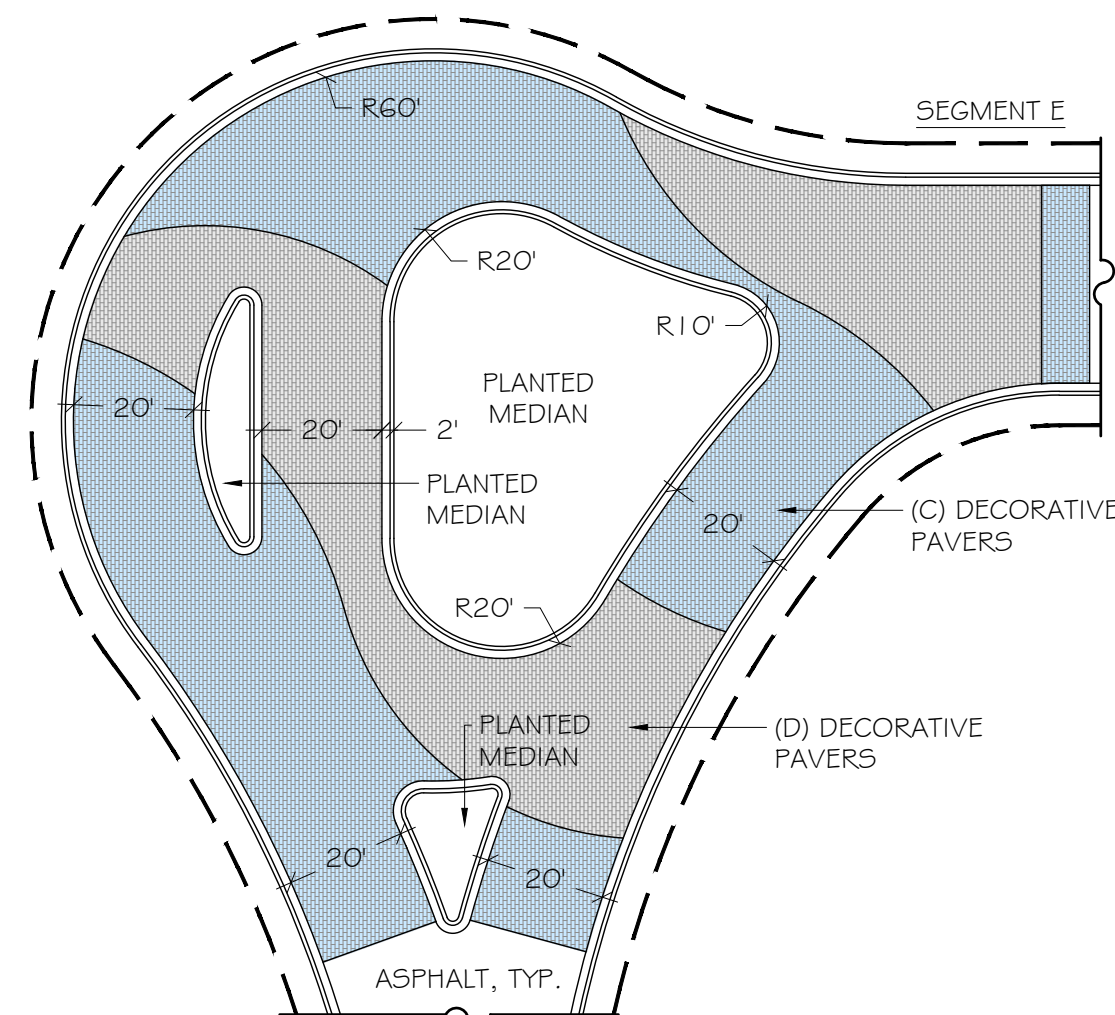
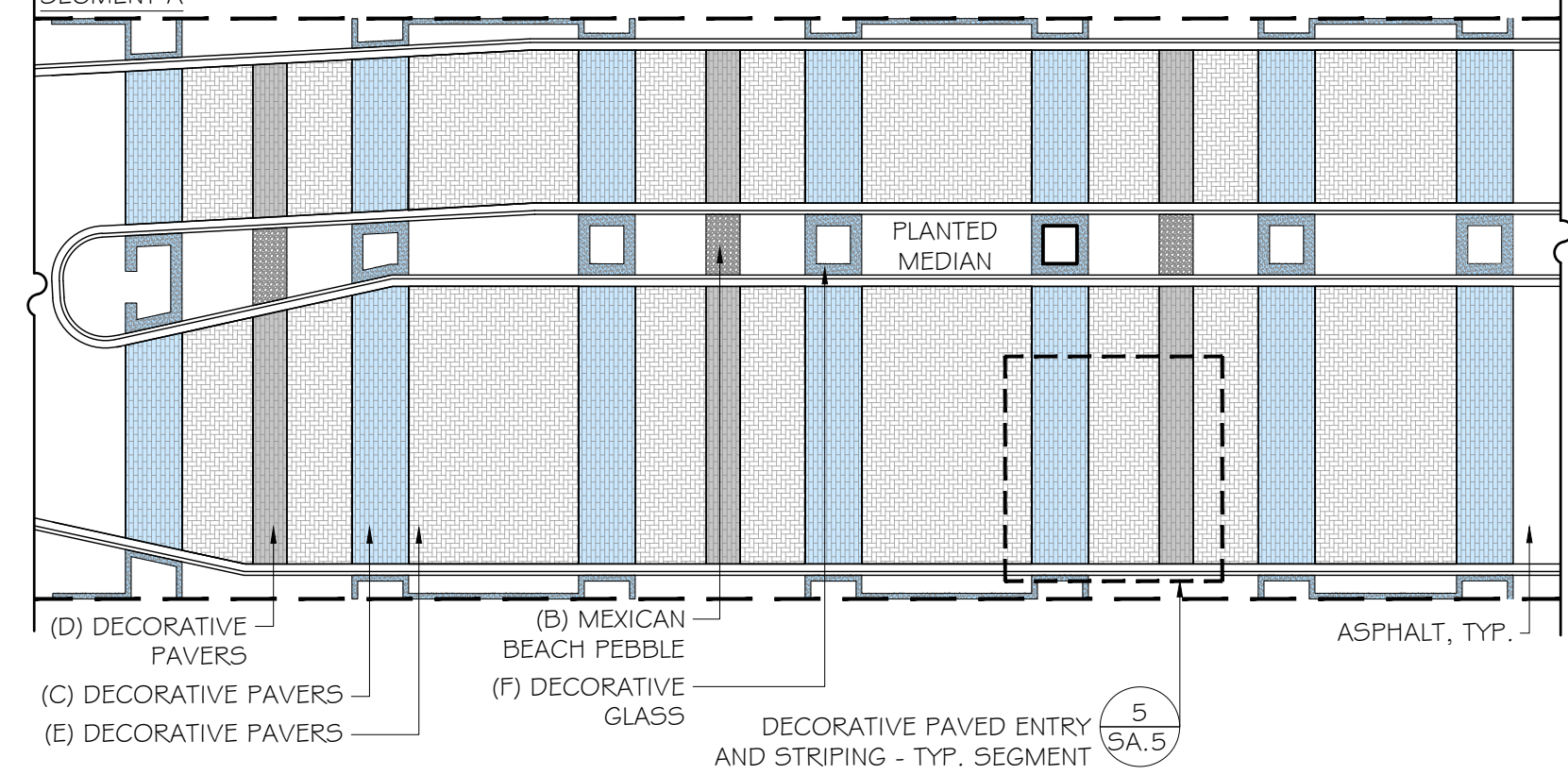
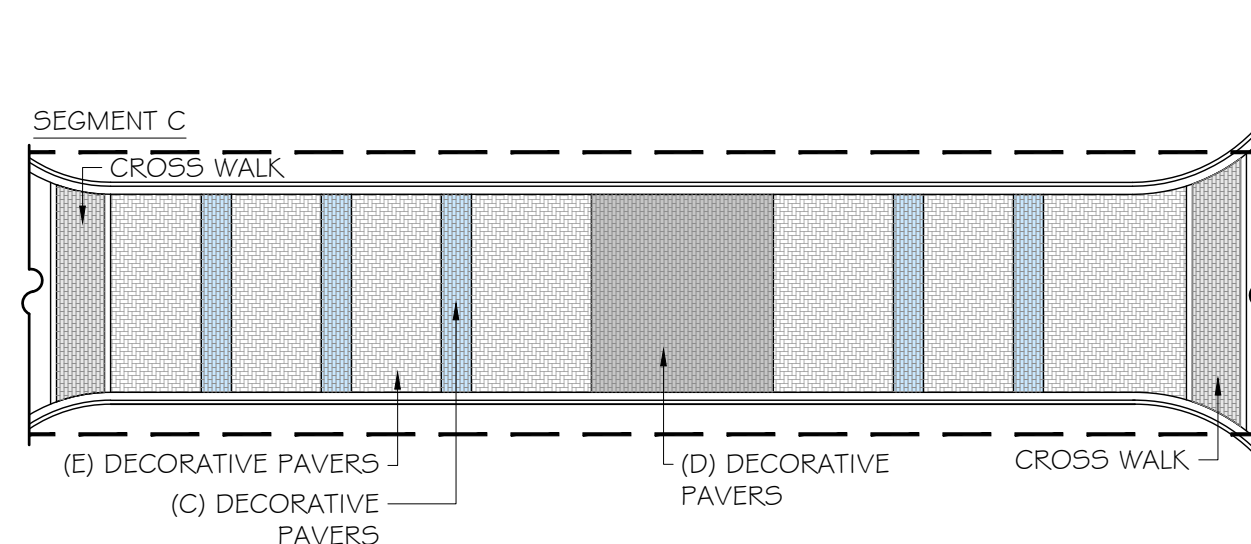

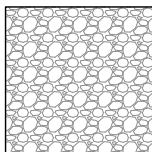
LOTIS WELLINGTON
Wellington, Florida

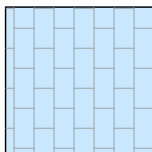
Drawn By: RG
Drawing #: 1076
Date: 01/31/2022

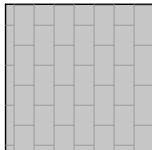
SITE AMENITIES
PLAN
(GREENWAY)

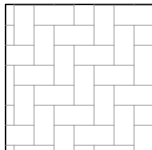
SHEET # SA.3

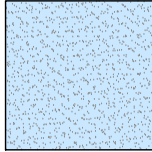

LEGEND	
PLAN SYMBOL	MATERIAL SPEC.
 <p>- (B) MEXICAN BEACH PEBBLE</p>	 <p>(B) MEXICAN BEACH PEBBLES PRODUCT: MEXICAN BEACH PEBBLE (OR SUBSTANTIALLY SIMILAR ALTERNATE) MANUFACTURER: EPIC STONEWORKS COLOR: LIGHT GRAY - SIZE: 2-3"</p>
 <p>- (C) DECORATIVE PAVERS</p>	 <p>(C) DECORATIVE PAVERS PRODUCT: V-SERIES PAVERS 4"x8" (OR SUBSTANTIALLY SIMILAR ALTERNATE) MANUFACTURER: WAUSAU COLOR: BLASTED GLASS BG-40 (BLUE)</p>
 <p>- (D) DECORATIVE PAVERS</p>	 <p>(D) DECORATIVE PAVERS PRODUCT: 4XB PAVERS (OR SUBSTANTIALLY SIMILAR ALTERNATE) MANUFACTURER: TREMON COLOR: GRANITE</p>
 <p>- (E) DECORATIVE PAVERS</p>	 <p>(E) DECORATIVE PAVERS PRODUCT: 4XB PAVERS (OR SUBSTANTIALLY SIMILAR ALTERNATE) MANUFACTURER: TREMON COLOR: GLACIER</p>
 <p>- ASPHALT</p>	
 <p>- (F) DECORATIVE GLASS</p>	 <p>(F) DECORATIVE GLASS PRODUCT: LANDSCAPE GLASS (OR SUBSTANTIALLY SIMILAR ALTERNATE) MANUFACTURER: AMERICAN SPECIALTY GLASS COLOR: CRYSTAL BLUE</p>

NOTES:
PAVERS TO BE INSTALLED BY ICPI CERTIFIED INSTALLER



DECORATIVE CONCRETE PAVER PATTERNS

NOTES: *DETAILS PROVIDED FOR MATERIAL SPECIFICATION, LOCATION AND GENERAL OVERALL DIMENSIONS. REFER TO ENGINEERING PLANS & MANUFACTURER INSTRUCTIONS FOR STRUCTURAL AND DIMENSIONAL REQUIREMENTS FOR CONSTRUCTION

SCALE: 1/32" = 1' - 0"

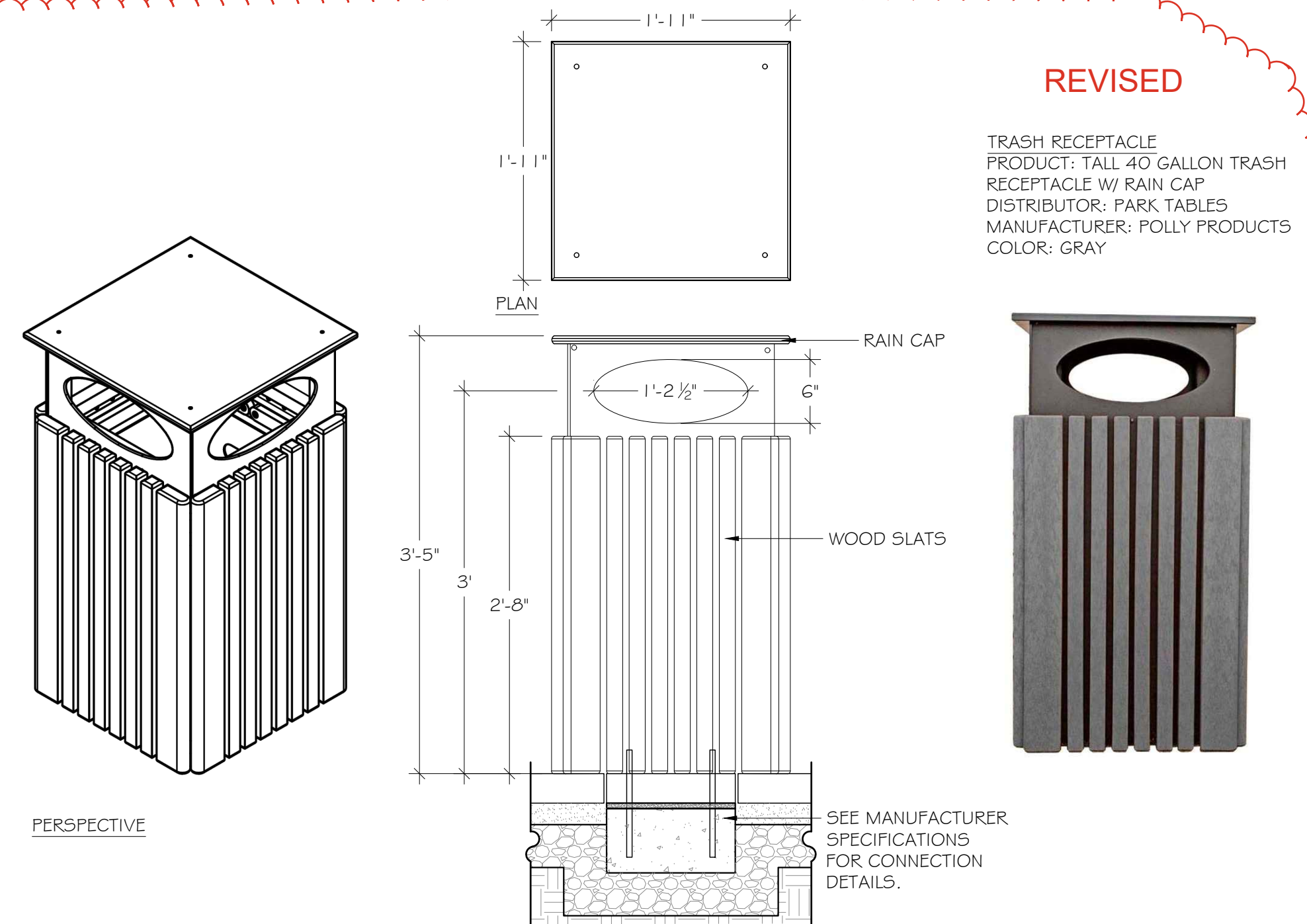
 TRASH RECEPTACLE

NOTES: *DETAILS PROVIDED FOR MATERIAL SPECIFICATION, LOCATION AND GENERAL OVERALL DIMENSIONS. REFER TO
ENGINEERING PLANS & MANUFACTURER INSTRUCTIONS FOR STRUCTURAL AND DIMENSIONAL REQUIREMENTS FOR CONSTRUCTION.

SCALE: 1" = 1' - 0"

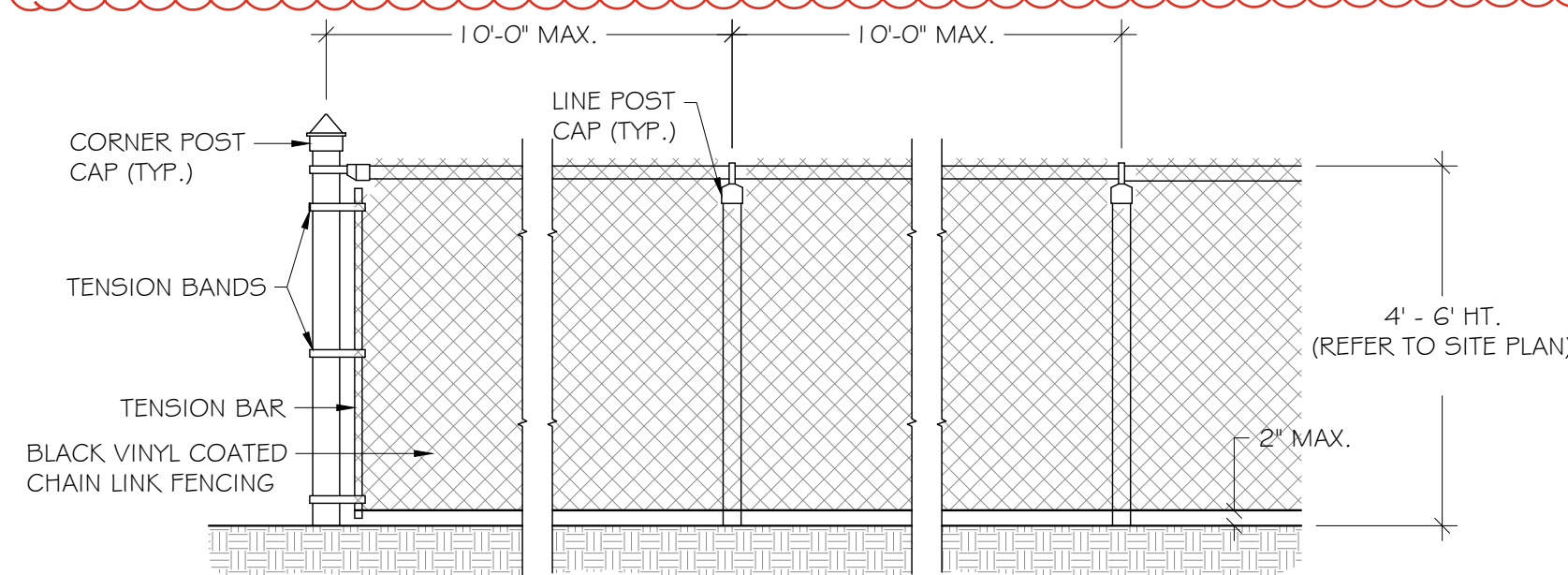

 CHAIN LINK FENCE

NOTES: *DETAILS PROVIDED FOR MATERIAL SPECIFICATION, LOCATION AND GENERAL OVERALL DIMENSIONS.
REFER TO ENGINEERING PLANS & MANUFACTURER INSTRUCTIONS FOR STRUCTURAL AND DIMENSIONAL
REQUIREMENTS FOR CONSTRUCTION.

SCALE: 1/2" = 1' - 0"

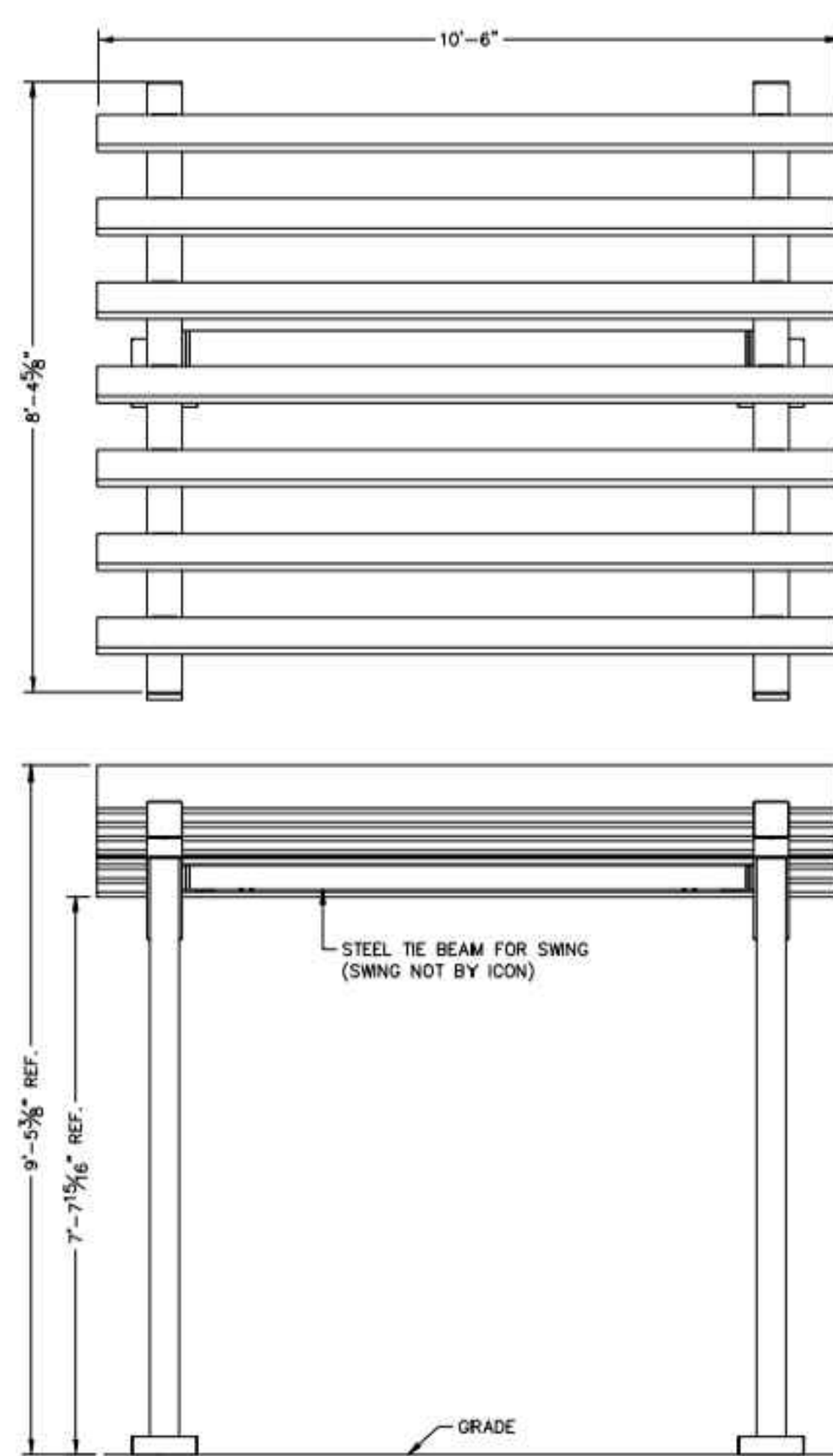

4. ICON SHELTERS SHADE STRUCTURE

DETAILS PROVIDED FOR MATERIAL SPECIFICATION, LOCATION AND GENERAL OVERALL DIMENSIONS. REFER TO ENGINEERING PLANS FOR STRUCTURAL AND DIMENSIONAL REQUIREMENTS FOR CONSTRUCTION

SCALE: 1/2" = 1'-0"

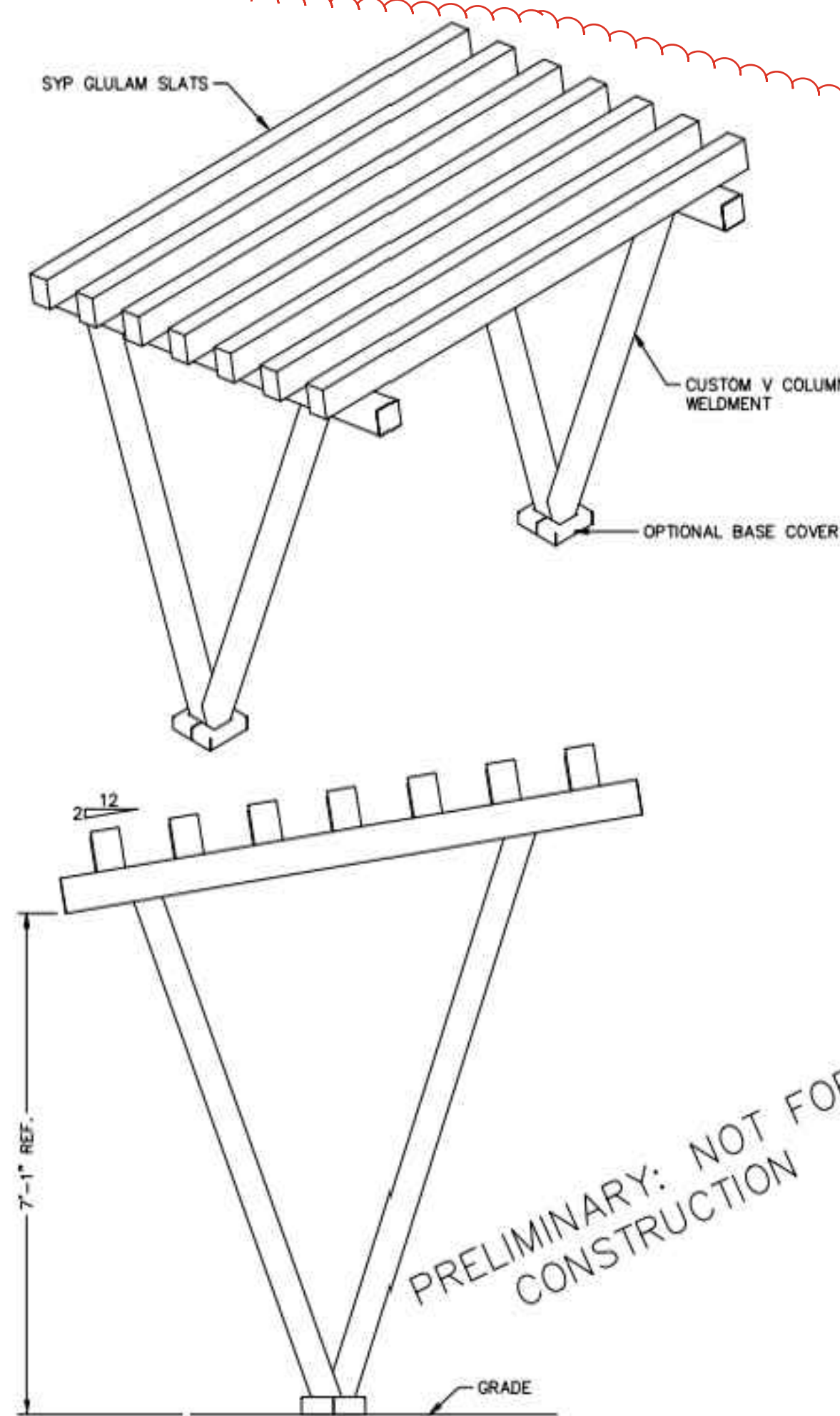

PRELIMINARY: NOT FOR CONSTRUCTION

Consultants:

Revisions:
07/17/2023 - RESUBMITTAL
10/02/2023 - REVISION

LOTIS WELLINGTON
Wellington, Florida

Drawn By:	RG
Drawing #:	1076
Date:	01/31/2022

SITE AMENITIES DETAILS

SHEET # SA.4

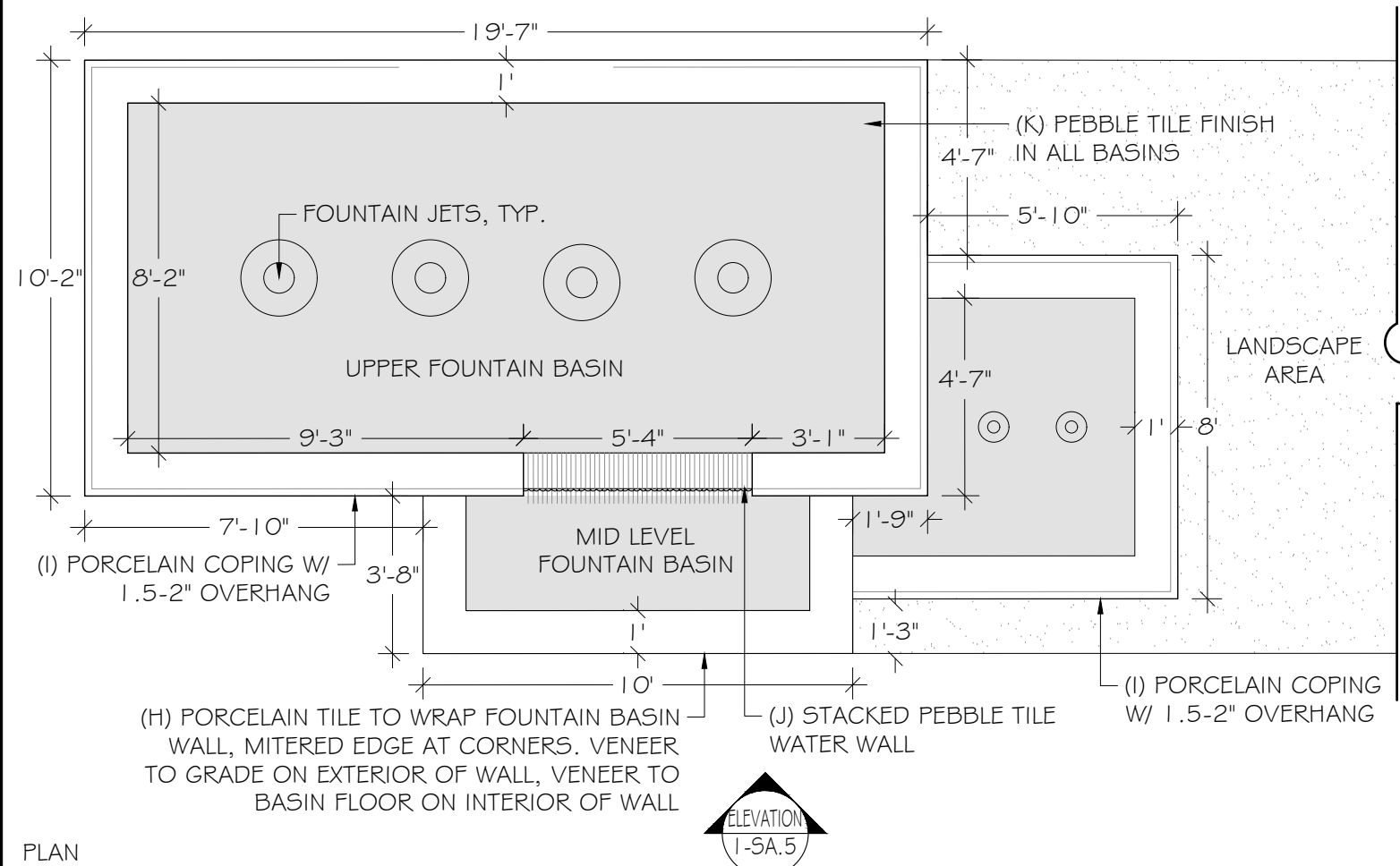

PLAN

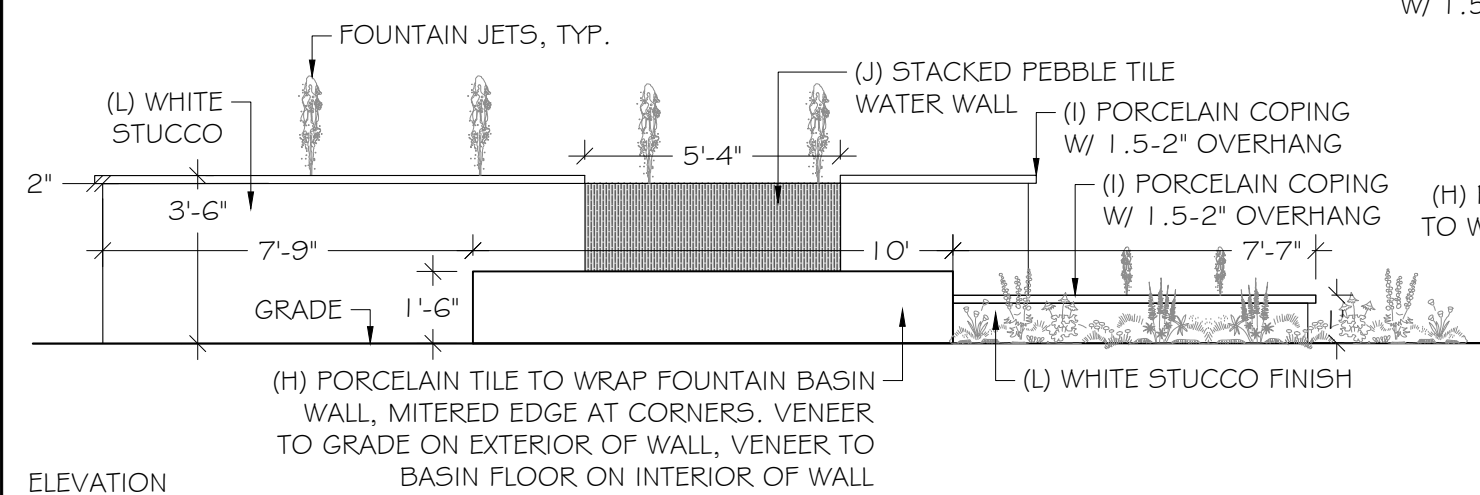

ELEVATION

1 FOUNTAIN
NOTES: *DETAILS PROVIDED FOR MATERIAL SPECIFICATION, LOCATION AND GENERAL OVERALL DIMENSIONS. REFER TO ENGINEERING PLANS FOR STRUCTURAL AND DIMENSIONAL REQUIREMENTS FOR CONSTRUCTION

SCALE: 1/4" = 1' - 0"

(H) PORCELAIN TILE
PRODUCT: FLORIM STONE (OR SUBSTANTIALLY SIMILAR, ALTERNATE)
MANUFACTURER: CERAMIC MATRIX
COLOR: MARBLE MARQUINIA

(I) PORCELAIN COPING
PRODUCT: FLORIM STONE (OR SUBSTANTIALLY SIMILAR, ALTERNATE)
MANUFACTURER: CERAMIC MATRIX
COLOR: MARBLE CALCATTA

(J) STACKED PEBBLE TILE
PRODUCT: STACKED PEBBLE (OR SUBSTANTIALLY SIMILAR, ALTERNATE)
MANUFACTURER: ISLAND STONE
COLOR: MEDAN CHARCOAL NATURAL

(K) PEBBLE TILE
PRODUCT: PERFECT PEBBLE (OR SUBSTANTIALLY SIMILAR, ALTERNATE)
MANUFACTURER: ISLAND STONE
COLOR: MEDAN CHARCOAL NATURAL

(L) WHITE STUCCO FINISH
MATERIAL: STUCCO (OR SUBSTANTIALLY SIMILAR, ALTERNATE)
COLOR: SW7757-REFLECTIVE WHITE (TO MATCH BUILDING STUCCO FINISH)



PERSPECTIVE

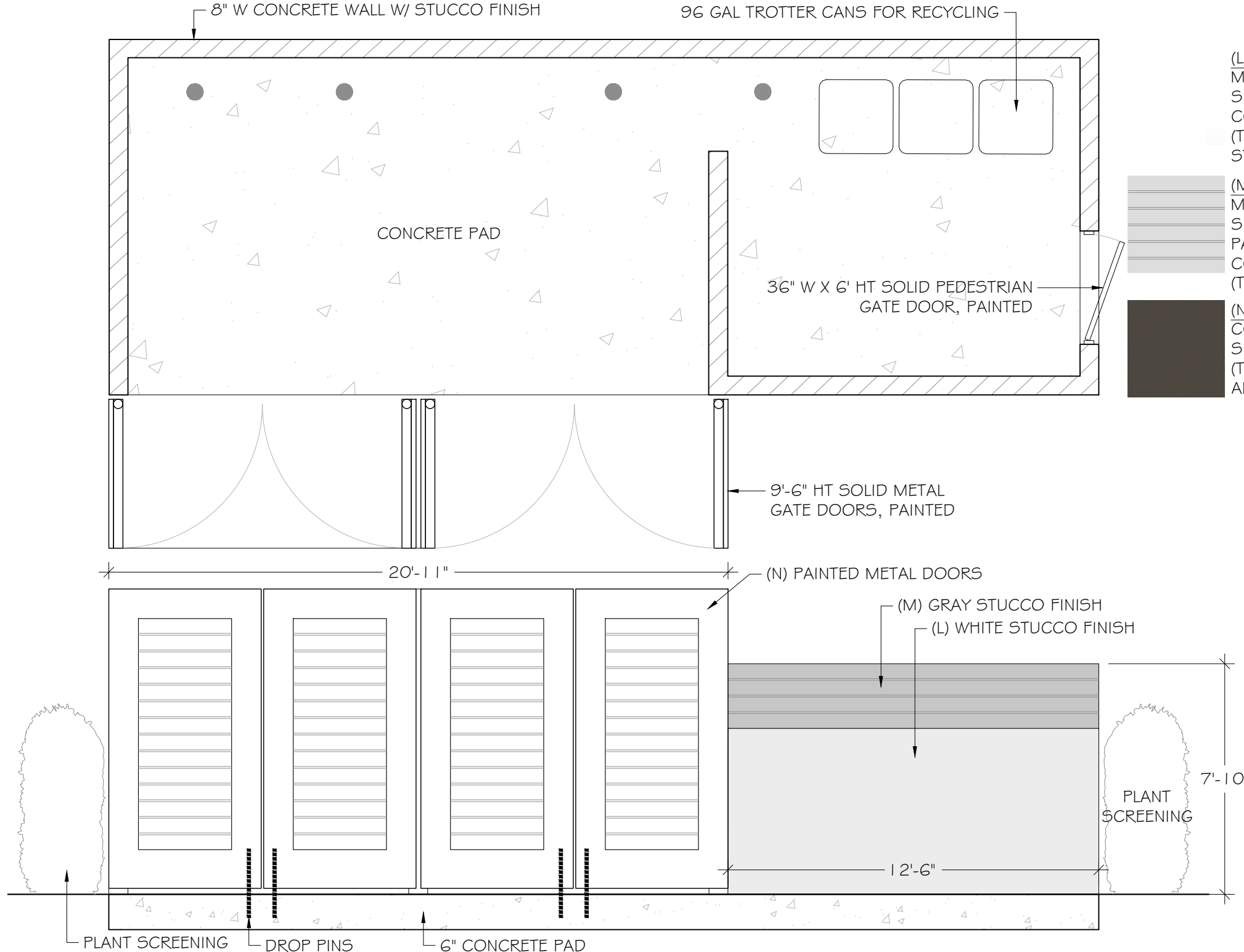

2 TRASH ENCLOSURE
NOTES: *DETAILS PROVIDED FOR MATERIAL SPECIFICATION, LOCATION AND GENERAL OVERALL DIMENSIONS. REFER TO ENGINEERING PLANS FOR STRUCTURAL AND DIMENSIONAL REQUIREMENTS FOR CONSTRUCTION

SCALE: 1/4" = 1' - 0"

(L) WHITE STUCCO FINISH
MATERIAL: STUCCO (OR SUBSTANTIALLY SIMILAR, ALTERNATE)
COLOR: SW7757-REFLECTIVE WHITE (TO MATCH BUILDING STUCCO FINISH)

(M) GRAY STUCCO FINISH
MATERIAL: STUCCO (OR SUBSTANTIALLY SIMILAR, ALTERNATE)
PATTERN: SIMULATED PANELS
COLOR: SW7016-MINDFUL GRAY (TO MATCH BUILDING STUCCO FINISH)

(N) PAINTED METAL DOORS
COLOR: SW7020-BLACK FOX (OR SUBSTANTIALLY SIMILAR, ALTERNATE) (TO MATCH BUILDING ALUMINUM FINISH)

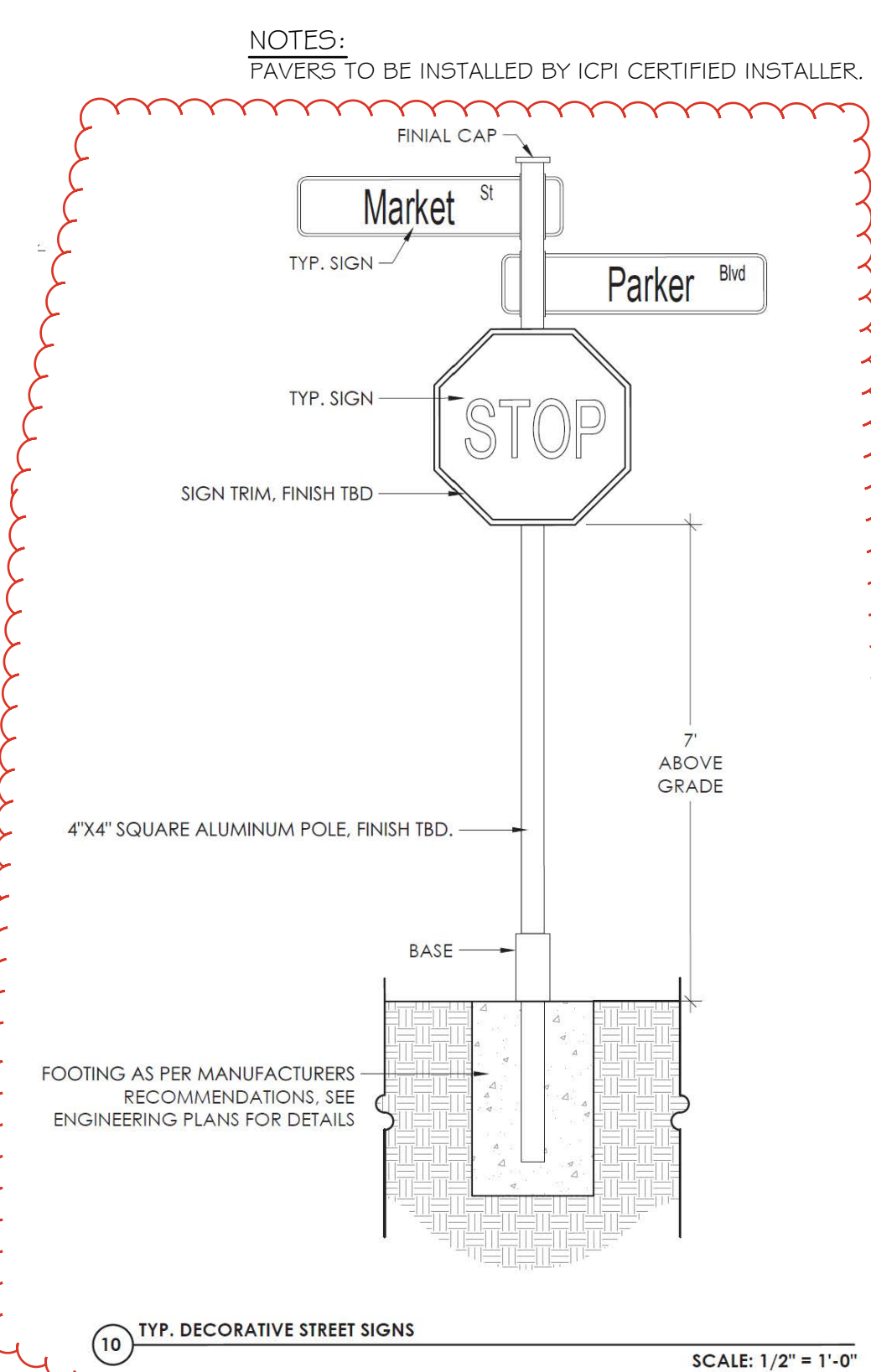

10 TYP. DECORATIVE STREET SIGNS

SCALE: 1/2" = 1' - 0"

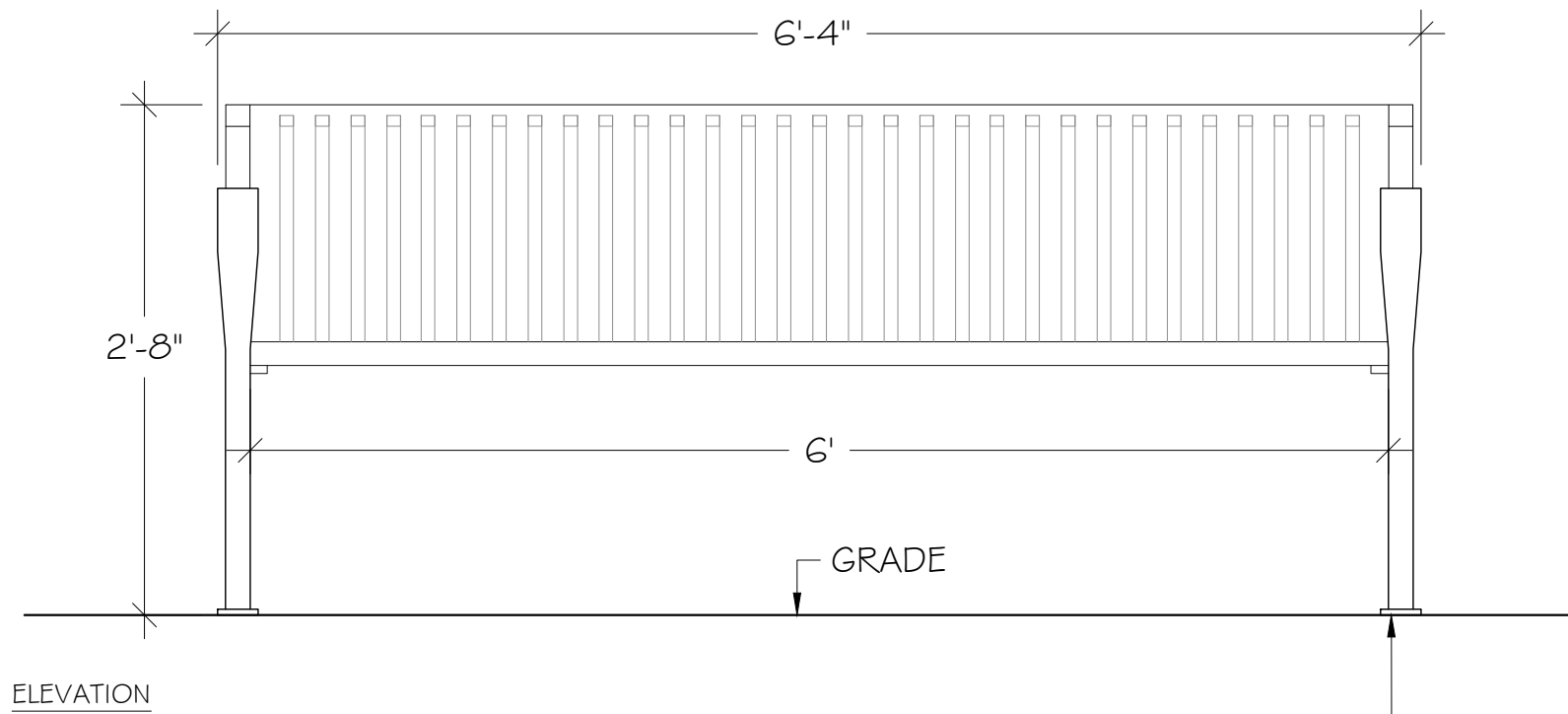

ELEVATION

SURFACE MOUNTED, SEE MANUFACTURER SPECIFICATIONS FOR CONNECTION DETAILS.

3 BENCH
NOTES: *DETAILS PROVIDED FOR MATERIAL SPECIFICATION, LOCATION AND GENERAL OVERALL DIMENSIONS. REFER TO ENGINEERING PLANS & MANUFACTURER INSTRUCTIONS FOR STRUCTURAL AND DIMENSIONAL REQUIREMENTS FOR CONSTRUCTION.

SCALE: 1" = 1' - 0"



Blue

REVISED
BENCH
PRODUCT: WILMINGTON BENCH
MANUFACTURER: PARK WAREHOUSE
COLOR: BLUE

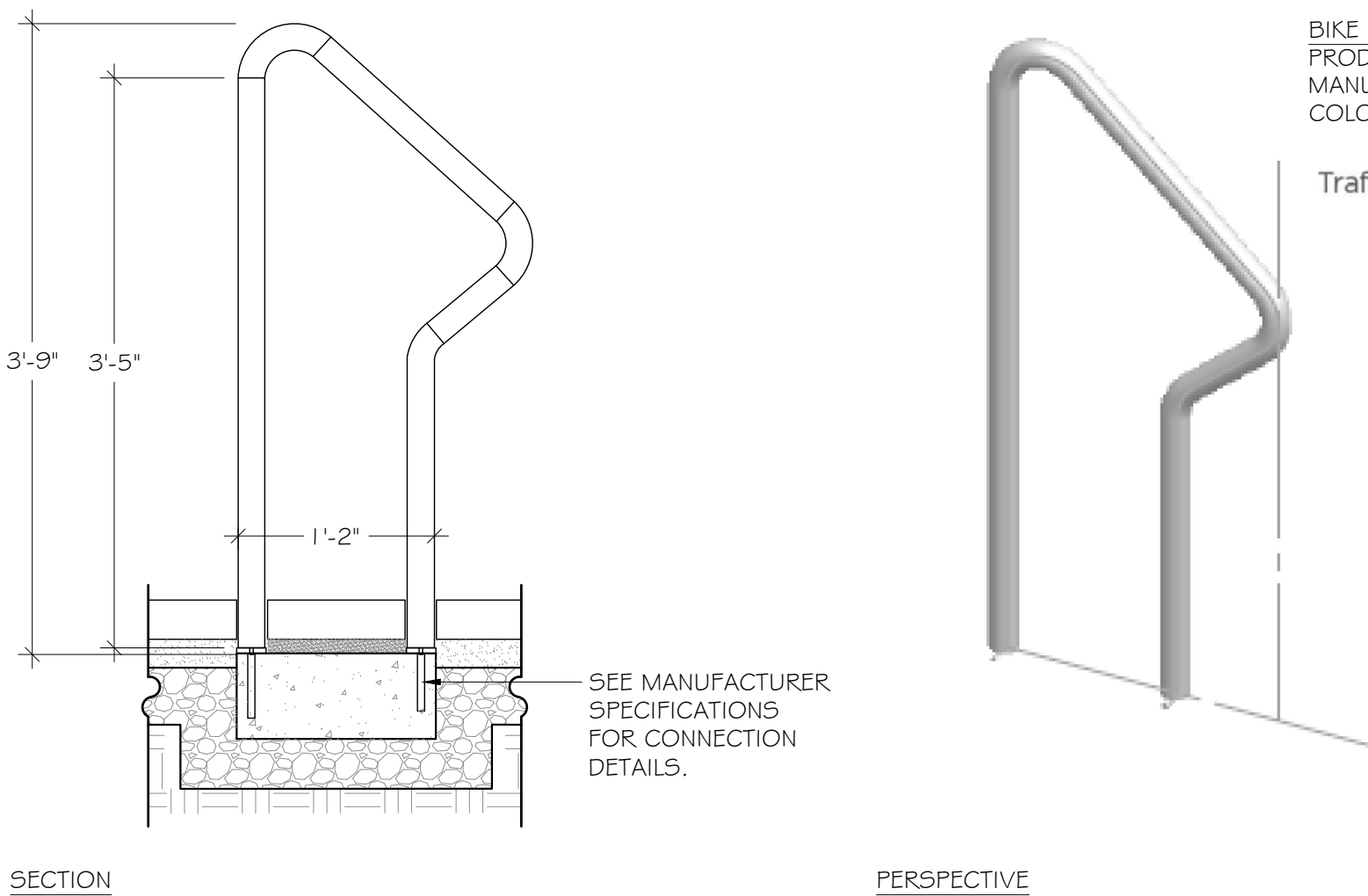

SECTION

PERSPECTIVE

4 IN-GROUND MOUNT BIKE RACK
NOTES: *DETAILS PROVIDED FOR MATERIAL SPECIFICATION, LOCATION AND GENERAL OVERALL DIMENSIONS. REFER TO ENGINEERING PLANS & MANUFACTURER INSTRUCTIONS FOR STRUCTURAL AND DIMENSIONAL REQUIREMENTS FOR CONSTRUCTION.

SCALE: 1" = 1' - 0"

REVISED
BIKE RACK
PRODUCT: DRIFT BIKE RACK
MANUFACTURER: PARK WAREHOUSE
COLOR: TRAFFIC BLACK

Traffic Black

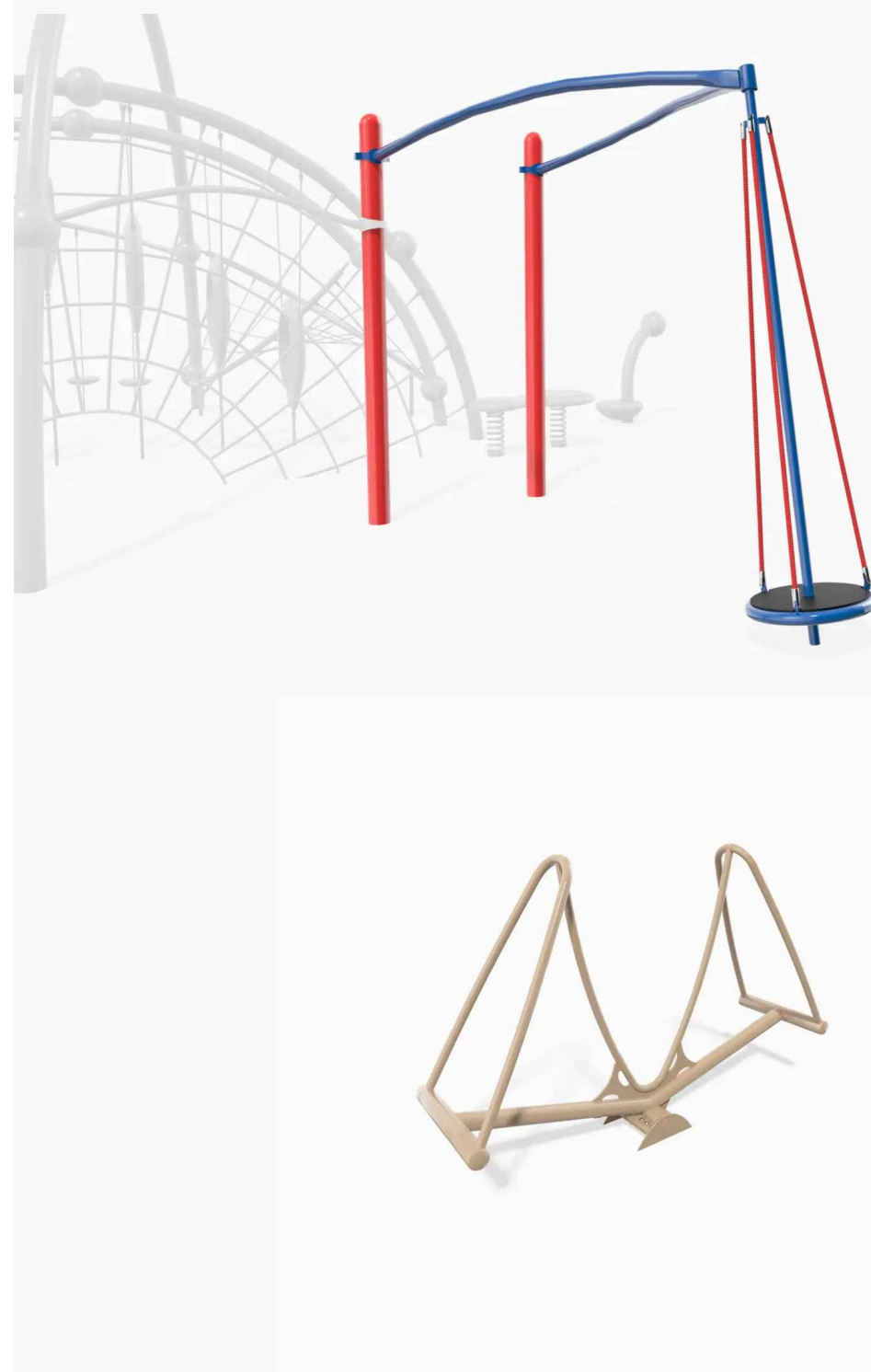

5 KINETIC PLAYGROUND EQUIPMENT
NOTES: *DETAILS PROVIDED FOR MATERIAL SPECIFICATION, LOCATION AND GENERAL OVERALL DIMENSIONS. REFER TO ENGINEERING PLANS & MANUFACTURER INSTRUCTIONS FOR STRUCTURAL AND DIMENSIONAL REQUIREMENTS FOR CONSTRUCTION.

SCALE: N.T.S.

ADDED
PLAY EQUIPMENT
PRODUCT: MOBIUS CLIMBER 3-PANEL
MANUFACTURER: LANDSCAPE STRUCTURES
MODEL #: 150635

ADDED
PLAY EQUIPMENT
PRODUCT: SOL SPINNER
MANUFACTURER: LANDSCAPE STRUCTURES
MODEL #: 202824

ADDED
PLAY EQUIPMENT
PRODUCT: STAND-UP SEESAW
MANUFACTURER: LANDSCAPE STRUCTURES
MODEL #: 148638

Consultants:

Revisions:
07/17/2023 - RESUBMITTAL
10/02/2023 - REVISION

LOTIS WELLINGTON
Wellington, Florida

Drawn By: RG
Drawing #: 1076
Date: 01/31/2022

SITE AMENITIES
DETAILS

SHEET # SA.5

BOW WOW KIT (6 pieces)



CANINE CONDO



PET WASTE STATION

DOG PARK EQUIPMENT
PRODUCT: THE BOW WOW KIT
MANUFACTURER: HERCULES INCORPORATED
COLOR: BLUE

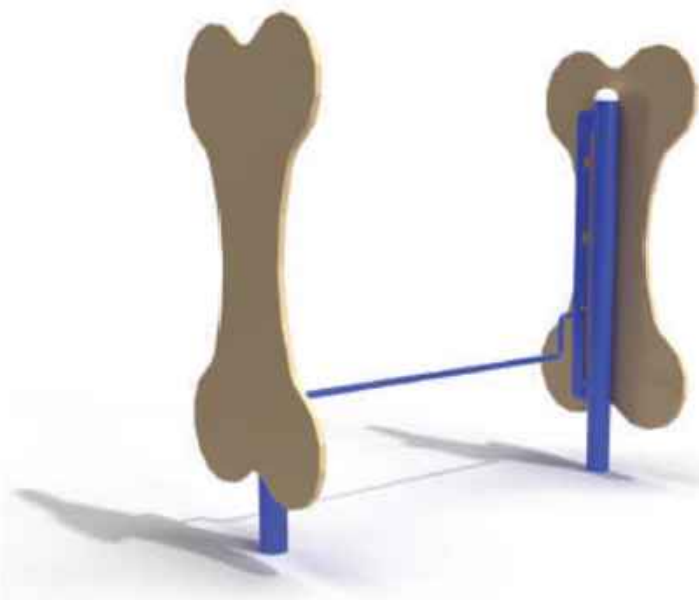

ADJUSTABLE JUMP



TUNNEL RUN



TUG AROUND



PET DRINKING FOUNTAIN



SEAT PLANK
FRAME

DOG WASH STATION

MAIN BODY: 50" W x 58" H x 27" D
MATERIAL: 16 gauge 304 stainless steel
FEATURES:
- Removable Adjustable Overhead Arm
- Stainless Steel Backsplash
- Tub Faucet and Sprayer kit
- Temporary drain kit w/ flexible hose
- Stainless Steel Shampoo Rack
- Two-piece, removable floor grate
FINISH: Stainless Steel

32 GAL. TRASH RECEPTACLE



6' PARK BENCH W/ BACK

OVERALL DIMENSION: 72" Length, 18" Seat Height (after install), 30.5" Overall Height, 10" Seat Width
SEAT MATERIAL: Expanded Metal
SEAT COATING: Premium Polyethylene Coating
FRAME MOUNT: Inground Mount
FRAME COATING: Highly Durable Architectural Grade electrostatic applied Powder Coat
HARDWARE: All hardware is Xylan coated black hardware for extra protection and strength

ADDED

DOG PARK EQUIPMENT
PRODUCT: DOG WASH STATION
MANUFACTURER: HERCULES INCORPORATED
SIZE: 50" W. X 58" HT. X 27" D.

ADDED

DOG PARK EQUIPMENT
PRODUCT: DOG FOUNTAIN, SINGLE SPOUT
MANUFACTURER: HERCULES INCORPORATED
SIZE: 22.5" L X 13" W. X 32" HT.
COLOR: BLUE

DOG PARK EQUIPMENT
PRODUCT: 32 GAL TRASH RECEPTACLE
MANUFACTURER: HERCULES INCORPORATED
COLOR: BLUE

ADDED

DOG PARK EQUIPMENT
PRODUCT: 6 FT. BENCH
MANUFACTURER: HERCULES INCORPORATED
COLOR: BLUE

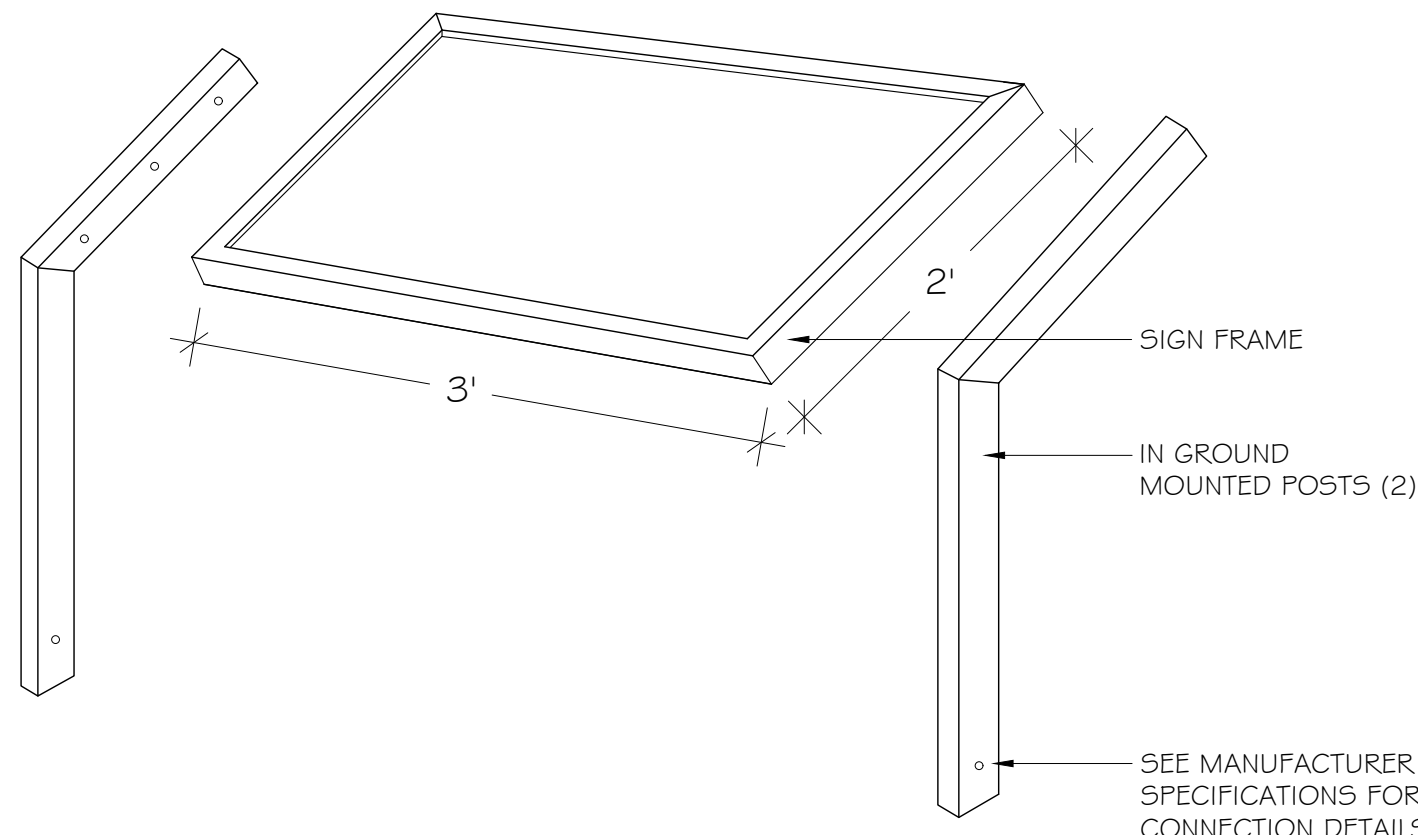
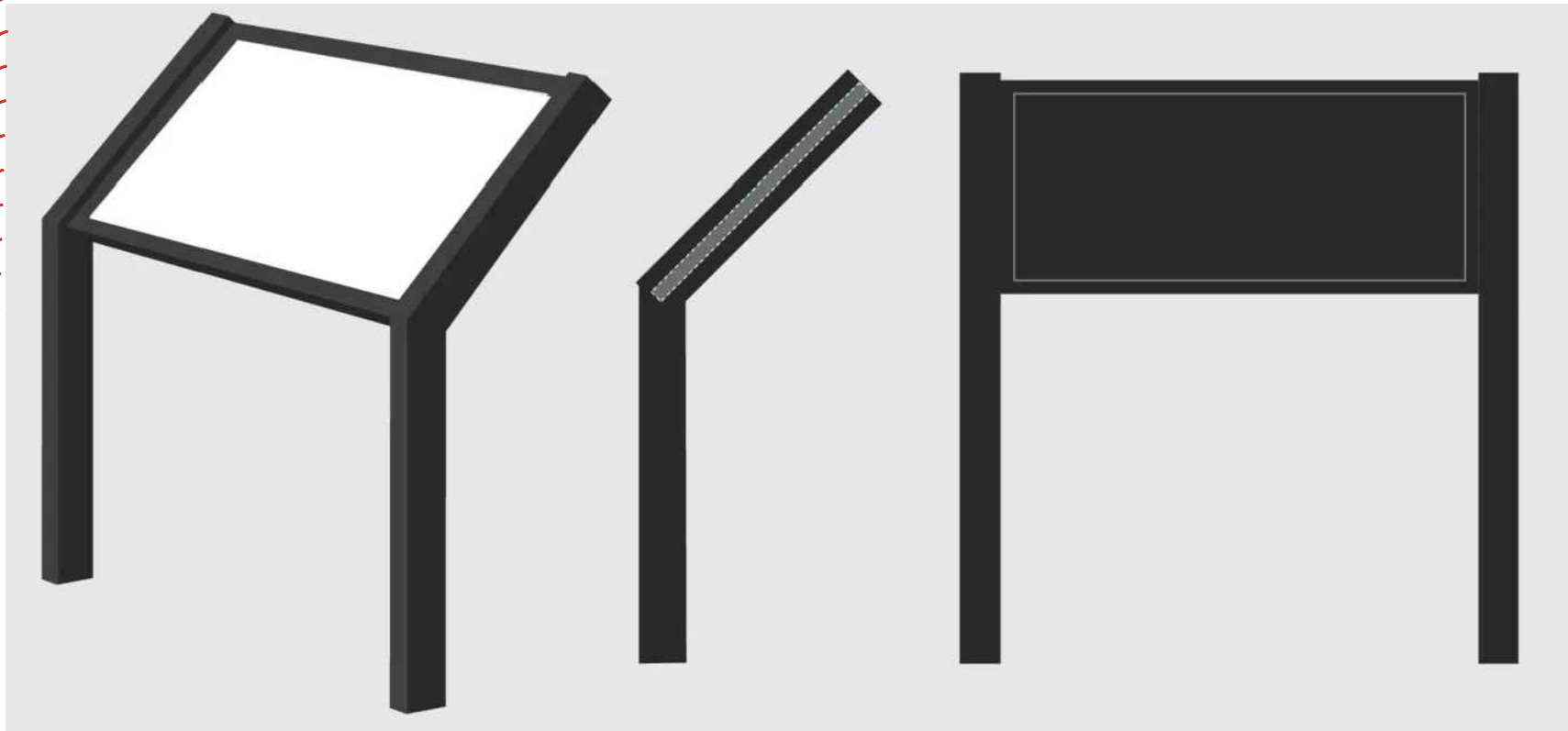

2 VIEWING SIGNS

DETAILS PROVIDED FOR MATERIAL SPECIFICATION, LOCATION AND GENERAL OVERALL DIMENSIONS. REFER TO ENGINEERING PLANS FOR STRUCTURAL AND DIMENSIONAL REQUIREMENTS FOR CONSTRUCTION

SCALE: 1" = 1'-0"



CANTILEVER SIGN
PRODUCT: NP5 CANTILEVER STYLE EXHIBIT
MANUFACTURER: VACKER SIGN
COLOR: BLACK
SIZE: 24" X 36"

ADDED

1 DECORATIVE PEDESTRIAN PAVERS

NOTES: *DETAILS PROVIDED FOR MATERIAL SPECIFICATION, LOCATION AND GENERAL OVERALL DIMENSIONS. REFER TO ENGINEERING PLANS + MANUFACTURER INSTRUCTIONS FOR STRUCTURAL AND DIMENSIONAL REQUIREMENTS FOR CONSTRUCTION.

SCALE: N.T.S.

Consultants:

Revisions:

07/17/2023 - RESUBMITTAL
10/02/2023 - REVISION

LOTIS WELLINGTON
Wellington, Florida

Drawn By: RG
Drawing #: 1076
Date: 01/31/2022

SITE AMENITIES
DETAILS

SHEET # SA.6

NOTES:
PAVERS TO BE INSTALLED BY ICPI CERTIFIED INSTALLER.

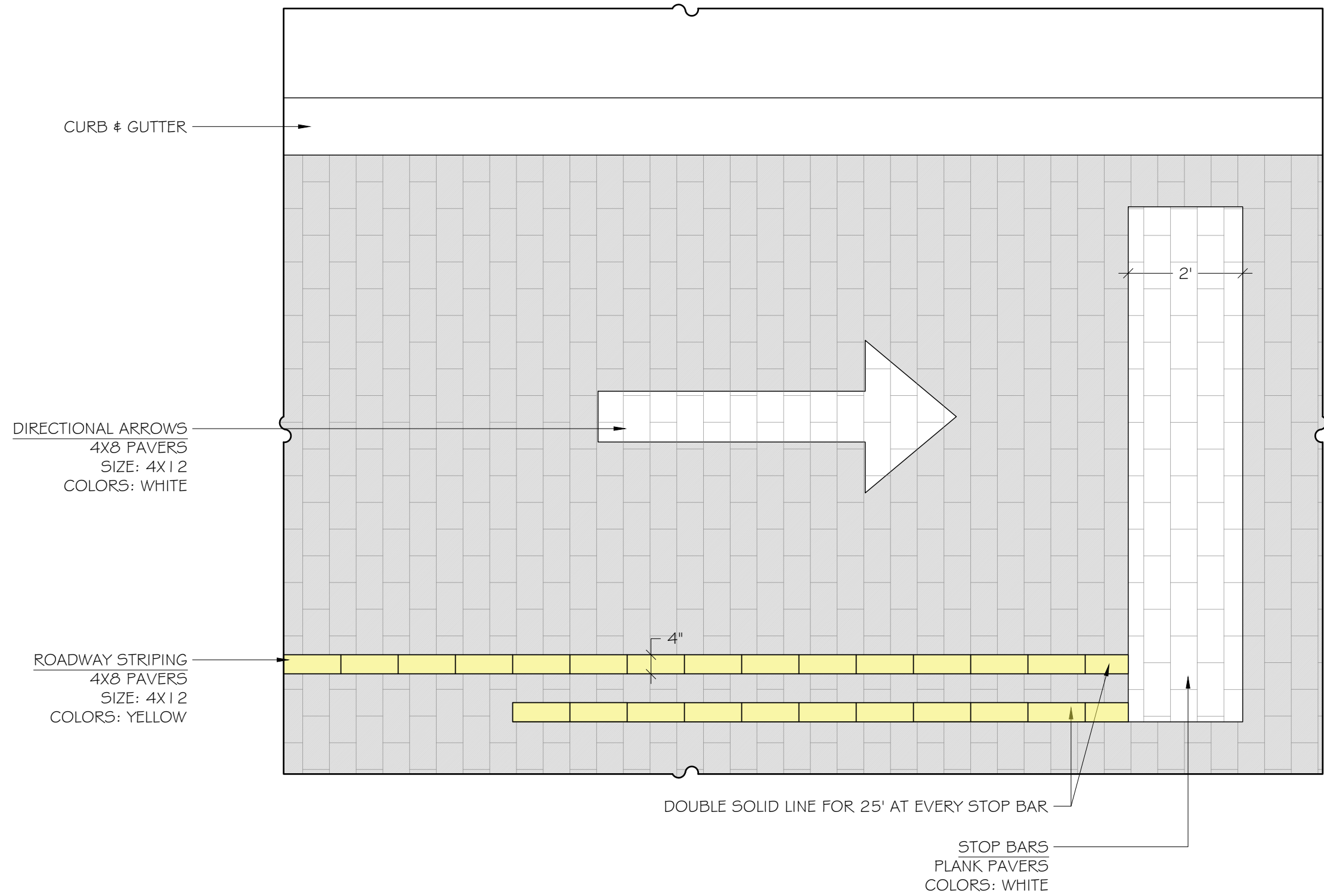

1 DECORATIVE PAVERS (VEHICULAR CONDITION) - PATTERN DETAIL
NOTES: *DETAILS PROVIDED FOR MATERIAL SPECIFICATION, LOCATION AND GENERAL OVERALL DIMENSIONS. REFER TO ENGINEERING PLANS FOR STRUCTURAL AND DIMENSIONAL REQUIREMENTS FOR CONSTRUCTION.
SCALE: 1/2" = 1' - 0"

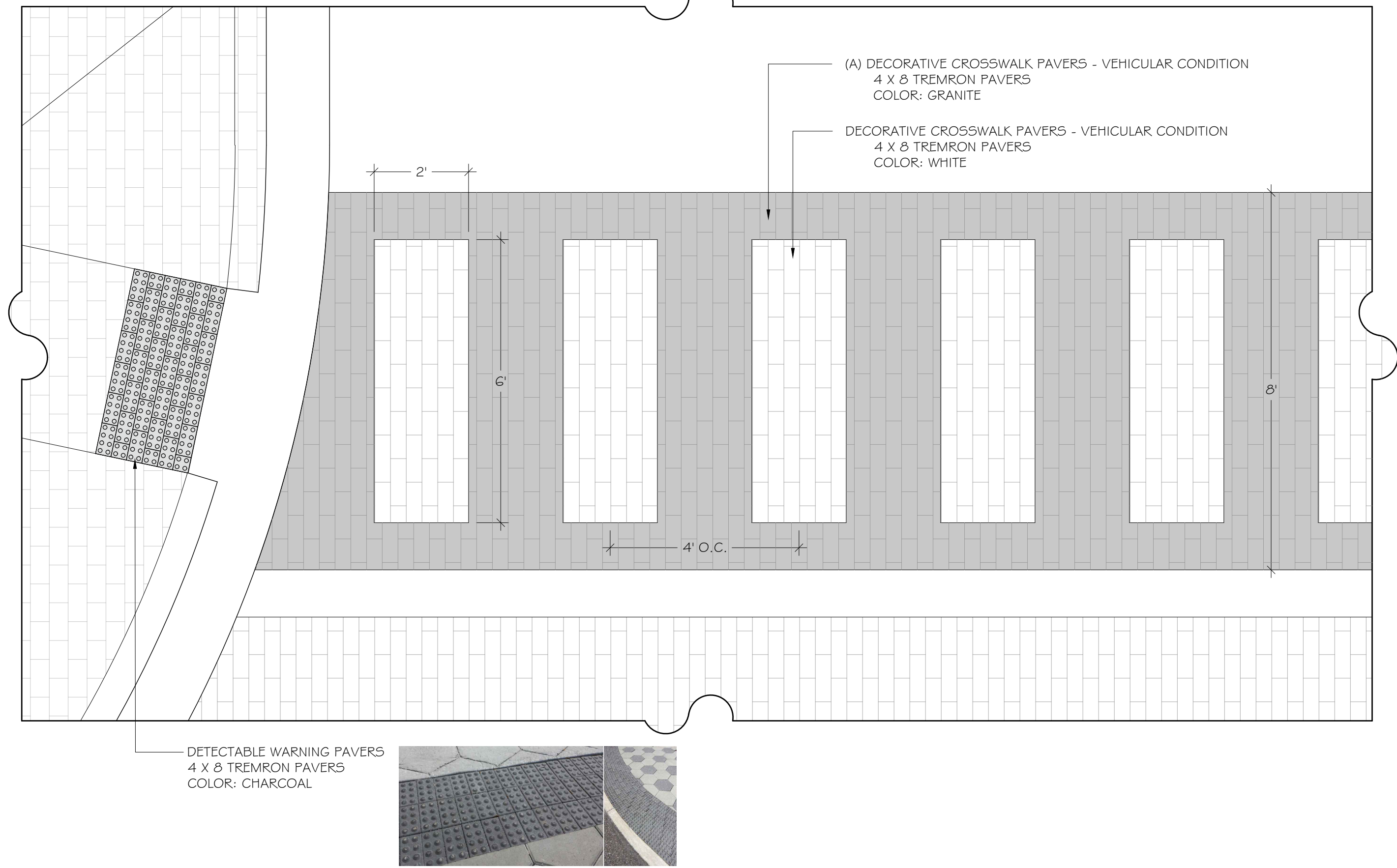

3 PEDESTRIAN CROSSWALK
NOTES: *DETAILS PROVIDED FOR MATERIAL SPECIFICATION, LOCATION AND GENERAL OVERALL DIMENSIONS. REFER TO ENGINEERING PLANS & MANUFACTURER INSTRUCTIONS FOR STRUCTURAL AND DIMENSIONAL REQUIREMENTS FOR CONSTRUCTION.
SCALE: 1/2" = 1' - 0"

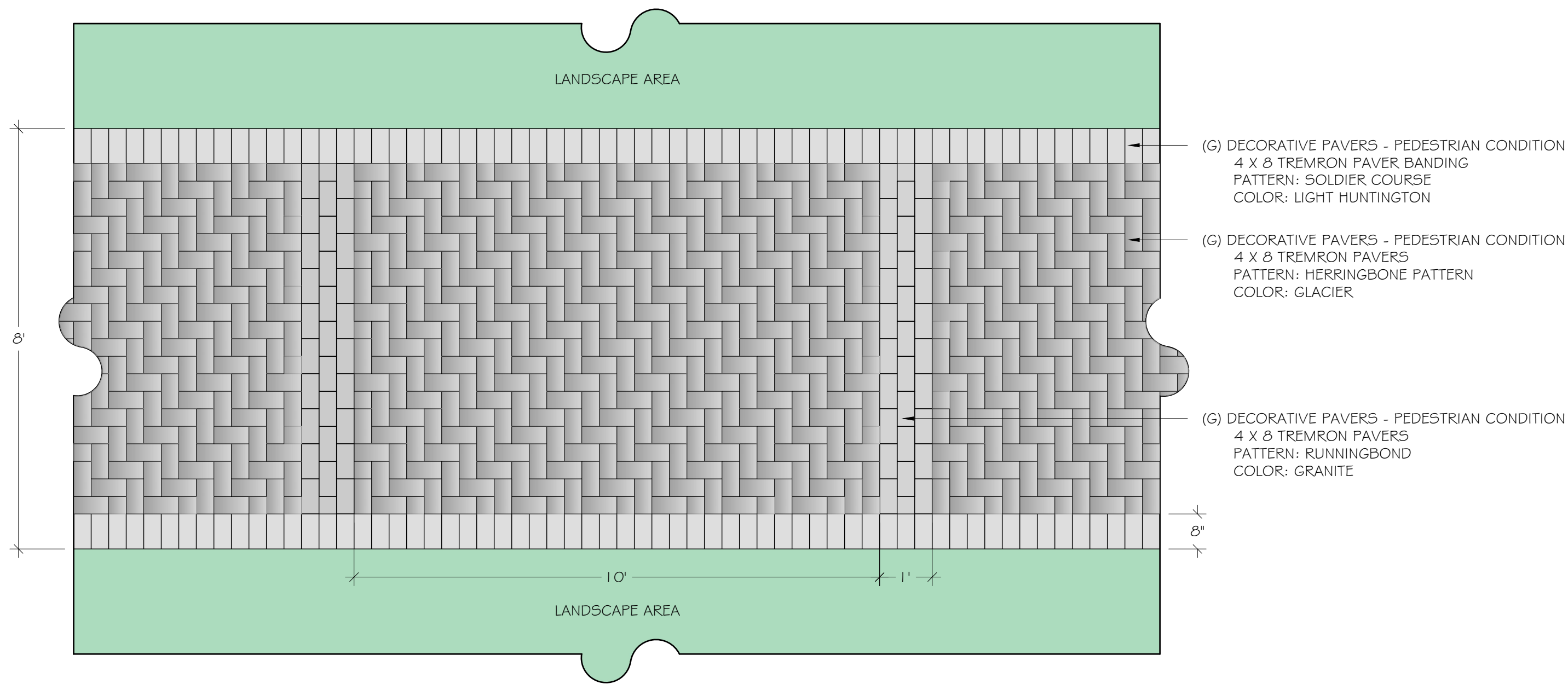

2 SIDEWALK
NOTES: *DETAILS PROVIDED FOR MATERIAL SPECIFICATION, LOCATION AND GENERAL OVERALL DIMENSIONS. REFER TO ENGINEERING PLANS & MANUFACTURER INSTRUCTIONS FOR STRUCTURAL AND DIMENSIONAL REQUIREMENTS FOR CONSTRUCTION.
SCALE: 1/2" = 1' - 0"

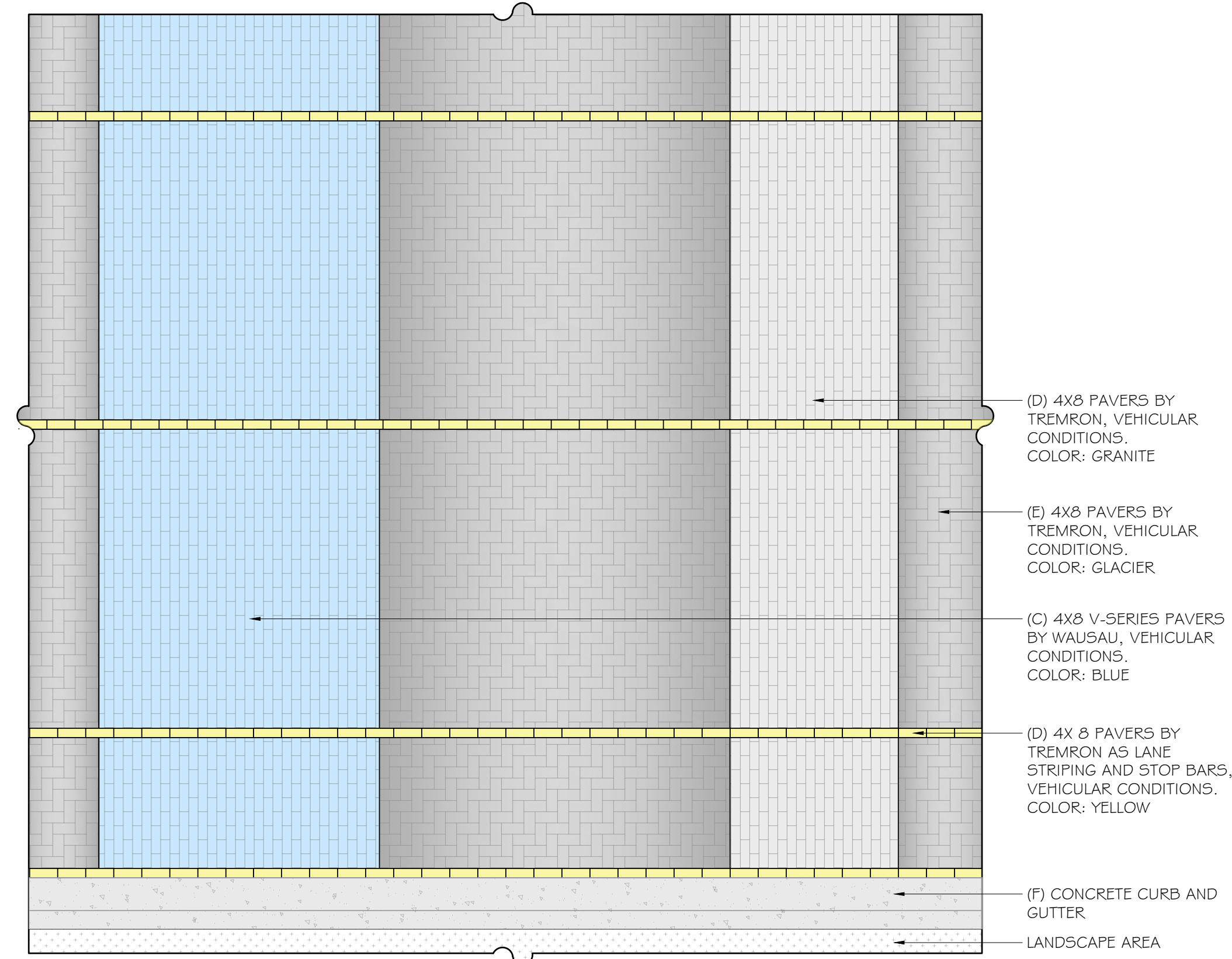

4 DECORATIVE PAVED ENTRY AND STRIPING - TYP. SEGMENT
NOTES: *DETAILS PROVIDED FOR MATERIAL SPECIFICATION, LOCATION AND GENERAL OVERALL DIMENSIONS. REFER TO ENGINEERING PLANS FOR STRUCTURAL AND DIMENSIONAL REQUIREMENTS FOR CONSTRUCTION.
SCALE: 1/4" = 1' - 0"

NOTES:
PAVERS TO BE INSTALLED BY ICPI CERTIFIED INSTALLER.

Consultants:

Revisions:
07/17/2023 - RESUBMITTAL
10/02/2023 - REVISION

LOTIS WELLINGTON
Wellington, Florida

Drawn By: RG
Drawing #: 1076
Date: 01/31/2022

SITE AMENITIES
DETAILS

SHEET # SA.7