

WARBY PARKER

Exhibit C - Proposed Signs

SHOPPES AT ISLE VERDE
 900 S. STATE RD 7
 WELLINGTON, FL 33414



93 Industry Drive
 PO Box 349
 Versailles, KY 40383
 859.879.1199



WARBY PARKER

STORE: 348

SHOPPES AT ISLE VERDE
 900 S. STATE RD 7
 WELLINGTON, FL 33414

This sign is intended to be installed in accordance with the requirements of Article 600 of the National Electrical Code and/or other applicable local codes. This includes proper grounding and bonding of the sign.

RUGGLES SIGN DOES NOT PROVIDE PRIMARY ELECTRICAL TO SIGN LOCATION!



Submittal Date: 09/23/24
 Acct Rep: Rick Branham
 Designer: Fred Burch V

REVISIONS

r1: <u>09/26/24</u>	r7: _____
r2: <u>09/30/24</u>	r8: _____
r3: <u>10/01/24</u>	r9: _____
r4: <u>10/10/24</u>	r10: _____
r5: _____	r11: _____
r6: _____	r12: _____

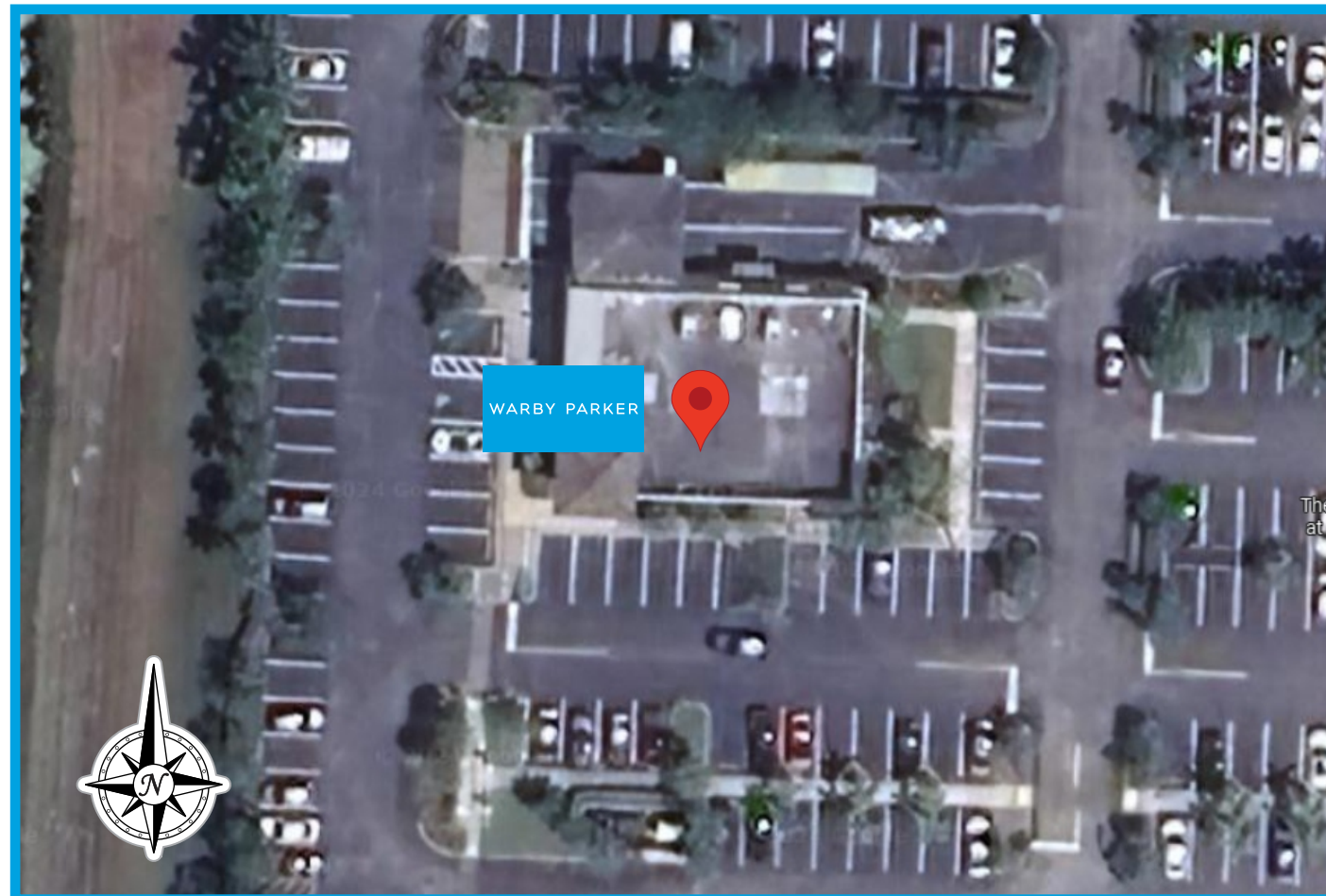
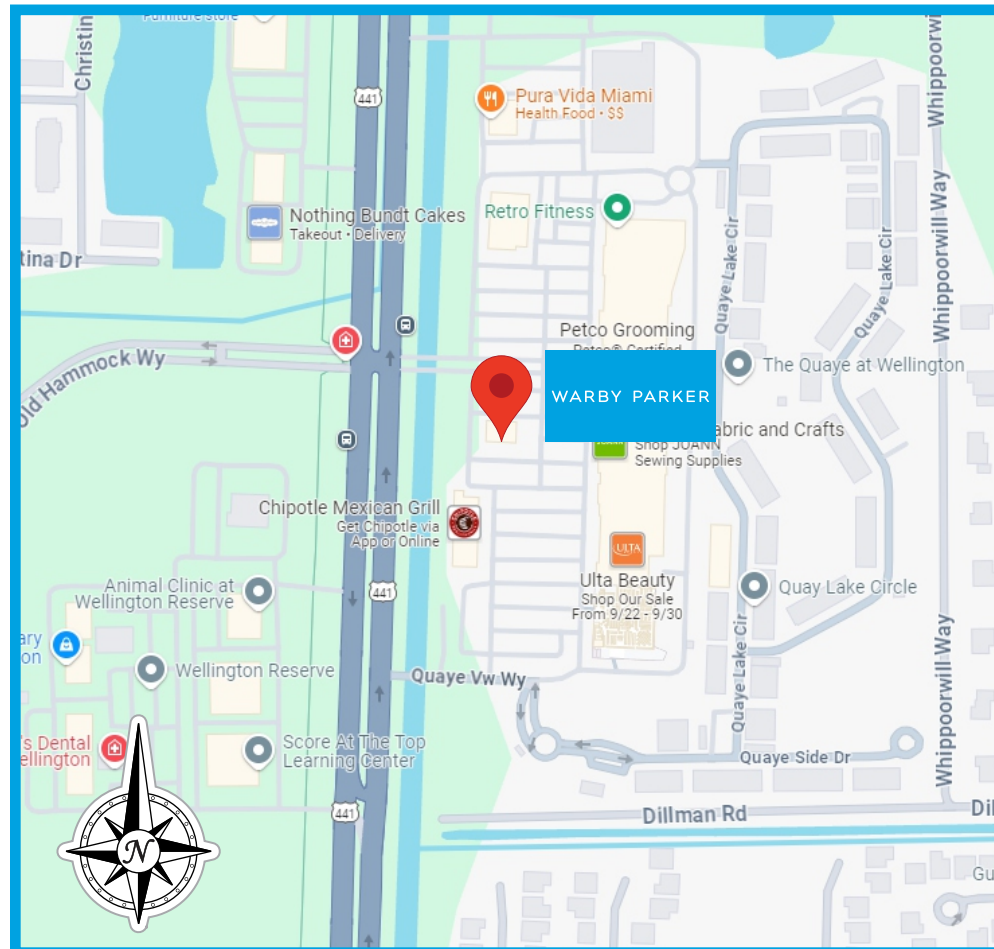

STORE PLAN

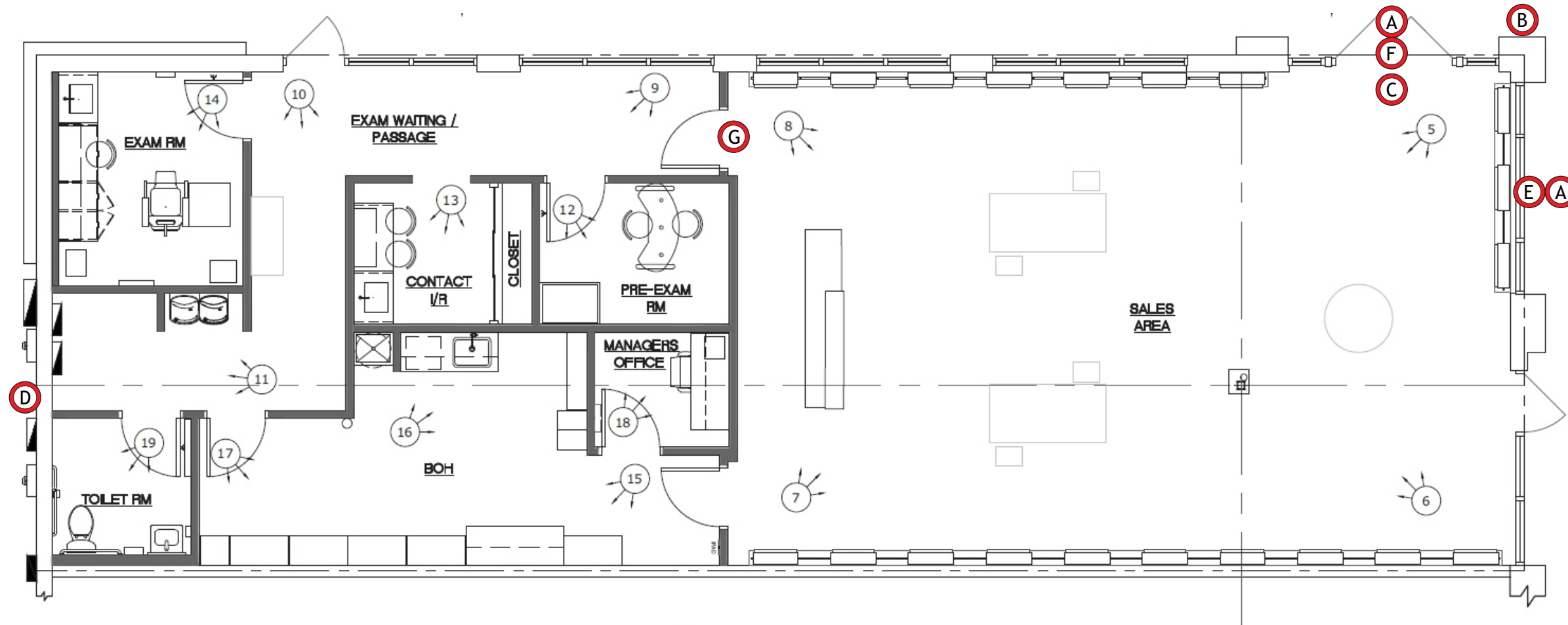

93 Industry Drive
 PO Box 349
 Versailles, KY 40383
 859.879.1199



WARBY PARKER

STORE: 348
 SHOPPES AT ISLE VERDE
 900 S. STATE RD 7
 WELLINGTON, FL 33414

This sign is intended to be installed in accordance with the requirements of Article 600 of the National Electrical Code and/or other applicable local codes. This includes proper grounding and bonding of the sign.

RUGGLES SIGN DOES NOT PROVIDE PRIMARY ELECTRICAL TO SIGN LOCATION!



Submittal Date: 09/23/24
 Acct Rep: Rick Branham
 Designer: Fred Burch V

REVISIONS

r1: <u>09/26/24</u>	r7: _____
r2: <u>09/30/24</u>	r8: _____
r3: <u>10/01/24</u>	r9: _____
r4: <u>10/10/24</u>	r10: _____
r5: _____	r11: _____
r6: _____	r12: _____

- A** WP13RPT 2L Qty - 2
- B** WP 2L BLD24 illum Qty - 1
- C** WP ee6.25 domed PL35 susp Qty - 1
- D** WP11FCO Qty - 1
- E** WP PL125.25 Qty - 1
- F** WP PL124.25 Qty - 1

STOREFRONT - WEST ELEVATION

Scale: 1/4" = 1' - 0"

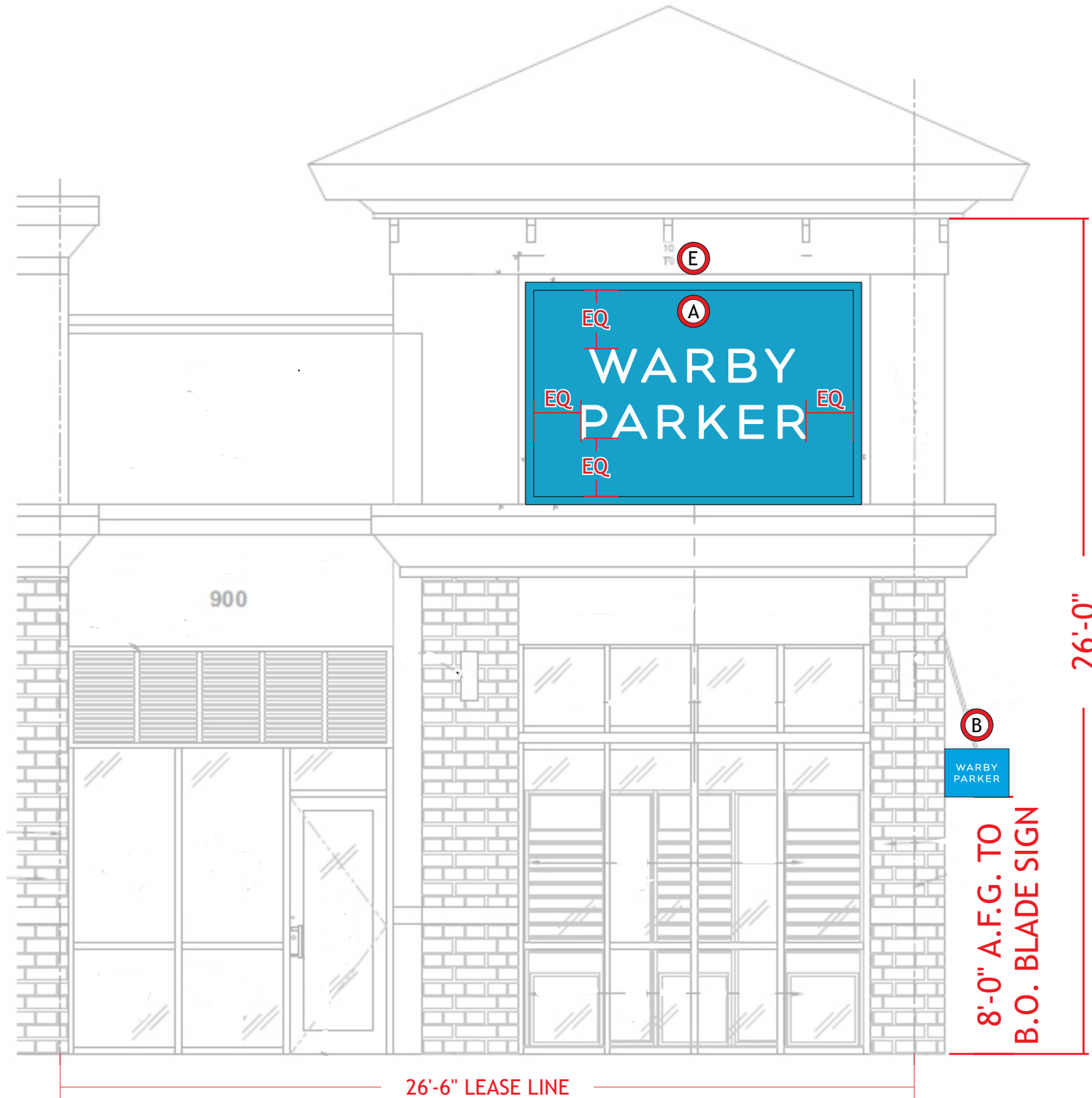

A WP13RPT 2L
Qty - 2

B WP 2L BLD24 illum
Qty - 1

C WP ee6.25 domed PL35 susp
Qty - 1

D WP11FCO
Qty - 1

E WP PL125.25
Qty - 1

F WP PL124.25
Qty - 1



Ruggles
SIGN

93 Industry Drive
PO Box 349
Versailles, KY 40383
859.879.1199



WARBY PARKER

STORE: 348

SHOPPES AT ISLE VERDE
900 S. STATE RD 7
WELLINGTON, FL 33414

This sign is intended to be installed in accordance with the requirements of Article 600 of the National Electrical Code and/or other applicable local codes. This includes proper grounding and bonding of the sign.

RUGGLES SIGN DOES NOT PROVIDE PRIMARY ELECTRICAL TO SIGN LOCATION!



Submittal Date: 09/23/24

Acct Rep: Rick Branham

Designer: Fred Burch V

REVISIONS

r1: 09/26/24	r7: _____
r2: 09/30/24	r8: _____
r3: 10/01/24	r9: _____
r4: 10/10/24	r10: _____
r5: _____	r11: _____
r6: _____	r12: _____

STOREFRONT - SOUTH ELEVATION

Scale: 1/4" = 1' - 0"



A WP13RPT 2L
Qty - 2

B WP 2L BLD24 illum
Qty - 1

C WP ee6.25 domed PL35 susp
Qty - 1

D WP11FCO
Qty - 1

E WP PL125.25
Qty - 1

F WP PL124.25
Qty - 1

A FACE-LIT CHANNEL LETTERS - ELEVATION QTY: 2
Scale: 3/4" = 1' - 0"

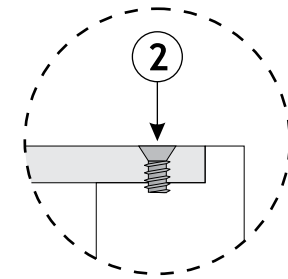

FACE-LIT CHANNEL LETTERS - SECTION
Scale: 3" = 1' - 0"

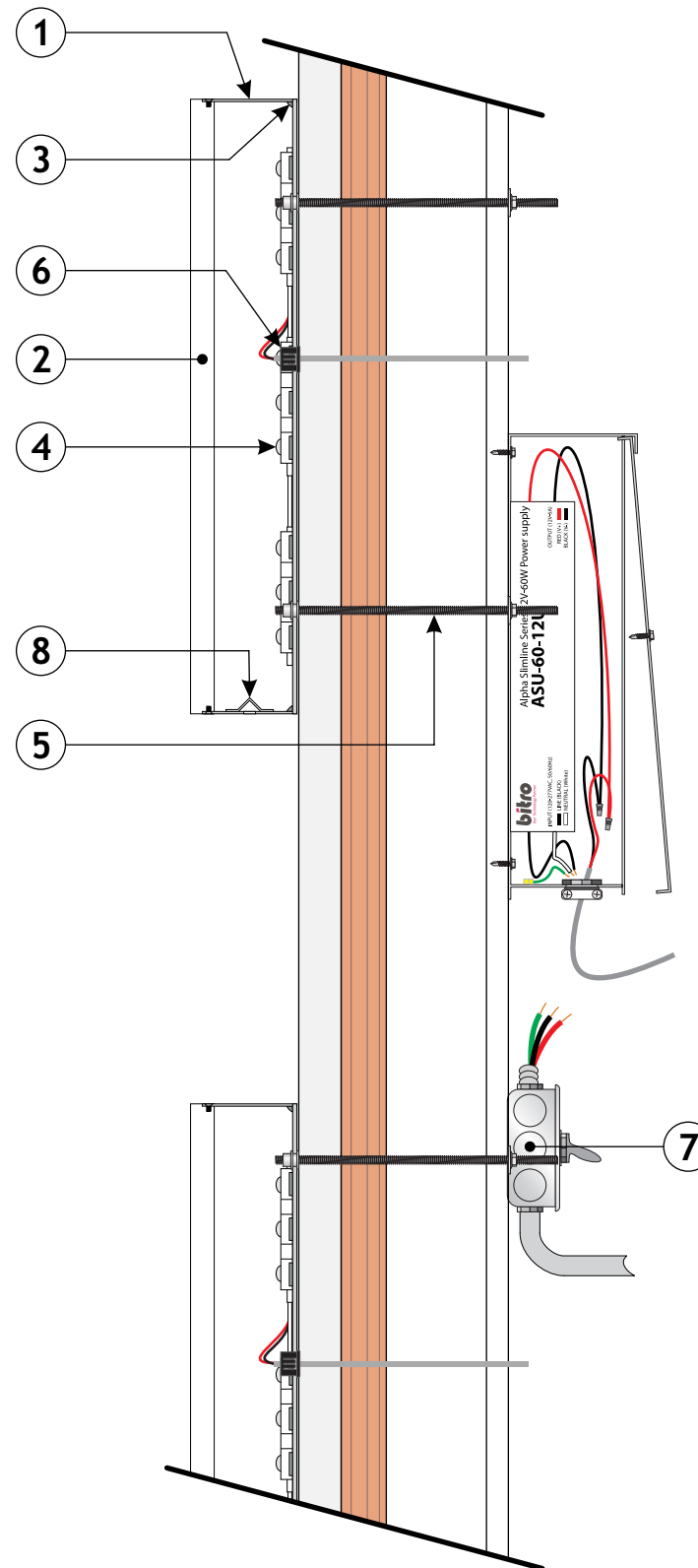

SIGN - DETAILS

- 1 2 1/2" ALUMINUM RETURNS PAINTED SATIN WHITE, ALL INTERIOR SURFACES PAINTED LIGHT REFLECTIVE GLOSS WHITE.
- 2 3/8" THICK 2447 WHITE SATIN ICE LIGHT DIFFUSING ACRYLIC LETTER FACES SECURED WITH 2-56 X 5/16" COUNTERSINK SCREW.
- 3 RETURNS AND BACK ARE FULLY CAULKED TO ELIMINATE ALL LIGHT LEAKS.
- 4 BITRO OPTICSPRO LITE 5000K WHITE LED UNITS TO ILLUMINATE LETTERS.
- 5 LETTERS MOUNT FLUSH TO STOREFRONT SURFACE WITH SITE SPECIFIC FASTENERS. EXAMPLE SHOWN IS 10-24 RIVET NUT, WITH 3/16" ALL THREAD ROD AND 10-24 WIZ NUT FASTENERS BEHIND WALL.
- 6 SNAP BUSHING FOR LOW VOLTAGE PASS-THRU TO BITRO ASU-60-12U (120-277 VOLT) POWER SUPPLY CONTAINED INSIDE PAIGE 980054C SNAP 2 ENCLOSURE.
- 7 DEDICATED PRIMARY SIGN CIRCUIT AND DISCONNECT PROVIDED BY ELECTRICIAN.
- 8 DRAIN HOLE IN BOTTOM OF LETTER RETURN WITH LIGHT COVER.



93 Industry Drive
PO Box 349
Versailles, KY 40383
859.879.1199



WARBY PARKER

STORE: 348

SHOPPES AT ISLE VERDE
900 S. STATE RD 7
WELLINGTON, FL 33414

This sign is intended to be installed in accordance with the requirements of Article 600 of the National Electrical Code and/or other applicable local codes. This includes proper grounding and bonding of the sign.

RUGGLES SIGN DOES NOT PROVIDE PRIMARY ELECTRICAL TO SIGN LOCATION!



Submittal Date: 09/23/24
Acct Rep: Rick Branham
Designer: Fred Burch V

REVISIONS

r1: 09/26/24	r7: _____
r2: 09/30/24	r8: _____
r3: 10/01/24	r9: _____
r4: 10/10/24	r10: _____
r5: _____	r11: _____
r6: _____	r12: _____

B ILLUMINATED BLADE SIGN ENVELOPE STYLE - ELEVATION
Scale: 1 1/2" = 1' - 0"

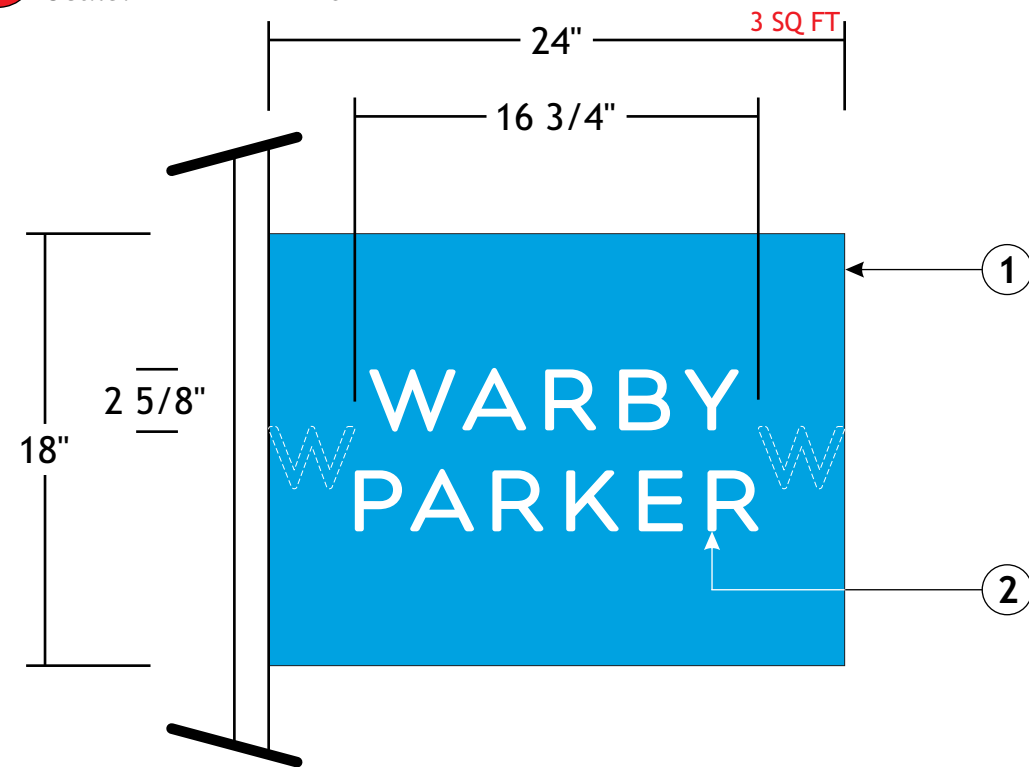

SIGN - SECTION

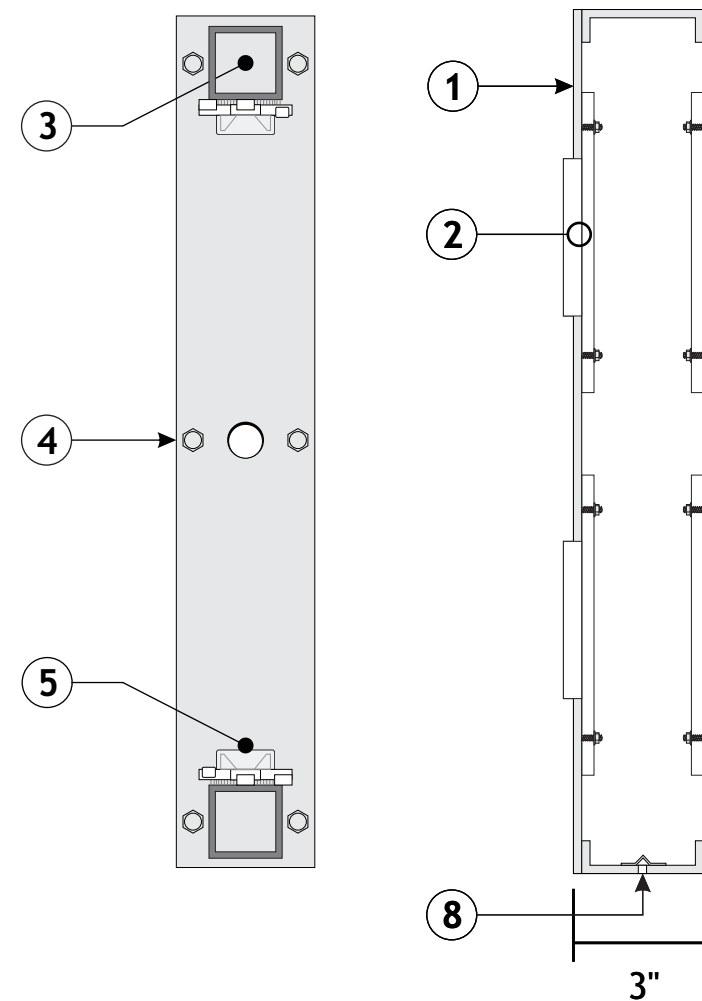

SIGN - DETAILS

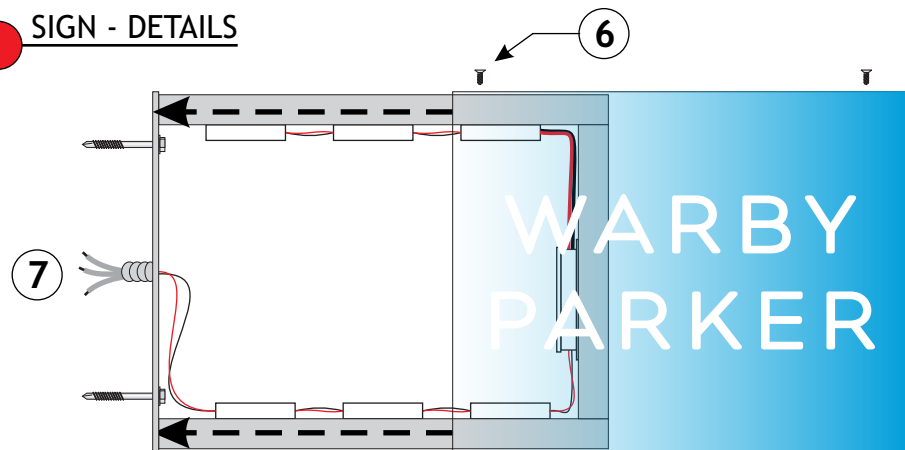

SIGN - DETAILS

- ① 3" DEEP FABRICATED ILLUMINATED ALUMINUM SIGN BOX WILL SLIDE OVER MOUNTING FRAME BLADE SIGN PAINTED WP YOSEMITE BLUE, SATIN FINISH ON ALL SIDES.
- ② 3/8" THICK CLEAR PUSH THRU ACRYLIC LETTERS WITH MILLED EDGES AND FROSTED FACES GLUED TO 3/16" 7328 WHITE DIFFUSER PANELS. PANELS HELD INTO PLACE WITH STUDS AND NUTS.
- ③ ALUMINUM STRUCTURE FRAME IS WELDED TO A 1/4" THICK ALUMINUM MOUNTING PLATE.
- ④ MOUNTING PLATE/FRAME ASSEMBLY IS BOLTED DIRECTLY TO WALL WITH SITE SPECIFIC FASTENERS. ENTIRE FRAMING AND HARDWARE WILL BE HIDDEN ONCE THE 'SIGN BOX' IS INSTALLED. **G.C. TO PROVIDE ADEQUATE WOOD BLOCKING IF NEEDED.**

- ⑤ GE TETRA EDGE STRIP HO 5000K LED UNITS TO ILLUMINATE SIGN, LEDS ARE MOUNTED ALONG TOP AND BOTTOM OF THE SIGN FRAME.
- ⑥ SIGN BOX IS REMOVABLE WITH COUNTERSINK SCREWS ON TOP.
- ⑦ PRIMARY WIRING THROUGH G.C. PROVIDED BLOCKING, CENTER OF MOUNTING PLATE TO SELF CONTAINED 24V LOW VOLTAGE POWER SUPPLY.
- ⑧ WEEP HOLE WITH LIGHT BLOCK.



93 Industry Drive
PO Box 349
Versailles, KY 40383
859.879.1199



WARBY PARKER

STORE: 348

SHOPPES AT ISLE VERDE
900 S. STATE RD 7
WELLINGTON, FL 33414

This sign is intended to be installed in accordance with the requirements of Article 600 of the National Electrical Code and/or other applicable local codes. This includes proper grounding and bonding of the sign.

RUGGLES SIGN DOES NOT PROVIDE PRIMARY ELECTRICAL TO SIGN LOCATION!



Submittal Date: 09/23/24
Acct Rep: Rick Branham
Designer: Fred Burch V

REVISIONS

r1: 09/26/24	r7: _____
r2: 09/30/24	r8: _____
r3: 10/01/24	r9: _____
r4: 10/10/24	r10: _____
r5: _____	r11: _____
r6: _____	r12: _____

C LED LETTERS ON ACRYLIC PANEL - ELEVATION
Scale: 3" = 1' - 0"

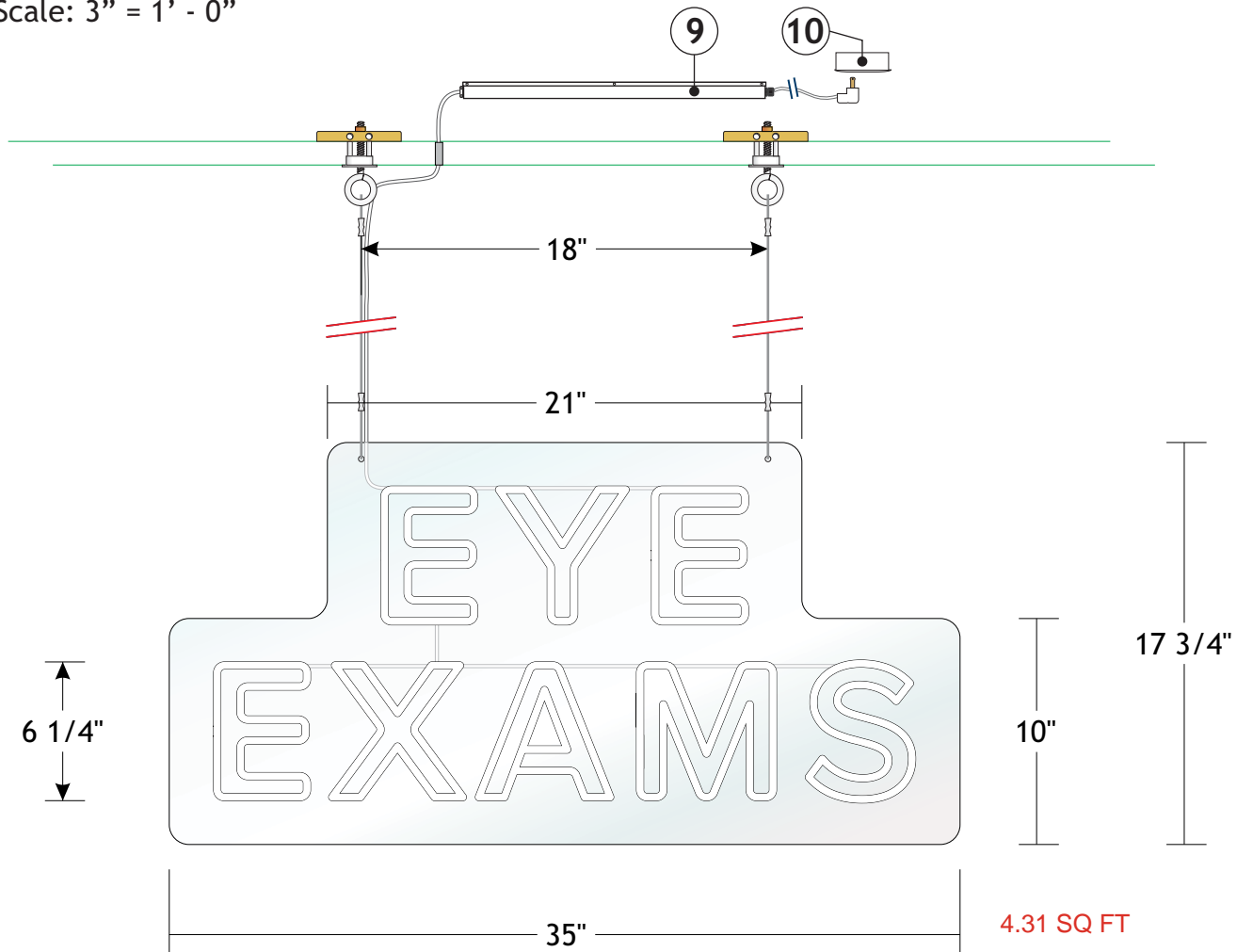

LED LETTERS ON ACRYLIC PANEL - SECTION
Scale: 3" = 1' - 0"

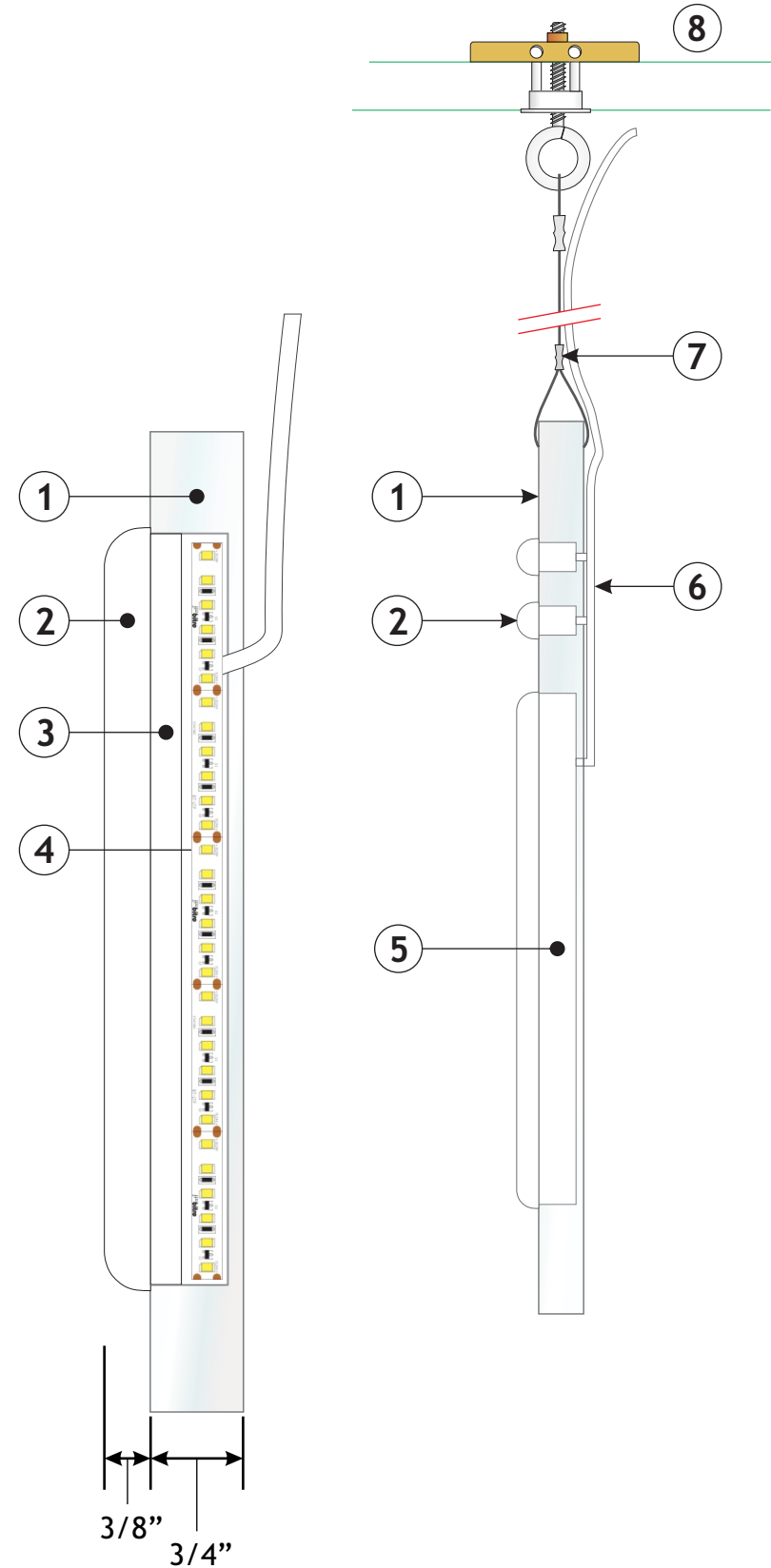

SIGN - DETAILS

- 1 3/4" THICK ROUTED CLEAR ACRYLIC PANEL WITH FLAME POLISHED OUTER EDGES.
- 2 3/8" THICK WHITE LIGHT DIFFUSING ACRYLIC WITH FACE ROUTER DOMED AND CLEAR COATED.
- 3 1/4" THICK CLEAR ACRYLIC EPOXY BONDED TO DOMED FACE.
- 4 BITRO SOLIDFLEX 5000K LED TAPE LIGHTING APPLIED TO INSIDE OF ROUTED CHANNEL RETURNS.
- 5 RETURNS ARE PAINTED SATIN WHITE, THEN PAINTED OPAQUE BLACK, FOLLOWED BY HIGH GLOSS WHITE PAINT.
- 6 LOW VOLTAGE WHITE WIRE ELECTRICAL JUMPS BETWEEN LETTERS AND UP TO POWER SUPPLY.
- 7 500LB MONOFILAMENT LINE WITH CRIMP LOOPS FOR SUSPENDED MOUNTING.
- 8 SITE SPECIFIC MOUNTING METHOD TBD AT EACH LOCATION BY INSTALLER, EXAMPLE SHOWN; DRYWALL TOGGLE WITH EYE BOLTS.
- 9 UL LISTED POWER SUPPLIES CONTAINED IN A 1 1/2" TALL X 3" WIDE X 28" LONG ALUMINUM ENCLOSURE WITH ACCESS DOOR ON TOP, PAINTED MATTE WHITE, MOUNTED VIA TBD.
- 10 WHITE GROUNDED PLUG WITH WHITE CORD WILL PLUG INTO CLOSE PROXIMITY PROVIDED DUPLEX OUTLET.



93 Industry Drive
PO Box 349
Versailles, KY 40383
859.879.1199



WARBY PARKER

STORE: 348
SHOPPES AT ISLE VERDE
900 S. STATE RD 7
WELLINGTON, FL 33414

This sign is intended to be installed in accordance with the requirements of Article 600 of the National Electrical Code and/or other applicable local codes. This includes proper grounding and bonding of the sign.

RUGGLES SIGN DOES NOT PROVIDE PRIMARY ELECTRICAL TO SIGN LOCATION!



Submittal Date: 09/23/24
Acct Rep: Rick Branham
Designer: Fred Burch V

REVISIONS	
r1: 09/26/24	r7: _____
r2: 09/30/24	r8: _____
r3: 10/01/24	r9: _____
r4: 10/10/24	r10: _____
r5: _____	r11: _____
r6: _____	r12: _____

WP ee6.25 domed PL35 susp

STOREFRONT - WEST ELEVATION

Scale: 1/4" = 1' - 0"

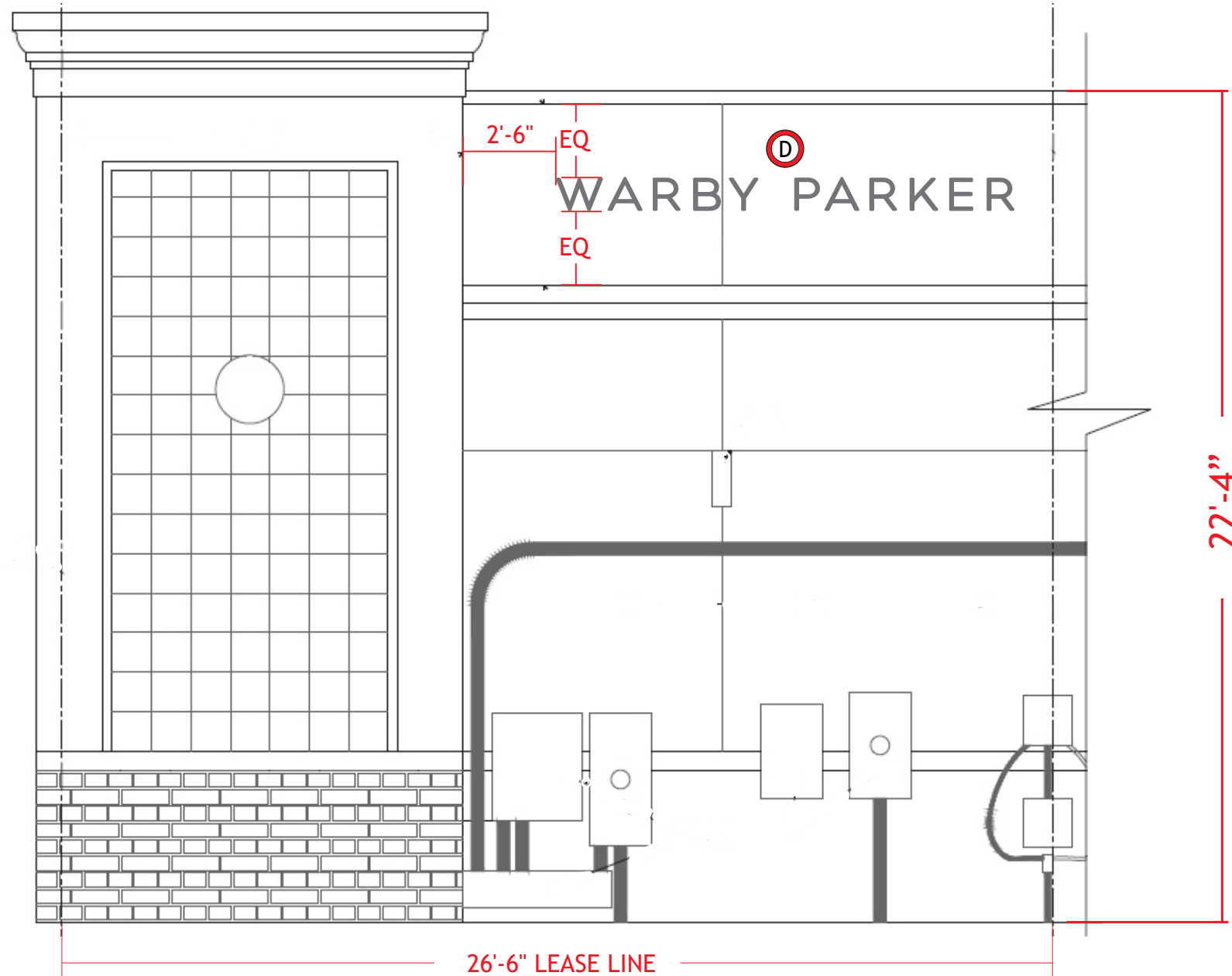

93 Industry Drive
PO Box 349
Versailles, KY 40383
859.879.1199



WARBY PARKER

STORE: 348

SHOPPES AT ISLE VERDE
900 S. STATE RD 7
WELLINGTON, FL 33414

This sign is intended to be installed in accordance with the requirements of Article 600 of the National Electrical Code and/or other applicable local codes. This includes proper grounding and bonding of the sign.

RUGGLES SIGN DOES NOT PROVIDE PRIMARY ELECTRICAL TO SIGN LOCATION!



Submittal Date: 09/23/24
Acct Rep: Rick Branham
Designer: Fred Burch V

REVISIONS

r1: 09/26/24	r7: _____
r2: 09/30/24	r8: _____
r3: 10/01/24	r9: _____
r4: 10/10/24	r10: _____
r5: _____	r11: _____
r6: _____	r12: _____

- A** WP13RPT 2L Qty - 2
- B** WP 2L BLD24 illum Qty - 1
- C** WP ee6.25 domed PL35 susp Qty - 1
- D** WP11FCO Qty - 1
- E** WP PL125.25 Qty - 1
- F** WP PL124.25 Qty - 1

D FLAT CUT OUT LETTERS - ELEVATION
Scale: 1/2" = 1' - 0"



SIGN - DETAILS

- ① 1/2" THICK ROUTED ACRYLIC LETTERS PAINTED TO MATCH GRAVEL GRAY 2127-30.
- ② LETTERS MOUNT FLUSH TO STOREFRONT REAR SURFACE WITH 8-32 X 1" THREADED STUDS AND SILICONE.

FLAT CUT OUT LETTERS - SECTION
Scale: 1" = 0' - 2"

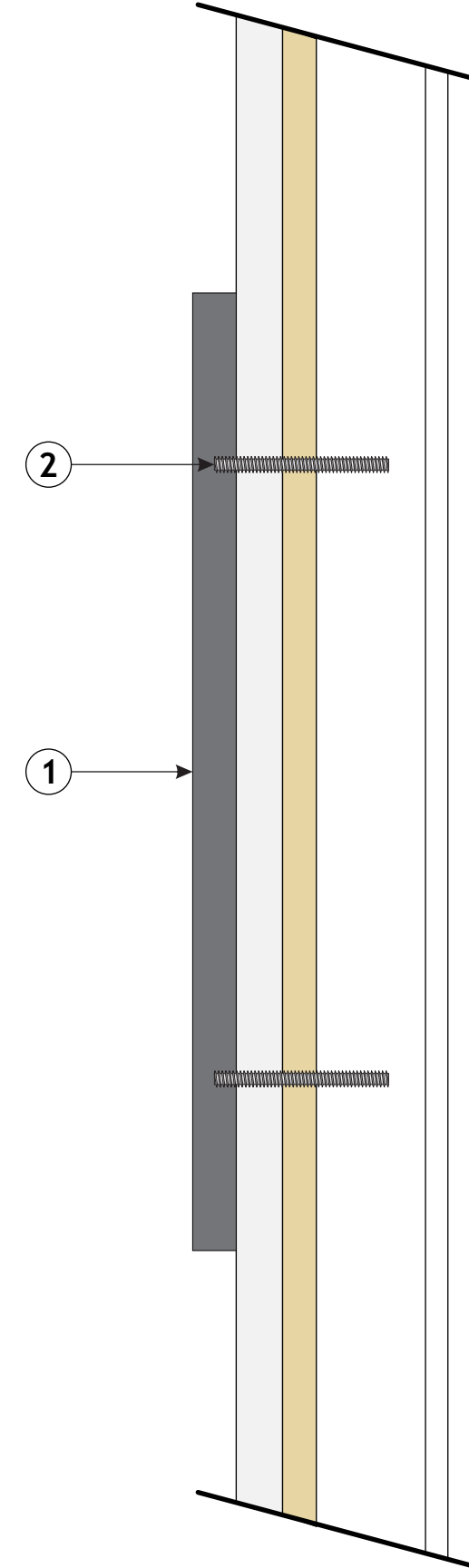

93 Industry Drive
PO Box 349
Versailles, KY 40383
859.879.1199



STORE: 348

SHOPPES AT ISLE VERDE
900 S. STATE RD 7
WELLINGTON, FL 33414

This sign is intended to be installed in accordance with the requirements of Article 600 of the National Electrical Code and/or other applicable local codes. This includes proper grounding and bonding of the sign.

RUGGLES SIGN DOES NOT PROVIDE PRIMARY ELECTRICAL TO SIGN LOCATION!



Submittal Date: 09/23/24
Acct Rep: Rick Branham
Designer: Fred Burch V

REVISIONS

r1: <u>09/26/24</u>	r7: _____
r2: <u>09/30/24</u>	r8: _____
r3: <u>10/01/24</u>	r9: _____
r4: <u>10/10/24</u>	r10: _____
r5: _____	r11: _____
r6: _____	r12: _____

E FLAT PANEL WITH TRIM - ELEVATION
Scale: 1/2" = 1' - 0"

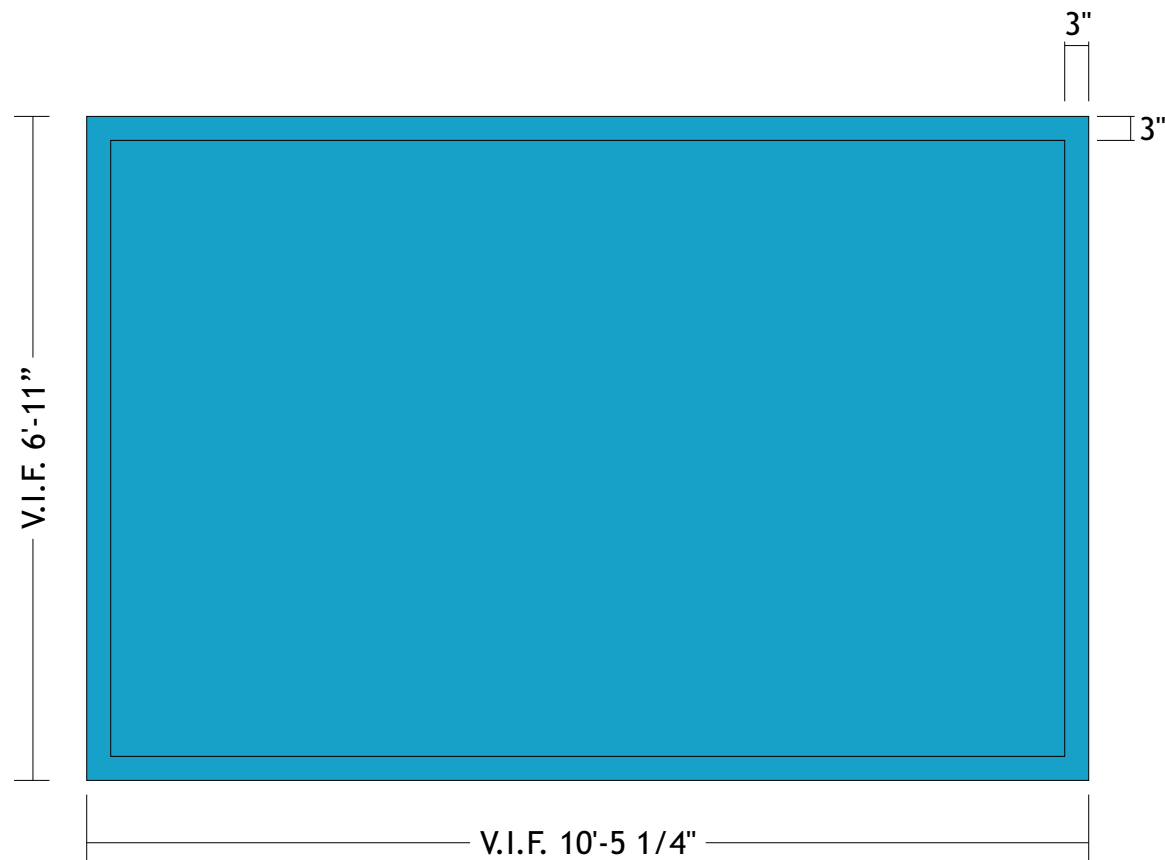

● FLAT PANEL WITH TRIM - SECTION
Scale: 1" = 0' - 2"

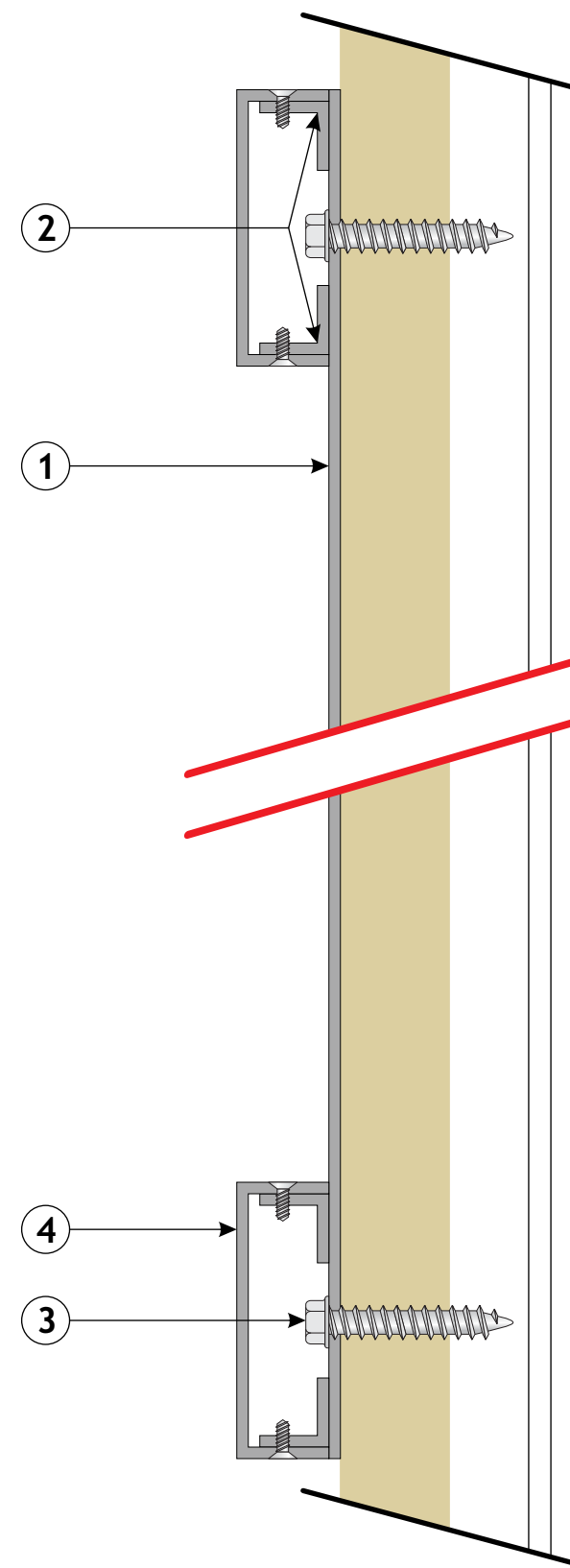

● SIGN - DETAILS

- ① 1/8" THICK ALUMINUM PANEL WITH PRE-DRILLED HOLES FOR 13" TALL WARBY PARKER STACKED LAYOUT LETTERS MOUNTING AND ELECTRIC. PANEL IS PAINTED TO MATCH BENJAMIN MOORE 2059-40 YOSEMITE BLUE, SATIN FINISH.
- ② 3/4" X 3/4" ALUMINUM ANGLE WELDED ALONG PERIMETER OF PANEL.
- ③ ALUMINUM PANEL IS MOUNTED FLUSH TO STOREFRONT WALL WITH SITE SPECIFIC FASTENERS (T.B.D.).
- ④ 3" TALL X 1" DEEP C-CHANNEL MOUNTS OVER ALUMINUM ANGLE AND FASTENS WITH COUNTERSUNK SCREWS. C-CHANNEL AND SCREW HEADS PAINTED TO MATCH BENJAMIN MOORE 2059-40 YOSEMITE BLUE, SATIN FINISH.



93 Industry Drive
PO Box 349
Versailles, KY 40383
859.879.1199



WARBY PARKER

STORE: 348

SHOPPES AT ISLE VERDE
900 S. STATE RD 7
WELLINGTON, FL 33414

This sign is intended to be installed in accordance with the requirements of Article 600 of the National Electrical Code and/or other applicable local codes. This includes proper grounding and bonding of the sign.

RUGGLES SIGN DOES NOT PROVIDE PRIMARY ELECTRICAL TO SIGN LOCATION!



Submittal Date: 09/23/24
Acct Rep: Rick Branham
Designer: Fred Burch V

REVISIONS

r1: 09/26/24	r7: _____
r2: 09/30/24	r8: _____
r3: 10/01/24	r9: _____
r4: 10/10/24	r10: _____
r5: _____	r11: _____
r6: _____	r12: _____

F FLAT PANEL WITH TRIM - ELEVATION
Scale: 1/2" = 1' - 0"

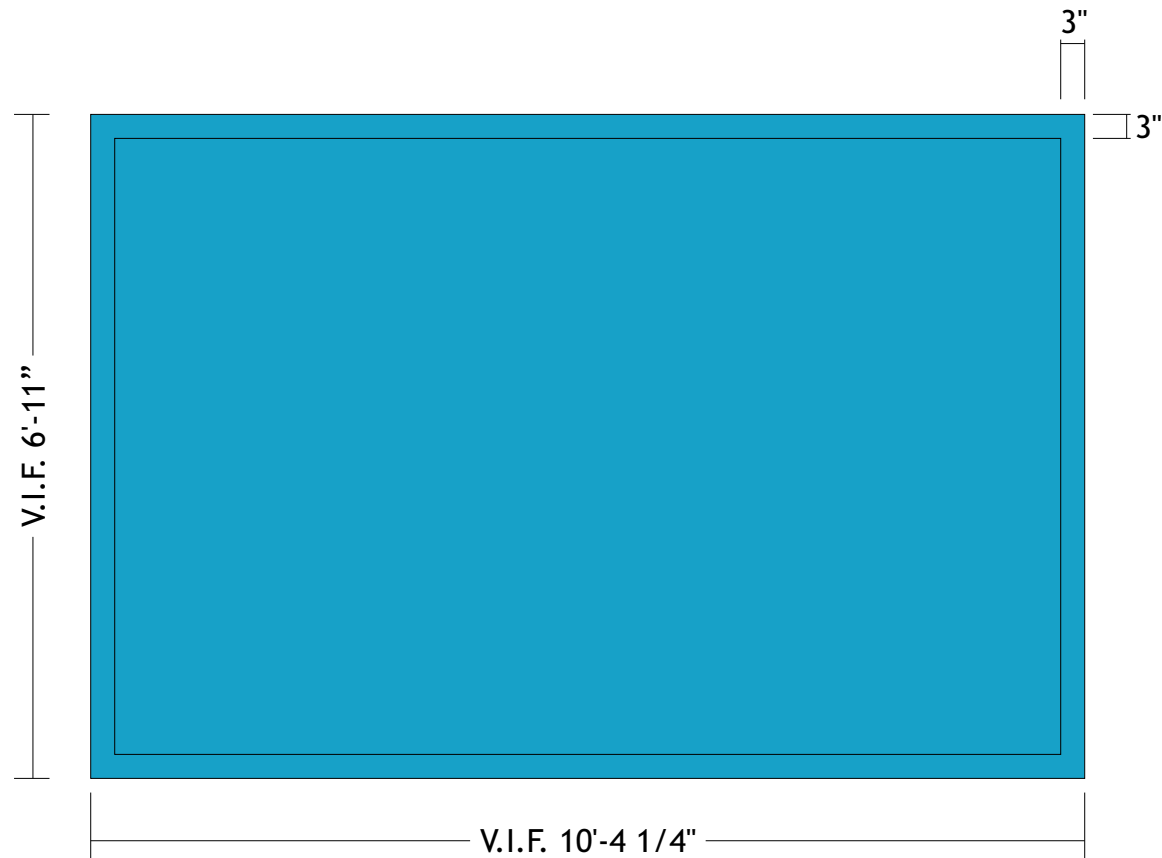

● FLAT PANEL WITH TRIM - SECTION
Scale: 1" = 0' - 2"

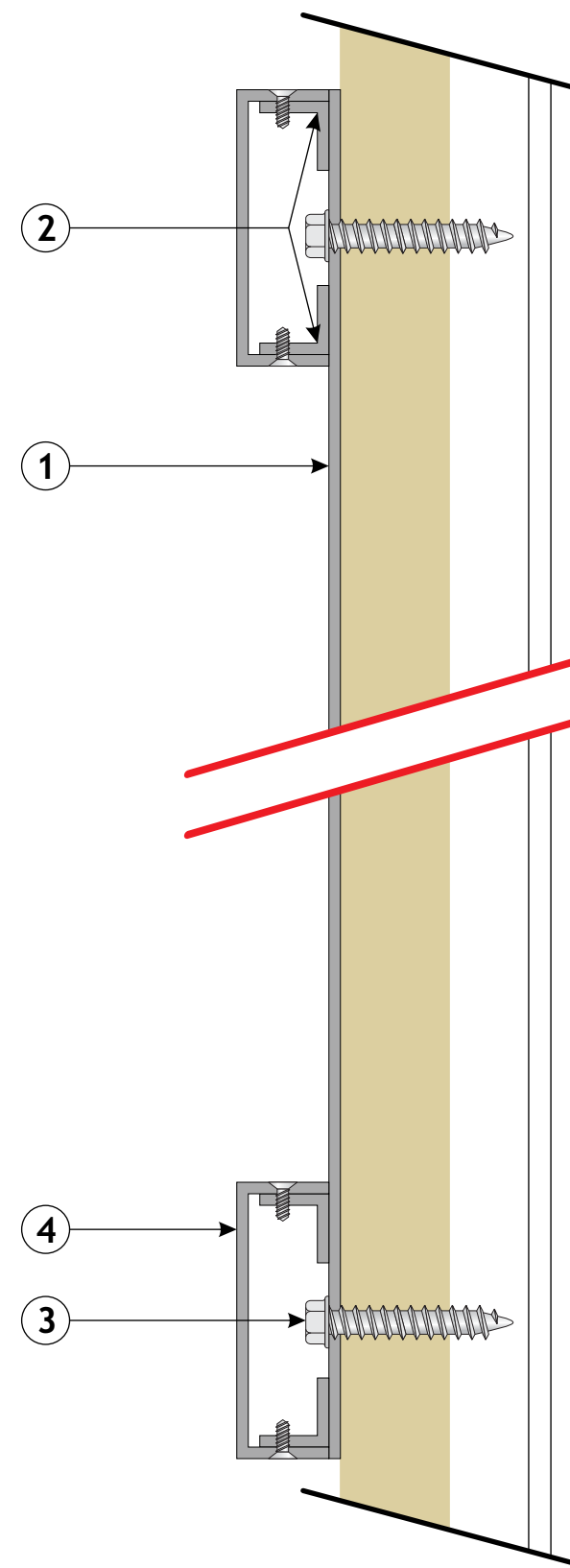

● SIGN - DETAILS

- ① 1/8" THICK ALUMINUM PANEL WITH PRE-DRILLED HOLES FOR 13" TALL WARBY PARKER STACKED LAYOUT LETTERS MOUNTING AND ELECTRIC. PANEL IS PAINTED TO MATCH BENJAMIN MOORE 2059-40 YOSEMITE BLUE, SATIN FINISH.
- ② 3/4" X 3/4" ALUMINUM ANGLE WELDED ALONG PERIMETER OF PANEL.
- ③ ALUMINUM PANEL IS MOUNTED FLUSH TO STOREFRONT WALL WITH SITE SPECIFIC FASTENERS (T.B.D.).
- ④ 3" TALL X 1" DEEP C-CHANNEL MOUNTS OVER ALUMINUM ANGLE AND FASTENS WITH COUNTERSUNK SCREWS. C-CHANNEL AND SCREW HEADS PAINTED TO MATCH BENJAMIN MOORE 2059-40 YOSEMITE BLUE, SATIN FINISH.



93 Industry Drive
PO Box 349
Versailles, KY 40383
859.879.1199



WARBY PARKER

STORE: 348

SHOPPES AT ISLE VERDE
900 S. STATE RD 7
WELLINGTON, FL 33414

This sign is intended to be installed in accordance with the requirements of Article 600 of the National Electrical Code and/or other applicable local codes. This includes proper grounding and bonding of the sign.

RUGGLES SIGN DOES NOT PROVIDE PRIMARY ELECTRICAL TO SIGN LOCATION!



Submittal Date: 09/23/24
Acct Rep: Rick Branham
Designer: Fred Burch V

REVISIONS

r1: 09/26/24	r7: _____
r2: 09/30/24	r8: _____
r3: 10/01/24	r9: _____
r4: 10/10/24	r10: _____
r5: _____	r11: _____
r6: _____	r12: _____