



**CAULFIELD & WHEELER, INC.**  
Consulting Engineers • Surveyors & Mappers

Celebrating  
**35**  
years

Engineering EB0003591  
Surveying LB0003591  
Landscape Architecture LC0000318

November 12, 2024

Mr. Jonathan Reinsvold, P.E.  
Village of Wellington  
12300 Forest Hill Boulevard  
Wellington, FL 33414  
Ph: (561)791-4000; Fax: (561)791-4045

**Subject:           Plat Name: Winding Trails Replat**  
**CWI Project #7765**

Dear Mr. Reinsvold:

I hereby certify that the PRM's have been set and there have been no changes to the approved preliminary plat since issuance of Technical Compliance:

Sincerely,  
Caulfield & Wheeler, Inc.

David P. Lindley, P.L.S.  
Reg. Land Surveyor #5005  
State of Florida – LB #3591  
For the Firm

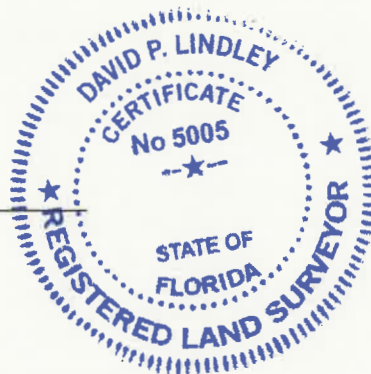

P:\07765-00-00-00\docs\corres\11.12.24\_Certified Statement from Surveyor\_Village Wellington.doc

**EXHIBIT C**  
**SURVEYORS CERTIFICATE RE: PRMs & NO CHANGES**