

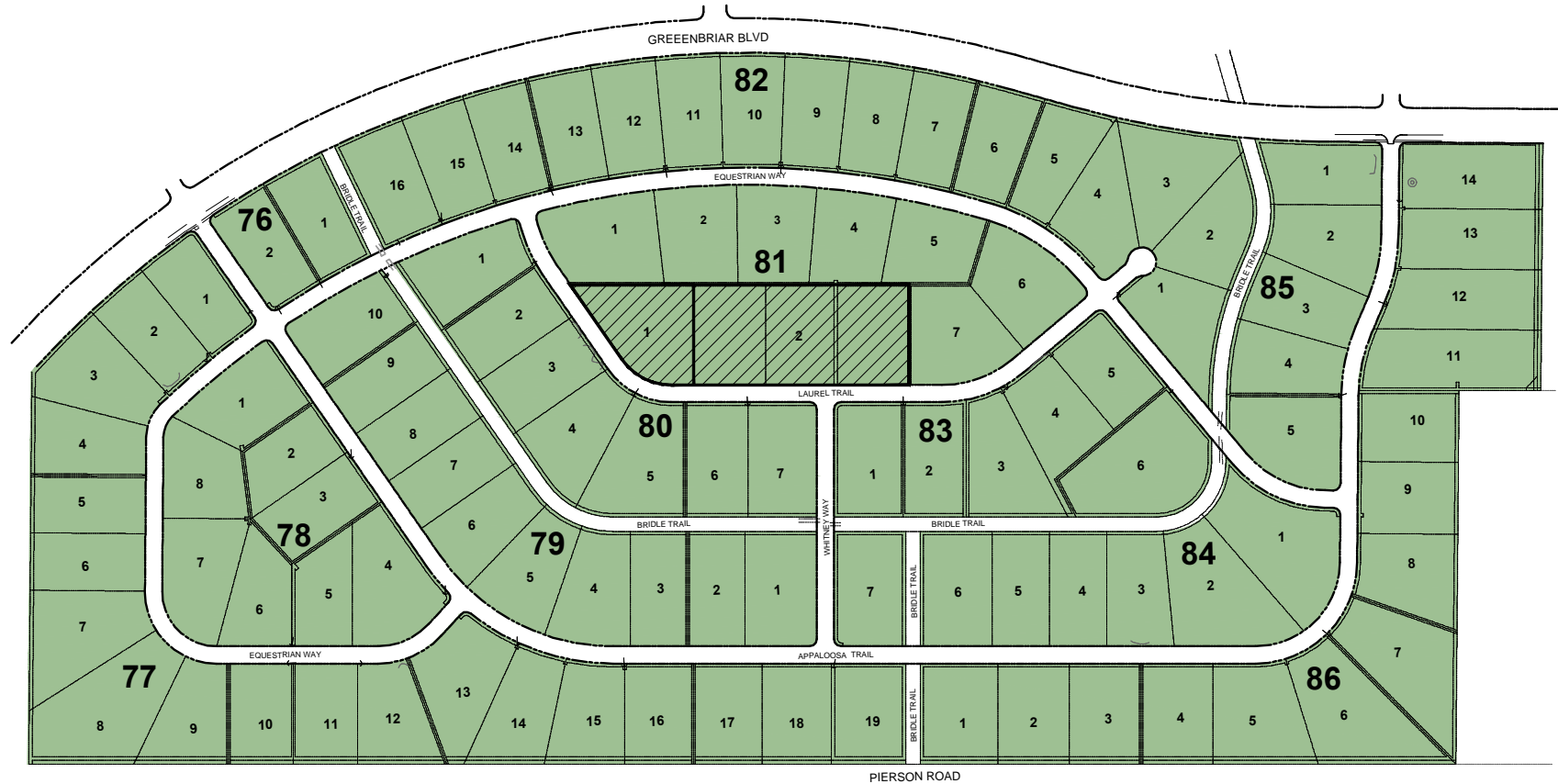

North

SADDLE TRAIL PARK - (SOUTH) - PLAT



**SADDLE TRAIL PARK - (SOUTH)
WELLINGTON, FLORIDA**

EXHIBIT "B"

**PROPERTIES WITHIN
SADDLE TRAIL PARK SOUTH
TO BE ASSESSED**

103 LOTS TOTAL

LEGEND:

86 BLOCK NUMBER

6 LOT NUMBER



NOTES:

BLOCKS 76, 77, 78, 79, 80, 81, 82, 83, 84, 85 AND 86 OF THE PLAT OF SADDLE TRAIL PARK OF WELLINGTON AS RECORDED IN PLAT BOOK 41, PAGES 103, 104 & 105 AND THE PLAT OF SADDLE TRAIL PARK OF WELLINGTON REPLAT NO. 1 RECORDED IN PLAT BOOK 108, PAGES 118-119 OF THE OFFICIAL RECORDS OF PALM BEACH COUNTY, FLORIDA.

LOTS 8, 9, 10 & 11 OF BLOCK 81 FROM THE ORIGINAL PLAT OF SADDLE TRAIL PARK OF WELLINGTON WERE RECOMBINED PER PLAT BOOK 108, PAGES 118-119, OF THE OFFICIAL RECORDS OF PALM BEACH COUNTY, FL



WGI
2035 Vista Parkway, Suite 100
West Palm Beach, FL 33411
Phone No. 561.687.2220
Fax No. 561.687.1110
Cert No. 6091 - LB No. 7055

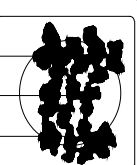

DATE	DRAWN BY
FEB 2015	GAT
DESIGNED BY	CHECKED BY
CJH	B. LAMAR
WGI PROJECT NUMBER	
1525.00	

WELLINGTON
Engineering Department
12300 West Forest Hill Boulevard, Wellington, Florida 33414