



# Equestrian Trails Circulation Master Plan Recommendations 2025-2027 Exhibit G

## Recommendations

- 1A. Improvements of Section 34 Bridle Trail
- 2A. Installation of Fencing along the Pink Trail
- 1B. Water and Shelter Location
- 2B. White Trail Improvement
- 3B. Proposed Culvert Canal Crossing
- 4B. Drainage and Bridle Trail Improvement
- 1C. Dark Green Trail Improvement

\*See Exhibit J for further details

## LEGEND

- - - Public Bridle Trail
- ✱ Potable Water & Shelter
- Proposed Crosswalk
- △ Proposed Canal Crossing
- ▨ Grand Champions Polo Club
- ▨ National Polo Center
- ▨ Wellington International

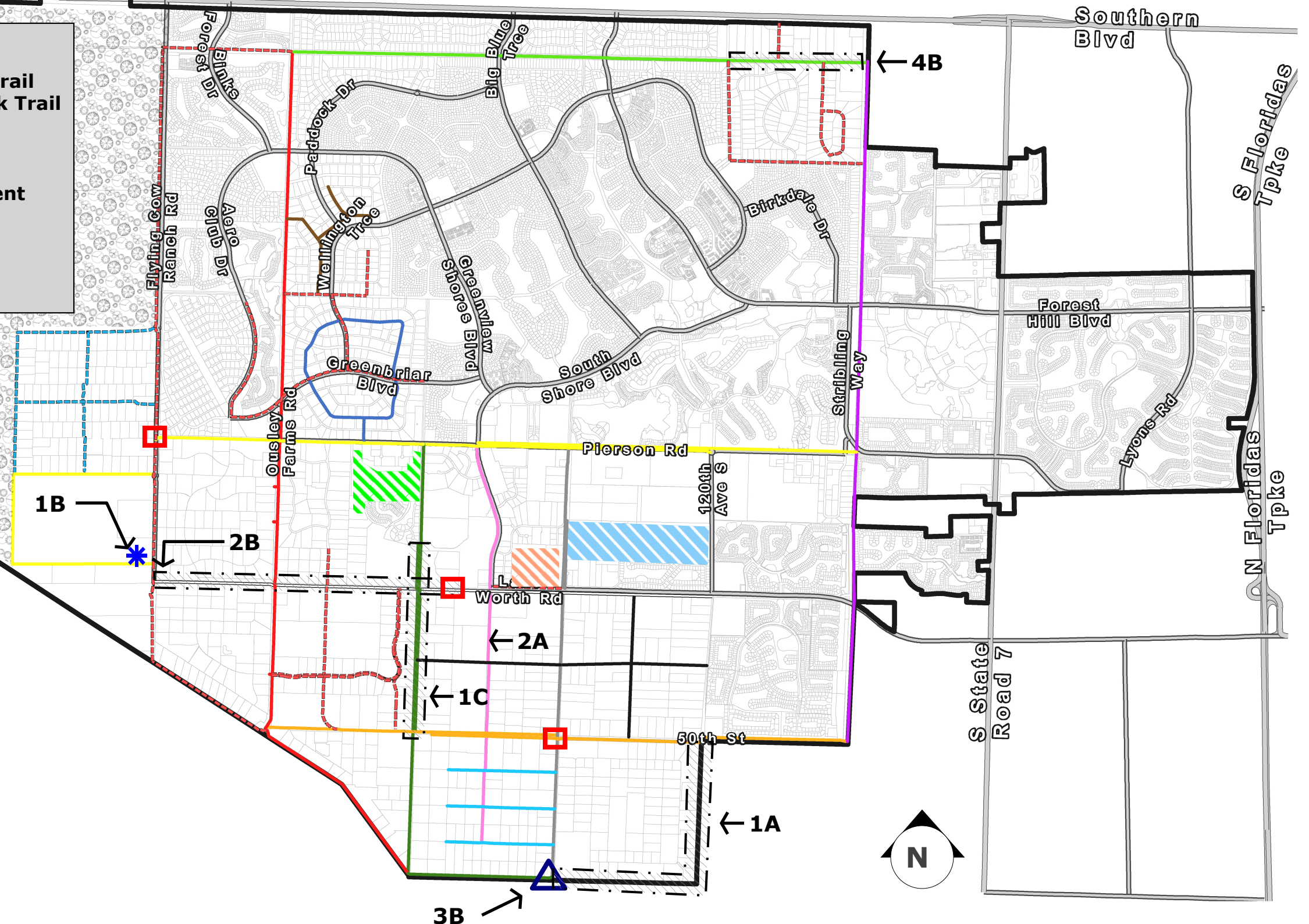

Date: 12/10/2024