

Exhibit E - Approved Landscaping



Front (West) Elevation
Scale: 1/16" = 1'-0"



Simulated Night View
No Scale

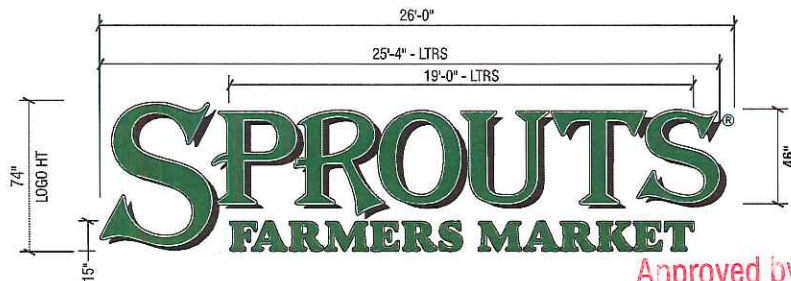

1 46" STD LED Channel Letters
scale: 1/4" = 1'-0"

SPROUTS
159
SQ. FEET

Approved by Village of Wellington
PLANNING & ZONING DIVISION
Lowell J. J. J.
DATE: 10/18/10



2 34.4
SQ. FEET

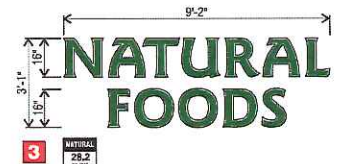

3 28.2
SQ. FEET

It is the intent and purpose of this color rendering to provide a basic color representation of your sign finish and color. However, digital media and printed colors will vary from actual paint finish and color. Existing painted surfaces will have a perceptible difference in shade and sheen from your sign finish. Providing a sample of the paint you wish to match or a Matthews paint color formula will minimize the differences.

16265 Star Road Nampa, ID 83687 toll free: 800.592.8058 tele: 208.345.4020 fax: 208.336.9886 www.imagenational.com

image national signs
...bringing your image to light!

PROJECT TITLE:

SPROUTS
FARMERS MARKET

LOCATION:

SITE: # 620
820 S. State Road 7
Wellington, FL

REQUESTED BY:

J.G.

DRAWN BY:

SPH

COMPUTER FILE
INCLUDING DATE:

SFM-WellingtonFL-R7-061418

UNDERWRITERS
LABORATORIES
ELECTRIC DIV.

NAMPA PLANT -
UL #433195-001

UL E-PP - All signs conform to UL-910A labeled according to E-PP must comply with UL-910A label provisions. Canada - all signs must be C-UL compliant. This sign is intended to be installed in accordance with the requirements of Article 604 of the National Electrical Code and/or applicable local codes. This includes proper grounding and bonding of the sign.

page #

2 of 9

© 2017 Image national signs. This design is an original work of authorship by Image National, Inc. (Image) which owns the copyright protection by the copyright laws of the United States (Title 17, U.S.C.). All rights are reserved by image and, until the use of this design is authorized by image in writing, image owns the exclusive rights to: a) reproduce this design in copies, in graphic form or as a sign; b) prepare derivative works based upon the design; c) distribute copies of this design by sale or other transfer of ownership; and d) display the design publicly.

*ARB 18-026 (ARB 18-006)
Sprouts @ Isla Verde
Signage & Elevations*

QTY	BOTANICAL NAME	COMMON NAME	SIZE	SPACING	REMARKS
CANOPY/ACCENT TREES					
3	LIGUSTRUM JAPONICUM	JAPANESE PRIVET	65 GAL, 6' O.A. X 5' SPRD.	A.S.	FULL AND THICK, LIMBED UP, MATCHED
PALM TREES					
2	RELOCATED ROYSTONEA ELATA	RELOCATED FLORIDA ROYAL PALM	RELOCATED	A.S.	EXISTING TO BE RELOCATED FROM PLANTER BEING REMOVED
2	VEITCHIA WININ	WININ PALMS	12' O.A., 8' C.T.	A.S.	FULL, SHADE GROWN, FL. FANCY
SHRUBS AND GROUNDCOVERS					
23	CONOCARPUS ERECTUS VAR. SERICEUS	SILVER BUTTONWOOD	3 GAL, 2' X 2'	2' O.C.	FULL & THICK
23	LIRIOPE MUSCARI 'EVERGREEN GIANT'	LIRIOPE	1 GAL, 1' X 1'	1.5' O.C.	FULL & THICK

Location Map

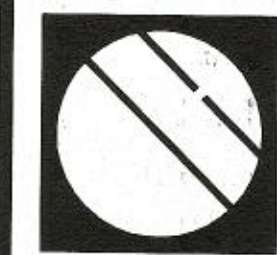
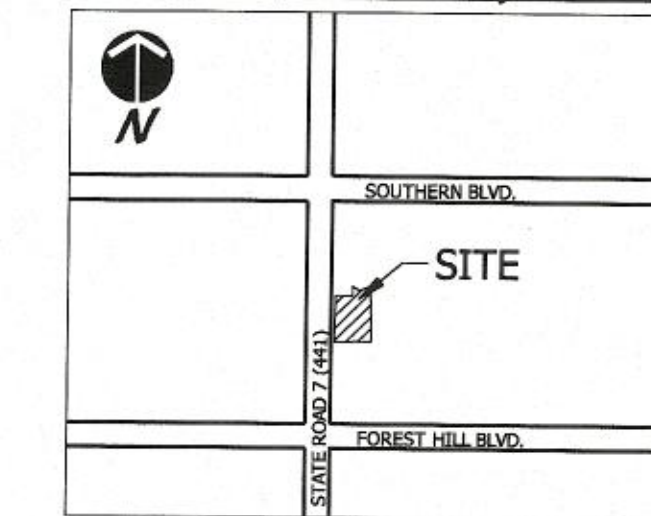

**Cotleur
Hearing**

Landscape Architecture
Planning
Environmental Consulting
Graphic Design

1934 Commerce Lane
Suite 1
Jupiter, Florida 33458
561-747-6336 Fax-747-1377

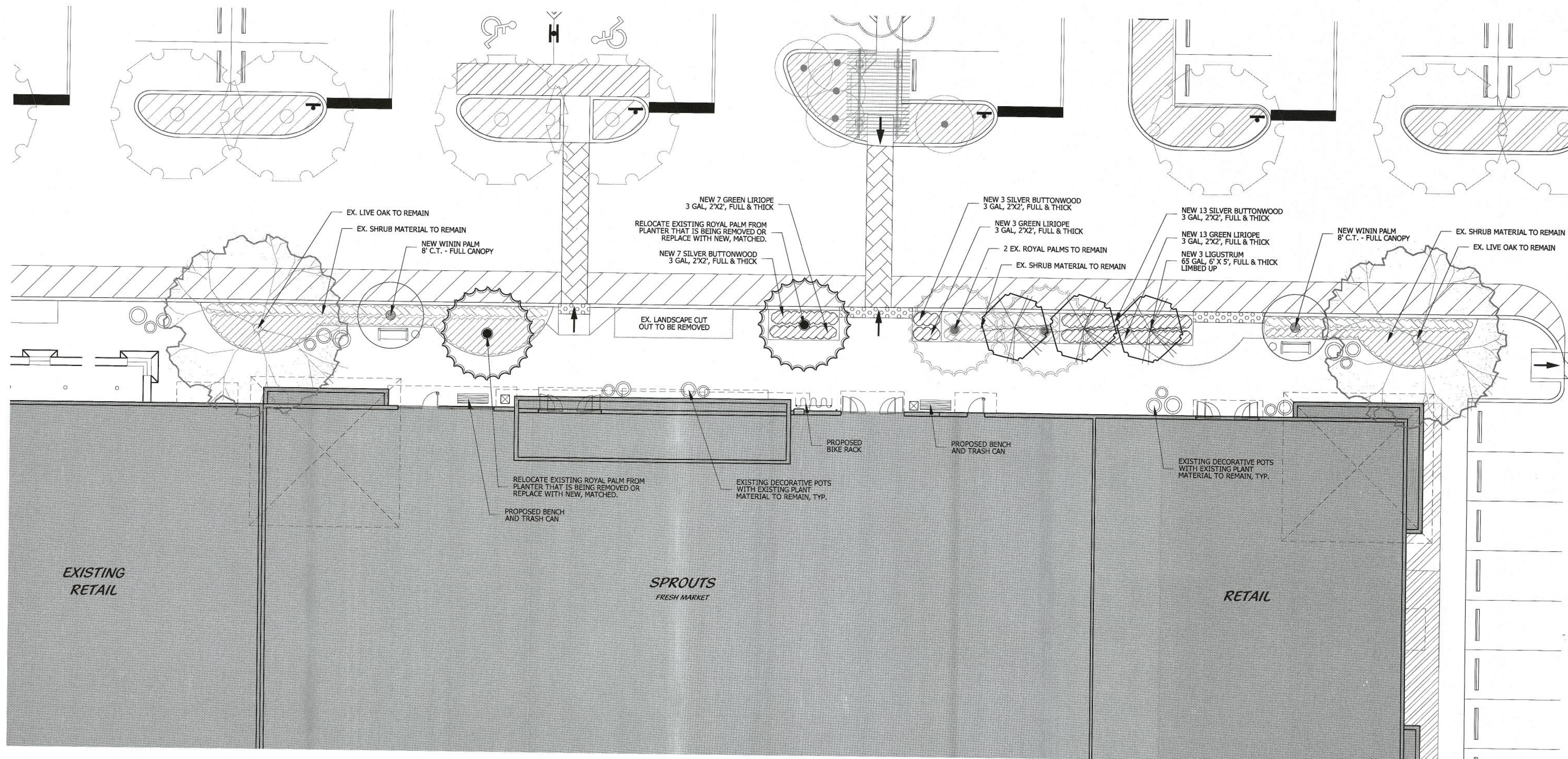

VILLAGE OF WELLINGTON
PETITION NO 18-57(2018-13 WASA1)
APPROVED DATE JUNE 28, 2018
F&Z PROJECT MANAGER: J. NEWELL

Landscape Plan

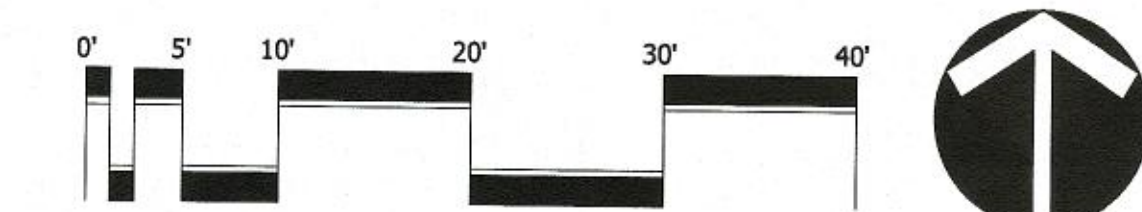

Scale: 1" = 10'-0"

North

DESIGNED DEH
DRAWN RO
APPROVED DEH
JOB NUMBER 04-1216.04
DATE 04-25-18
REVISIONS 06-06-18

SHEET 1 OF 1

June 21, 2018 3:38:34 p.m.
Drawing: 04-1216 LP.DWG

© COTLEUR HEARING INC.
These drawings are the property of the architect and are not to be used for extensions or on other projects except by agreement in writing with the architect. Immediately report any discrepancies to the architect.

Isla Verde Commercial
Wellington Isles, LLC
Village of Wellington, Florida