

SITE DATA

PETITION NUMBER 2018- SPR
NAME OF PROJECT GLOBAL DRESSAGE COMPLEX
AKA EQUESTRIAN VILLAGE
PROPOSED USE COMMERCIAL RECREATION
EXISTING FUTURE LAND USE DESIGNATION COMMERCIAL RECREATION
PROPOSED FUTURE LAND USE DESIGNATION COMMERCIAL RECREATION
EXISTING ZONING DISTRICT PUD/EOZD
PROPOSED ZONING DISTRICT PUD/EOZD
SECTION 16, TOWNSHIP 44, RANGE 41 EAST
TOTAL SITE AREA 59.37 AC
PROPERTY CONTROL NUMBERS
T3414416000005040
T3414416000005030
T3414416000005050
T3414416000005060
T3414416000005070

PERMANENT FACILITIES	ENCLOSED FLOOR AREA	BUILDING AREA
TIKI HUT	0 SF	1,450 SF
BARN 1 (96 STALLS)	12,295 SF	19,698 SF
BARN 2 (96 STALLS)	12,295 SF	19,698 SF
SHOW OFFICE	927 SF	1,242 SF
HORSE WASH FACILITY/RESTROOM 1	680 SF	1,715 SF
HORSE WASH FACILITY 2	0 SF	980 SF
MANURE BINS	0 SF	1,600 SF
COVERED EQUESTRIAN RING (210'x360')	0 SF	80,400 SF
CELL TOWER	717 SF	717 SF
SUBTOTAL	26,914 SF	127,500 SF

TEMPORARY FACILITIES	ENCLOSED FLOOR AREA	BUILDING AREA
EVENT TENTS	0 SF	16,340 SF
TEMPORARY STABLES	0 SF	31,768 SF
SUBTOTAL	0 SF	48,108 SF

TOTAL 26,914 SF 175,608 SF

FAR - ENCLOSED FLOOR AREA / (TOTAL SITE AREA x 43,560)
ENCLOSED FLOOR AREA 26,914 SF
FLOOR AREA RATIO (10.10 MAX.) 0.01

BUILDING COVERAGE - BUILDING AREA / (TOTAL SITE AREA x 43,560)
BUILDING AREA 175,608 SF
BUILDING COVERAGE (10% MAX.) 6.8%

TEMPORARY EVENT SEATING:
TEMPORARY SEATING (SPECIAL EVENTS) 1,065 SEATS MAX.
TEMPORARY EVENT TENT 235 SEATS MAX.
TEMPORARY EVENT TENT 2 200 SEATS MAX.
TOTAL 1,500 SEATS MAX.

IMPERVIOUS AREA 9.94 AC
BUILDINGS (PERMANENT) 2.94 AC
PAVEMENT/CONCRETE 7.00 AC

PERVIOUS AREA 49.43 AC
OPEN SPACE

BUILDING HEIGHT
EQUESTRIAN STABLES 35' MAX
COVERED-EQUESTRIAN RING 35' MAX

FINISHED FLOOR ELEVATION 17.50 FT NGVD MIN

PARKING CALCULATIONS:

PARKING REQUIRED:

	MIN. STANDARD	QUANTITY	REQUIRED
SHOW OFFICE/RESTROOMS	1 SP/300 SF	2,602 SF	9
PERMANENT STALLS	1 SP/3 STALLS	192 STALLS	64
	1 SP/300 SF	24,590 SF	82
TEMPORARY STALLS	1 SP/3 STALLS	186 STALLS	62
TEMPORARY EVENT TENTS	1 SP/3 SEATS	435 SEATS	145
	1 SP/EMP.	25 EMP.	25
TEMPORARY EVENT SEATING	1 SP/3 SEATS	1,065 SEATS	355
TOTAL REQUIRED			742
HANDICAP REQUIRED			15

PARKING PROVIDED:

PERMANENT:	
PAVED PARKING	213
GRASS PARKING (BARN)	170
SUBTOTAL	383
TEMPORARY:	
SHELL ROCK	29
SAND RING	158
GRASS	319
SUBTOTAL	506
TOTAL SPACES PROVIDED	889
HANDICAP PROVIDED	18
ALTERNATE TRAILER PARKING PROVIDED	72
VENDOR TENTS	60
VENDOR TRAILERS	20

HORSE SHOW SERVICES
RETAIL COMPLEX
FLU: COMMUNITY COMMERCIAL
Z: PUD

Exhibit B - Site Plan

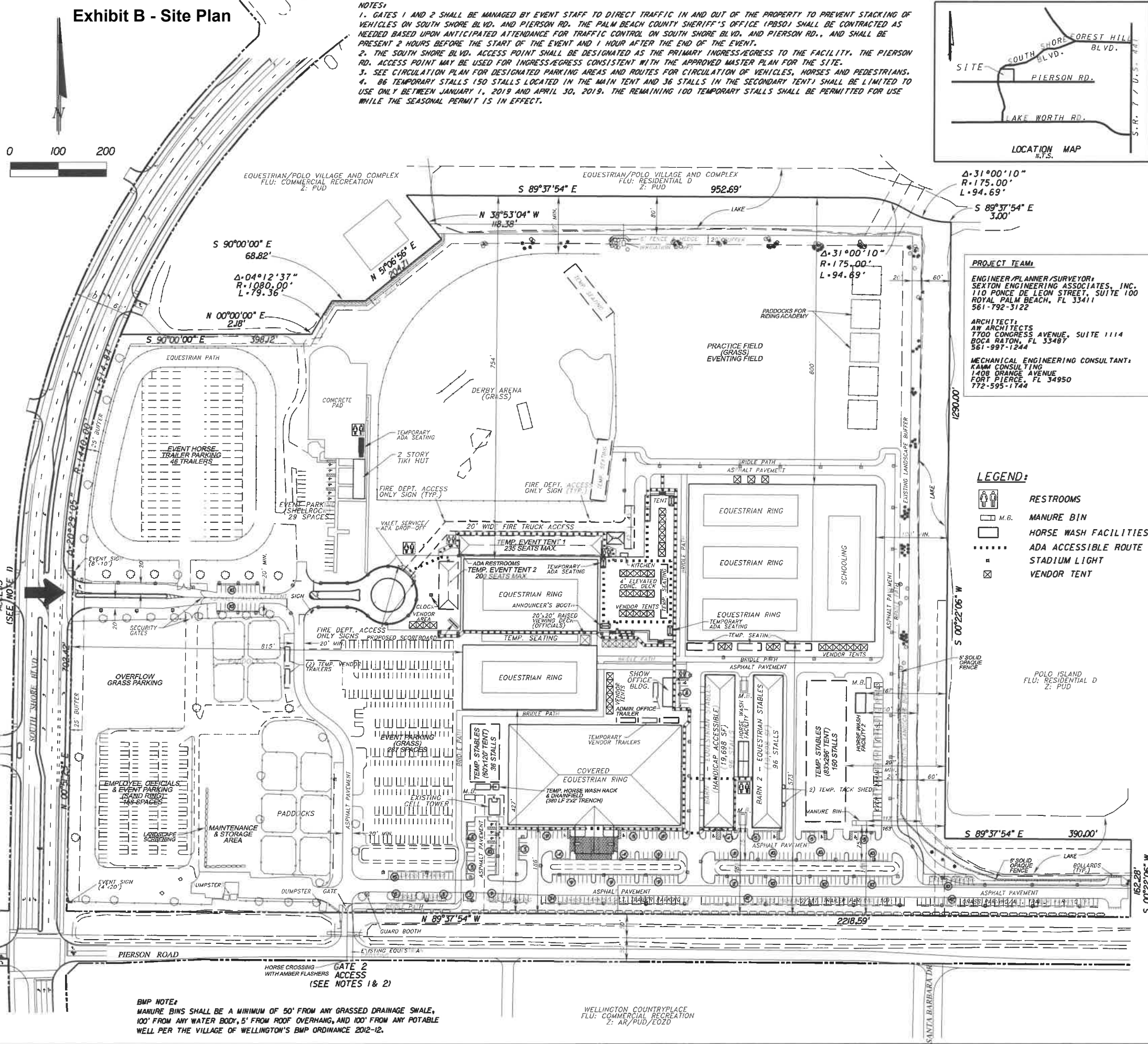

RECEIVED

By Planning and Zoning at 10:37 am, Oct 25, 2018

NO.	DATE	BY	DESCRIPTION
1	10/24/2018	MFS	REVISED PER VOW COMMENTS

2018 / 2019

SEXTON ENGINEERING ASSOCIATES, INC.

CONSULTING ENGINEERS AND SURVEYORS

GLOBAL DRESSAGE COMPLEX

WELLINGTON, FLORIDA

SEASONAL EQUESTRIAN PERMIT

SITE PLAN

110 PONCE DE LEON STREET, SUITE 100
ROYAL PALM BEACH, FLORIDA 33411
PHONE 561-792-3122 FAX 561-792-3168
FL. REGISTRATIONS: LB0006837, EB 0007864

DATE 09/28/2018
SHEET 1 OF 1
SCALE 1" = 100'