



CAULFIELD & WHEELER, INC.

Consulting Engineers • Surveyors & Mappers

Celebrating
35
years

Engineering EB0003591
Surveying LB0003591
Landscape Architecture LC0000318

October 25, 2018

Mr. Thomas J. Lundeen, P.E., Village Engineer
Village of Wellington
Engineering Services
12300 W. Forest Hill Boulevard
Wellington, Florida 33414

Re: Plat Name: Wellington Green MUPD B Replat of Tract 2 and Civic Tract (aka Fairfield Inn)
Plat #18-100125
CWI Project #3834

Dear Mr. Lundeen:

This letter is to certify that all Permanent Reference Monuments (P.R.M.s) shown on the plat of "Wellington Green MUPD B Replat of Tract 2 and Civic Tract" (aka Fairfield Inn) (unrecorded) have been set in accordance with Section 177.091(9) Florida Statutes.

Sincerely,
Caulfield & Wheeler, Inc.



David P. Lindley, P.L.S.
Reg. Land Surveyor #5005
State of Florida - LB #3591

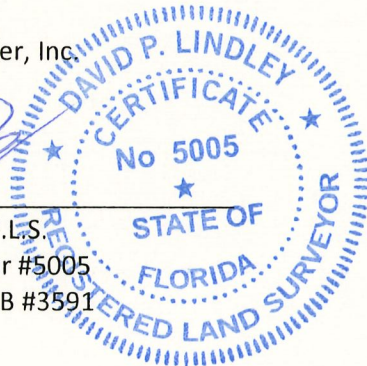

DPL:jd

Exhibit D - Surveyors Certificate re PRMs