

VILLAGE OF WELLINGTON

BINKS POINTE PATHWAY

CIVIL PLANS

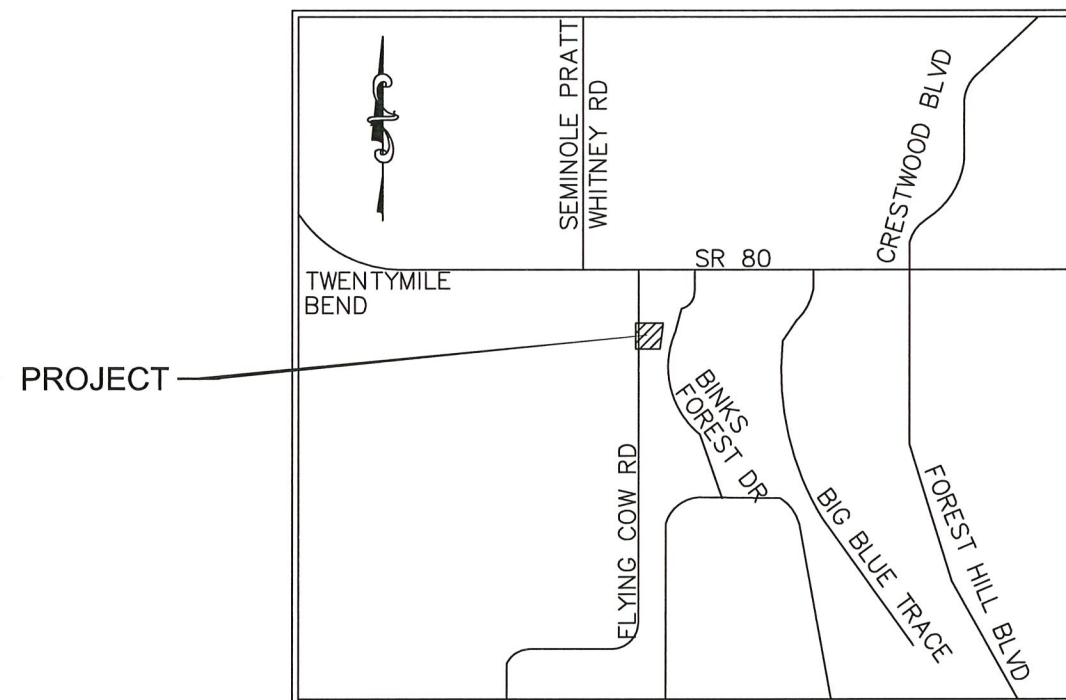
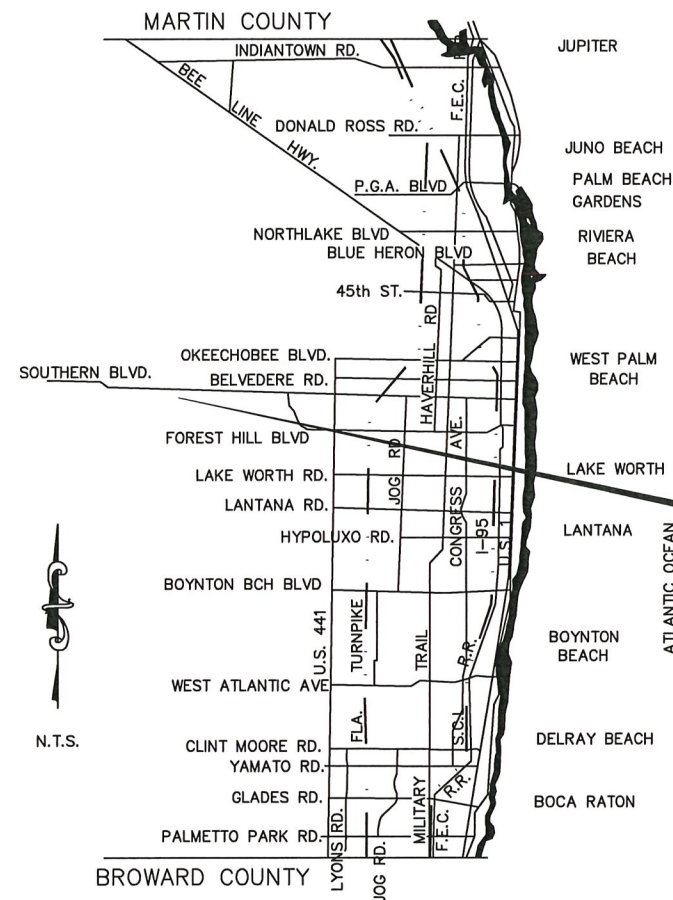

LOCATION MAP

NO SCALE

PROJECT LOCATED IN SECTIONS 1&6,
TOWNSHIP 44 SOUTH, RANGES 40&41 EAST

VERTICAL DATUM: NORTH AMERICAN VERTICAL DATUM OF 1988 (NAVD88)
TO CONVERT TO NGVD29, ADD 1.437' TO THE NAVD88 VALUE.

HORIZONTAL DATUM: NORTH AMERICAN DATUM OF 1983, FLORIDA STATE
PLANES, EAST ZONE, U.S. FEET (NAD83)

GOVERNING STANDARDS AND SPECIFICATIONS (FDOT STANDARD
PLANS FY2018-2019)

FLORIDA DEPARTMENT OF TRANSPORTATION, 2018 DESIGN
STANDARDS AND REVISED INDEX DRAWINGS ARE APPENDED HEREIN
AND 2018 STANDARD SPECIFICATIONS FOR ROAD AND BRIDGE
CONSTRUCTION.

PREPARED BY:



2035 Vista Parkway
West Palm Beach, FL 33411
Phone No. 561.687.2220
Fax No. 561.687.1110
Cert No. 6091 - LB No. 7055



FM # 438306-1-58-01

SHEET INDEX

C1	COVER SHEET
C2	KEYMAP
C3	GENERAL NOTES AND LEGENDS
C4 - C6	PLAN AND PROFILE
C7	TYPICAL SECTION
C8	GRADING SECTIONS EAST OF CANAL
C-9	STORMWATER POLLUTION PREVENTION PLAN & DETAILS
S1.0 - S3.4	STRUCTURAL PLANS
BP-1	CONTECH PEDESTRIAN BRIDGE DATA SHEET

VILLAGE OF WELLINGTON OFFICIALS

ANNE GERWIG
JOHN T. MCGOVERN
MICHAEL J. NAPOLEONE
MICHAEL DRAHOS
TANYA SISKIND

MAYOR
VICE MAYOR
COUNCILMAN
COUNCILMAN
COUNCILWOMEN

JONATHAN REINSVOLD
PAUL SCHOFIELD
TOM LUNDEEN

PROJECT MANAGER
VILLAGE MANAGER
VILLAGE ENGINEER

PLANS ARE SCALED TO PLOT ON 11" X 17"
SHEETS. THE SCALE OF THESE PLANS MAY
HAVE CHANGED DUE TO REPRODUCTION.

ENGINEER OF RECORD
THOMAS MUELLER, PE
PE# 58119

BINKS POINTE PATHWAY

WGI NO.: 2069.03
PRODUCTION PHASE

100% SUBMITTAL

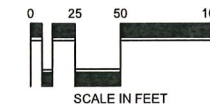

STORMWATER TREATMENT AREA 1

GOLF COURSE
MAINTENANCE BUILDING

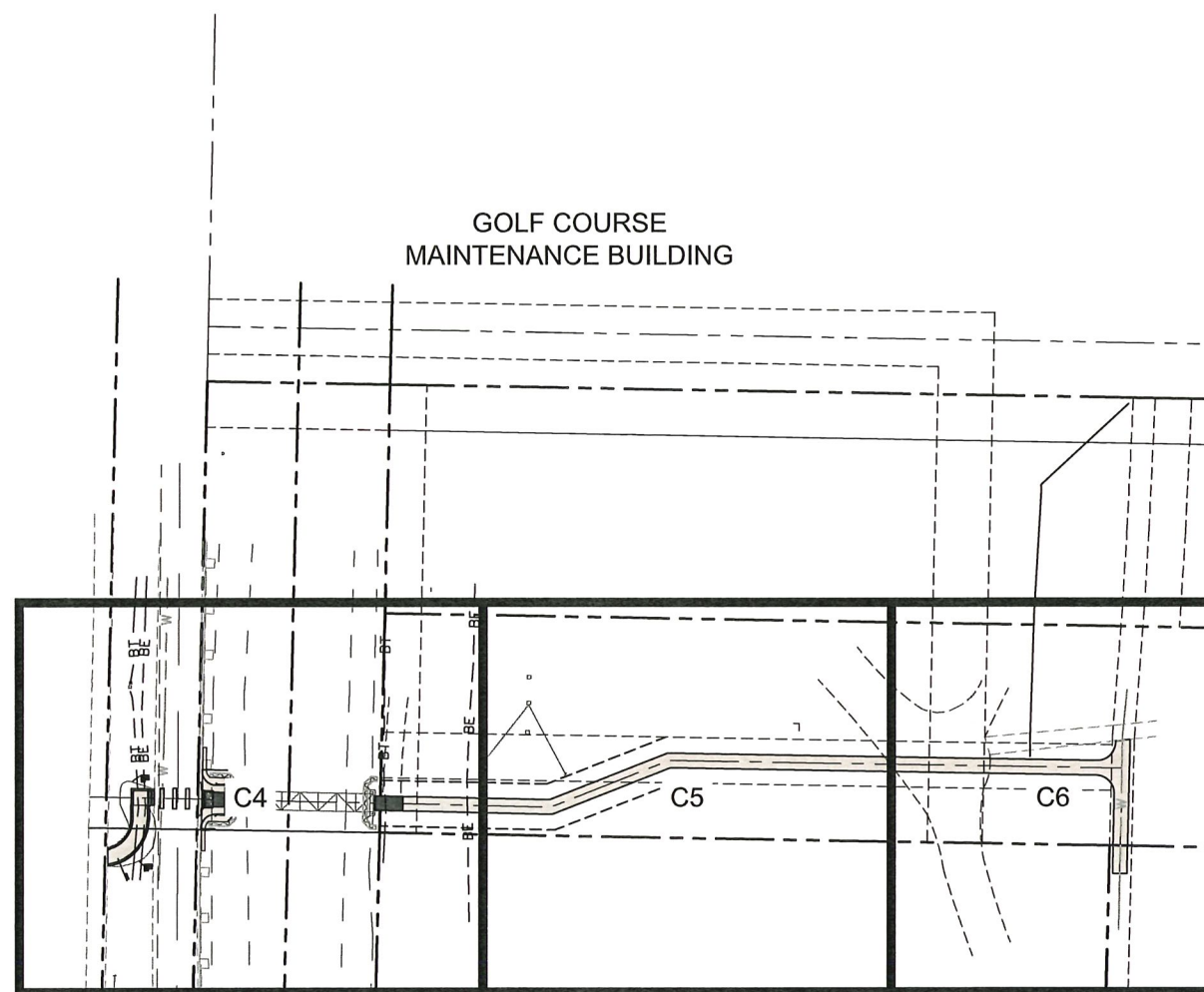

"WELLINGTON ENVIRONMENTAL PRESERVE
GREENWAY PROJECT"
FM:433196-1-58-01

FLYING COW RD

A.I.D. CANAL C-1

FPL STATION

BINKS FOREST

$$\text{NAVD88} + 1.437' = \text{NGVD29}$$

SHEET: C2

PROJECT:		ENGINEER OF RECORD THOMAS MUELLER, PE PE# 55119		CAD 206903 BPP CIVIL PLANS.DWG	
BINKS POINT PATHWAY FM# 438306-1-5B-01		TASK:		NO.	
				DATE	
KEYMAP		TOTAL SHEETS 9		JOB NO. 2069.03	
				DESIGNED SCC	
				CHECKED TM	
				DATE 8/1/17	
				REVISIONS	
				DESCRIPTION	
				BY	

WGITM

GENERAL NOTES

1. ALL WORK SHALL CONFORM TO FDOT SPECIFICATIONS AND DESIGN STANDARDS, LATEST EDITION UNLESS SPECIFIED OTHERWISE.
- 1.1. MAINTENANCE OF TRAFFIC (MOT) WITH FDOT STANDARD INDEX 600.
2. ALL WORK FOR THIS PROJECT WILL BE COMPLETED WITHIN AND FROM THE EXISTING RIGHT-OF WAY.
3. WORK INCLUDED:
- 3.1. THE CONTRACTOR SHALL FURNISH ALL LABOR, SUPERINTENDENCE, QUALITY CONTROL, MATERIALS, PLANT, POWER, LIGHT, HEAT, FUEL, WATER, TOOL, APPLIANCES, EQUIPMENT, SUPPLIES, AND OTHER MEANS OF CONSTRUCTION NECESSARY AND PROPER FOR PERFORMING AND COMPLETING THE WORK. CONTRACTOR SHALL PERFORM AND COMPLETE THE WORK IN THE MANNER BEST CALCULATED TO PROMOTE SCHEDULED CONSTRUCTION CONSISTENT WITH SAFETY OF LIKE AND PROPERTY AND TO THE SATISFACTION OF THE OWNER, AND IN STRICT ACCORDANCE WITH THE CONTRACT DOCUMENTS. THE CONTRACTOR SHALL CLEAN UP THE WORK, MAINTAIN IT DURING CONSTRUCTION, AND PAY ALL COSTS INCIDENTAL THERETO. CONTRACTOR SHALL REPAIR OR RESTORE ALL STRUCTURES AND PROPERTY THAT MAY BE DAMAGED OR DISTURBED DURING PERFORMANCE OF THE WORK.
- 3.2. THE COST OF INCIDENTAL WORK DESCRIBED IN THESE GENERAL REQUIREMENTS, FOR WHICH THERE ARE NO SPECIFIC CONTRACT ITEMS, SHALL BE CONSIDERED AS A PART OF THE GENERAL COST OF DOING THE WORK AND SHALL BE INCLUDED IN THE PRICES FOR THE VARIOUS CONTRACT ITEMS. NO ADDITIONAL PAYMENT WILL BE MADE THEREFORE.
- 3.3. THE CONTRACTOR SHALL PROVIDE AND MAINTAIN SUCH MODERN PLANT, TOOLS, AND EQUIPMENT AS MAY BE NECESSARY IN THE OPINION OF THE ENGINEER TO PERFORM, IN A SATISFACTORY AND ACCEPTABLE MANNER ALL THE WORK REQUIRED BY THE OFFICE CONTRACT. ONLY EQUIPMENT OF ESTABLISHED REPUTATION AND PROVEN EFFICIENCY SHALL BE USED. THE CONTRACTOR SHALL BE SOLELY RESPONSIBLE FOR THE ADEQUACY OF WORKMANSHIP, MATERIALS AND EQUIPMENT, PRIOR APPROVAL OF THE ENGINEER NOTWITHSTANDING.
4. SHOP DRAWINGS, PRODUCT DATA AND SAMPLES:
- 4.1. SUBMIT FIVE (5) COPIES OF ALL REQUIRED SHOP DRAWINGS, PRODUCT DATA AND SAMPLES FOR ENGINEER'S REVIEW.
- 4.2. SHOP DRAWINGS, PRODUCT DATA, SAMPLES AND TRANSMITTAL LETTERS PERTAINING THERETO SHALL BE IDENTIFIED WITH THE TITLE OF THE PROJECT, SUBMISSION DATE, AND THE CONTRACTOR'S ACKNOWLEDGEMENT THAT HE HAS REVIEWED THEM AND FOUND THEM ACCEPTABLE.
- 4.3. NOTIFY ENGINEER IN WRITING, AT THE TIME OF SUBMITTAL, OF ANY DEVIATIONS IN THE SUBMITTALS FROM THE REQUIREMENTS OF THE CONTRACT DOCUMENTS.
- 4.4. THE REVIEW AND APPROVAL OF SHOP DRAWINGS, SAMPLES OR PRODUCT DATA BY THE ENGINEER SHALL NOT RELIEVE THE CONTRACTOR FROM HIS/HER RESPONSIBILITY WITH REGARD TO THE FULFILLMENT OF THE TERMS OF THE CONTRACT DOCUMENTS. ALL RISKS OF ERROR AND OMISSION ARE ASSUMED BY THE CONTRACTOR AND THE ENGINEER WILL HAVE NO RESPONSIBILITY THEREFORE.
5. THE LOCATION OF ALL EXISTING UTILITIES SHOWN IN THE PLANS ARE APPROXIMATE ONLY AND ARE BASED ON AS BUILT SURVEY INFORMATION. ADDITIONAL UTILITIES MAY EXIST WHICH ARE NOT SHOWN ON THESE PLANS. THE CONTRACTOR SHALL BE RESPONSIBLE FOR LOCATING AND VERIFYING ALL UTILITIES PRIOR TO BEGINNING CONSTRUCTION. ANY AND ALL KNOWN CONFLICTS WITH EXISTING UTILITIES SHALL BE REPORTED TO THE ENGINEER. THIS WORK BY THE CONTRACTOR SHALL BE CONSIDERED INCIDENTAL TO THE CONTRACT AND NO ADDITIONAL COMPENSATION SHALL BE ALLOWED. THE APPROPRIATE UTILITY COMPANY SHALL BE NOTIFIED IN ADVANCE OF ANY EXCAVATION INVOLVING THEIR UTILITIES SO THAT A COMPANY REPRESENTATIVE CAN BE PRESENT. THE CONTRACTOR SHALL BE RESPONSIBLE FOR VERIFYING UTILITY LOCATION PRIOR TO SUBMITTING SHOP DRAWINGS OF PRECAST COMPLEX STRUCTURES FOR APPROVAL.

UTILITY OWNERS:	CONTACT	TELEPHONE NO.
AT&T	GARTH BEDWARD	(561) 504-9263
COMCAST CABLEVISION	MIYA FISHER	(561) 598-9756
FLORIDA POWER & LIGHT (D)	JORGE SANCHEZ	(561) 616-1612
FLORIDA POWER & LIGHT (T)	TRICIA D'ANNUNZIO	(561) 904-3560
FLORIDA PUBLIC UTILITIES	DALE BUTCHER	(561) 602-3702
VILLAGE OF WELLINGTON	COREY ROBINSON	(561) 753-2464
PBC TRAFFIC OPS	DANNY RODRIGUEZ	(561) 533-3900

6. THE CONTRACTOR SHALL NOTIFY THE PROPER UTILITY COMPANY AT LEAST 48 HOURS IN ADVANCE OF ANY EXCAVATION NEAR OR AROUND THEIR FACILITY SO THAT A COMPANY REPRESENTATIVE CAN BE PRESENT.
7. THE CONTRACTOR IS TO USE EXTREME CAUTION WHEN WORKING IN OR AROUND AREAS OF OVERHEAD TRANSMISSION LINES AND UNDERGROUND UTILITIES.
8. THE CONTRACTOR IS TO PROTECT UNDERGROUND UTILITIES DURING CONSTRUCTION AT ALL TIMES.
9. FOR UTILITY ADJUSTMENT SYMBOLS, SEE FDOT STANDARD INDEX 002.
10. ANY PUBLIC LAND CORNER MONUMENT WITHIN THE LIMITS OF CONSTRUCTION IS TO BE PROTECTED. IF A CORNER MONUMENT IS IN DANGER OF BEING DESTROYED AND HAS NOT BEEN PROPERLY REFERENCED THE PROJECT ENGINEER SHALL NOTIFY THE COUNTY SURVEYOR WITHOUT DELAY BY TELEPHONE.
11. ALL ELEVATIONS ARE REFERENCED TO THE NAVD OF 1988 IN FEET.
12. TOPOGRAPHIC SURVEY PERFORMED FOR THIS PROJECT BY CAUFIELD & WHEELER, INC.
13. BENCHMARK ORIGIN DESCRIPTION: PALM BEACH COUNTY BENCHMARK "ACME" ELEVATION 17.43
14. ANY NGVD 29 MONUMENT WITHIN THE LIMITS OF CONSTRUCTION IS TO BE PROTECTED.
15. ALL EXISTING TREES & SHRUBS IN CONFLICT WITH PROPOSED PATHWAYS WITHIN R/W SHALL BE REMOVED.
16. NEATLY REMOVE OR PRUNE ALL EXIST. TREES, HEDGES AND OTHER VEGETATION (INCLUDING THOSE NOT SHOWN HEREON) AS NECESSARY TO PROVIDE MINIMUM CLEARANCES OF 1FT HORIZONTAL AND 10FT VERTICAL FROM THE PROPOSED PATH.
17. EXISTING DRAINAGE STRUCTURES AND PIPES WITHIN THE LIMITS OF CONSTRUCTION SHALL REMAIN UNLESS OTHERWISE NOTED.
18. ALL EXISTING PIPES THAT ARE TO REMAIN ARE TO BE CLEANED OUT (DESILTED) AS DIRECTED BY THE ENGINEER.
19. ALL STATIONS AND OFFSETS ARE FROM THE BASELINE OF CONSTRUCTION TO THE CENTERLINE OF THE PATHWAY UNLESS OTHERWISE NOTED.
20. RADII, DIMENSIONS AND ELEVATIONS ARE TO THE CENTERLINE OF THE PATHWAY UNLESS OTHERWISE NOTED.
21. PROPOSED GRADES SHOWN ARE FINISH GRADES.
22. THE CONTRACTOR SHALL BE RESPONSIBLE FOR PROTECTION OF EXISTING LANDSCAPING AND IRRIGATION SYSTEMS LOCATED ON PRIVATE PROPERTY. REPAIR OR REPLACEMENT OF SYSTEMS DAMAGED BY THE CONTRACTOR SHALL BE MADE AT THE EXPENSE OF THE CONTRACTOR.
23. THE CONTRACTOR AND OR HIS/HER SUBCONTRACTORS SHALL BE IN COMPLIANCE WITH CURRENT OSHA, STATE, COUNTY, AND LOCAL REGULATIONS, WHICH INCLUDE BUT ARE NOT LIMITED TO 54 CFR 45894 AND 29 CFR 1926.560 & 651 AND THE FLORIDA TRENCH SAFETY ACT.
24. CONTRACTOR SHALL OBTAIN A DEWATERING GENERAL USE PERMIT FROM THE SOUTH FLORIDA WATER MANAGEMENT DISTRICT PRIOR TO COMMENCING DEWATERING UNLESS THE WORK QUALIFIES FOR A 'NO-NOTICE' AUTHORIZATION AS DESCRIBED IN RULE 40E-20.302(3) OF THE FLORIDA ADMINISTRATIVE CODE AND APPROVED SET OF CONSTRUCTION PLANS AND CONTRACT DOCUMENTS SHALL BE MAINTAINED BY THE CONTRACTOR ON SITE AT ALL TIMES DURING CONSTRUCTION OPERATIONS.
25. SALVAGE MATERIAL
- 25.1. ALL SALVAGEABLE MATERIAL AND EQUIPMENT REMOVED FROM THE EXISTING CONSTRUCTION FOR WHICH SPECIFIC USE, RELOCATION OR OTHER DISPOSAL IS NOT SPECIFICALLY NOTED ON THE DRAWINGS OR OTHERWISE SPECIFIED, SHALL REMAIN THE PROPERTY OF THE OWNER AND SHALL BE TURNED OVER TO HIM/HER. ALL MATERIAL AND EQUIPMENT NOT IN SALVAGEABLE CONDITION AS DETERMINED BY THE ENGINEER, SHALL

... GENERAL NOTES CONTINUED

- BE DISPOSED OF BY THE CONTRACTOR IN A LEGAL MANNER AT THE CONTRACTOR'S EXPENSE. THE ACTUAL STORAGE SITE FOR SALVAGEABLE MATERIAL WILL BE DESIGNATED BY THE OWNER.
26. CLEANING
- 26.1. DURING THE CONSTRUCTION OF THE WORK, THE CONTRACTOR SHALL, AT ALL TIMES, KEEP THE SITE OF THE WORK AND ADJACENT PREMISES AS FREE FROM MATERIAL, DEBRIS AND RUBBISH AS IS PRACTICABLE AND SHALL REMOVE THE SAME FROM ANY PORTION OF THE SITE IF, IN THE OPINION OF THE ENGINEER, SUCH MATERIAL, DEBRIS, OR RUBBISH CONSTITUTES A NUISANCE OR IS OBJECTIONABLE.
- 26.2. AT THE CONCLUSION OF THE WORK, ALL TOOLS, TEMPORARY STRUCTURES AND MATERIALS BELONGING TO THE CONTRACTOR SHALL BE PROMPTLY TAKEN AWAY AND CONTRACTOR SHALL REMOVE AND PROMPTLY DISPOSE OF ALL RUBBISH OR ANY FOREIGN MATERIALS. THE CONTRACTOR SHALL THOROUGHLY CLEAN ALL MATERIAL INSTALLED AND SHALL DELIVER SUCH MATERIALS UNDAMAGED IN A CLEAN AND NEW CONDITION.
27. ALL PAVEMENT STRIPING SHALL BE THERMOPLASTIC.
28. ALL AREAS DISTURBED BY CONSTRUCTION SHALL BE RESTORED TO ORIGINAL CONDITION.
29. CONTRACTOR SHALL REPAIR ALL IRRIGATION DAMAGED DURING CONSTRUCTION. CONTRACTOR SHALL BE RESPONSIBLE FOR OBTAINING AND KEEPING ONSITE ALL REQUIRED PERMITS.
30. ALL PEDESTRIAN ROUTES SHALL MEET THE REQUIREMENTS OF THE AMERICANS WITH DISABILITIES ACT. CROSS SLOPES SHALL NOT EXCEED 2% AND LONGITUDINAL SLOPES SHALL NOT EXCEED 5%.
31. ALL UTILITY CONFLICTS ENCOUNTERED SHALL BE COORDINATED WITH ENGINEER, ITD AND APPROPRIATE UTILITY COMPANY.
32. ALL DISTURBED AREAS SHALL BE RE-SODDED. BAHIA SOD TO BE USED IN UN-IRRIGATED AREAS UNLESS OTHERWISE NOTED.
33. CURB RAMPS SHALL BE PER INDEX 304 FOR THE FDOT DESIGN STANDARDS.
34. ATTENTION TO THE FACT THAT THE MAJORITY OF THE WORK WILL BE PERFORMED UNDER EXISTING OVERHEAD POWER LINES SHOULD BE NOTED.
35. CONTRACTOR TO BACKFILL ALL EXCAVATIONS AT THE END OF EACH SHIFT TO MEET DROP-OFF CRITERIA IN ACCORDANCE WITH 4:1 TRANSITION DETAIL IN FDOT INDEX 102-600 SHEET 9 OF 12.
36. WORK ONLY ALLOWED FROM 7AM TO 5PM MONDAY TO INCLUDING FRIDAY. NO WORK ON WELLINGTON AND STATE OBSERVED HOLIDAYS.
37. ALL STEEL OR IRON INCORPORATED INTO THE PROJECT SHALL MEET THE BUY AMERICA PROVISION 23 CFR 635.41.
38. CONTRACTOR SHALL MEET OSHA REQUIREMENTS WHEN WORKING NEAR POWER LINES.
39. FLYING COW RD WILL BE MAINTAINED OPERATIONAL AT ALL TIMES.

PAVING

1. IMMEDIATELY CEASE TRANSPORTATION OF ASPHALT MIXTURES FROM THE PLANT WHEN RAIN BEGINS AT THE ROADWAY. DO NOT PLACE ASPHALT MIXTURES WHILE RAIN IS FALLING, OR WHEN THERE IS WATER ON THE SURFACE TO BE COVERED.
2. PRODUCE A FINISHED SURFACE OF UNIFORM TEXTURE AND COMPACTION WITH NO PULLED, TORN, OR LOOSENED PORTIONS AND FREE OF SEGREGATION, AND STREAKS, SAND SPOTS, OR RIPPLES.

CONTAMINATION

UNIDENTIFIED AREAS OF CONTAMINATION

WHEN ENCOUNTERING OR EXPOSING ANY ABNORMAL CONDITION INDICATING THE PRESENCE OF A HAZARDOUS OR TOXIC WASTE, OR CONTAMINANTS, CEASE OPERATIONS IMMEDIATELY IN THE VICINITY AND NOTIFY THE LAP VILLAGE OF WELLINGTON ENGINEER. THE PRESENCE OF TANKS OR BARRELS; DISCOLORED EARTH, METAL, WOOD, GROUND WATER, ETC.; VISIBLE FUMES; ABNORMAL ODORS; EXCESSIVELY HOT EARTH; SMOKE; OR OTHER CONDITIONS THAT APPEAR ABNORMAL MAY INDICATE HAZARDOUS OR TOXIC WASTES OR CONTAMINANTS AND MUST BE TREATED WITH EXTREME CAUTION.

MAKE EVERY EFFORT TO MINIMIZE THE SPREAD OF CONTAMINATION INTO UNCONTAMINATED AREAS. IMMEDIATELY PROVIDE FOR THE HEALTH AND SAFETY OF ALL WORKERS AT THE JOB SITE AND MAKE PROVISIONS NECESSARY FOR THE HEALTH AND SAFETY OF THE PUBLIC THAT MAY BE EXPOSED TO ANY POTENTIALLY HAZARDOUS CONDITIONS. PROVISIONS SHALL MEET ALL APPLICABLE LOCAL, STATE, AND FEDERAL LAWS, RULES, REGULATIONS OR CODES COVERING HAZARDOUS CONDITIONS AND WILL BE IN A MANNER COMMENSURATE WITH THE GRAVITY OF THE CONDITIONS.

THE LAP VILLAGE OF WELLINGTON ENGINEER AND/OR CONTRACTOR WILL COORDINATE AND MOBILIZE A QUALIFIED CONTAMINATION ASSESSMENT/REMEDATION (CAR) CONTRACTOR. QUALIFICATIONS OF SUCH CAR CONTRACTOR SHALL INCLUDE, BUT NOT BE LIMITED TO: EXPERIENCE AND PERSONNEL TO PREPARE CONTAMINATION ASSESSMENT PLANS, CONDUCT CONTAMINATION ASSESSMENTS, PREPARE SITE ASSESSMENT REPORTS, REMEDIATION PLANS, IMPLEMENT REMEDIAL ACTION PLANS, RISK BASED CORRECTIVE ACTIONS, STORAGE TANKS SYSTEM REMOVAL, HIGHWAY SPILL RESPONSE AS WELL AS EXPERIENCE WITH INFRASTRUCTURE/CONSTRUCTION ACTIVITIES WITHIN (POTENTIALLY) CONTAMINATED AREAS SPECIFIC TO TRANSPORTATION SYSTEMS.

ALL THE WORK PERFORMED BY THE CAR CONTRACTOR SHALL BE PERFORMED IN COMPLIANCE WITH ALL APPLICABLE LOCAL, STATE AND FEDERAL REGULATIONS GOVERNING WORKER SAFETY AND ENVIRONMENTAL REGULATIONS. THIS IS TO INCLUDE OCCUPATIONAL EXPOSURE TO CONTAMINATED SOILS, GROUNDWATER, WASTES AND ATMOSPHERE DURING THE CONSTRUCTION OF ALL FEATURES INCLUDED IN THE CONSTRUCTION PLANS. IN ADDITION, THE CAR CONTRACTOR MUST BE STAFFED WITH FLORIDA LICENSED TECHNICAL PROFESSIONALS (GEOLOGISTS AND ENGINEERS) WHO WILL BE INVOLVED WITH THE PROJECT AND KNOWLEDGEABLE OF THE WORK ACTIVITIES CONDUCTED WITHIN THE IDENTIFIED CONTAMINATED AREAS AND WHO WOULD SIGN AND SEAL PROJECT REPORTS AS REQUIRED FOR SUBMITTAL TO THE APPROPRIATE ENVIRONMENTAL REGULATORY AGENCIES.

THE LAP VILLAGE OF WELLINGTON ENGINEER WILL IMMEDIATELY NOTIFY THE FLORIDA DEPARTMENT OF TRANSPORTATION (FDOT) DISTRICT IV CONTAMINATION IMPACT COORDINATOR (DCIC) AT (954) 777-4286 AFTER ENCOUNTERING THE UNIDENTIFIED AREAS OF CONTAMINATION. PRELIMINARY INVESTIGATION BY THE CAR CONTRACTOR WILL DETERMINE THE COURSE OF ACTION NECESSARY FOR SITE SECURITY AND THE STEPS NECESSARY UNDER APPLICABLE LAWS, RULES, AND REGULATIONS FOR ADDITIONAL ASSESSMENT AND/OR REMEDIATION WORK TO RESOLVE THE CONTAMINATION ISSUE.

FOLLOWING COMPLETION OF THE PROJECT, THE CAR CONTRACTOR SHALL BE REQUIRED TO PROVIDE COPIES OF ALL REPORTS SUBMITTED TO REGULATORY AGENCIES, WASTE MATERIAL PROFILES, MANIFESTS AND/OR DISPOSAL RECEIPTS FOR THE HANDLING OF ALL CONTAMINATED MEDIA INCLUDING BUT NOT LIMITED TO GROUND WATER, WASTE WATER, SOILS, SOLID WASTES, SLUDGE, HAZARDOUS WASTES, AIR MONITORING RECORDS AND SAMPLE RESULTS FOR ALL MATERIALS TESTED AND ANALYZED TO THE LAP VILLAGE OF WELLINGTON ENGINEER AND THE FDOT DCIC.

LEGEND

PROPOSED:

ASPHALT PAVEMENT

APPROACH SLAB

FINISHED GRADE ELEVATION

TRAFFIC SIGN

DRAINAGE FLOW ARROW

THREE RAIL WOOD FENCE

GUARDRAIL

DETECTABLE WARNING AT CURB RAMP

EXISTING:

MEASURED ELEVATION

SANITARY MANHOLE

DRAINAGE MANHOLE

CLEANOUT

FIRE HYDRANT

FENCE

GATE VALVE

WATER METER

CATCH BASIN

STREET LIGHT

TREE

INFORMATION SIGN

GUY WIRE

MAILBOX

ELECTRIC BOX

UTILITY POLE

BURIED ELECTRIC

BURIED TELEPHONE

OVERHEAD ELECTRIC

OVERHEAD TELEPHONE

STORM PIPE

GUARDRAIL

ABBREVIATIONS

ELEV	ELEVATION
INV	INVERT
EXIST	EXISTING
TYP	TYPICAL
FT	FEET
LF	LINEAR FEET
N,S,E,W	NORTH, SOUTH, EAST, WEST
R/W	RIGHT OF WAY
ORB	OFFICIAL RECORD BOOK
RCP	REINFORCED CONCRETE PIPE
PB	PLAT BOOK
WM	WATERMAIN
UE	UTILITY EASEMENT
AE	ACCESS EASEMENT
DE	DRAINAGE EASEMENT
CL	CENTERLINE
PL	PROPERTY LINE
CAP	CORRUGATED ALUMINUM PIPE
PVC	POLYVINYL CHLORIDE
OD	OUTSIDE DIAMETER
OS	OFFSET
CY	CUBIC YARD
IN	INCH
LT	LEFT
RT	RIGHT
SF	SQUARE FEET
TOP	TOP OF PIPE
AC	ACRE
PC	POINT OF CURVATURE
PT	POINT OF TANGENCY
PI	POINT OF INTERSECTION
SY	SQUARE YARD
HDPE	HIGH DENSITY POLYETHYLENE
CMP	CORRUGATED METAL PIPE
TMB	TEMPORARY BENCHMARK
FES	FLARED END SECTION
C.W.E.	CONTROLLED WATER ELEVATION

ENVIRONMENTAL

1. PER CHAPTER 62-770, F.A.C., IF ANY HAZARDOUS MATERIAL IS FOUND ON THE PROJECT SITE, IT SHALL BE IMMEDIATELY REPORTED TO THE PROJECT MANAGER OR ENGINEER. THE APPROPRIATE REGULATORY AUTHORITY WILL BE CONTACTED IMMEDIATELY ALONG WITH IMMEDIATE RESTRICTED ACCESS TO THE PROJECT SITE. THE CONTRACTOR WILL THEN FOLLOW ORDERS GIVEN BY THE AUTHORITY IN AN INVESTIGATION AND/OR REMOVAL OF THE MATERIAL. THE CONTRACTOR IS RESTRICTED FROM RETURNING TO THE PROJECT SITE UNLESS AUTHORIZED TO DO SO.
2. THE CONTRACTOR IS NOT PERMITTED TO TRANSPORT ANY HAZARDOUS MATERIAL ONTO THE PROJECT SITE AT ANYTIME UNLESS AUTHORIZED TO DO SO. IF THE CONTRACTOR WISHES TO TRANSPORT MATERIALS ONSITE TO PERFORM THE CONTRACTED WORK, THE CONTRACTOR MUST GET PERMISSION IN WRITING FROM THE PROJECT ENGINEER. THE CONTRACTOR WILL THEN PROVIDE A COPY OF THE MATERIAL SAFETY DATA SHEETS (MSDS) FOR EACH HAZARDOUS MATERIAL NEEDED TO CONTINUE THE PROPOSED WORK. A DESCRIPTION OF THE REASON OF USE MUST BE GIVEN ALONG WITH THE MSDS TO THE PROJECT ENGINEER WITH THE VILLAGE OF WELLINGTON BEFORE ISSUING A WRITTEN APPROVAL TO THE CONTRACTOR. STATE LAW DOES NOT CONSIDER PETROLEUM PRODUCTS THAT ARE PROPERLY CONTAINERIZED AS A HAZARDOUS MATERIALS. THEREFORE, THESE PRODUCTS DO NOT REQUIRE A MSDS SUBMITTAL. ALL BULK PETROLEUM PRODUCTS STORED ON SITE SHALL REQUIRE PROPER STORAGE AREAS WITH SECONDARY CONTAINMENT.
3. "THE CONTRACTOR SHALL COORDINATE SELECTION AND REVIEW OF ANY PROPOSED STAGING AREAS ASSOCIATED WITH THIS PROJECT WITH JONATHAN REINSVOLD, P.E. 561-791-4052 AT THE VILLAGE OF WELLINGTON. NO STAGING OF EQUIPMENT/VEHICLES WILL BE ALLOWED IN OR NEAR THE SFWMD STORMWATER MANAGEMENT AREAS AND THE WELLINGTON ENVIRONMENTAL PRESERVE"



NAVD88 + 1.437' = NGVD29

2035 Vista Parkway West Palm Beach, FL 33411 Phone No. 561.687.2920 Fax No. 561.687.1110 Cert No. 6091 - LB No. 7055	
WGI	
REVISIONS	BY
DESCRIPTION	
NO.	DATE
CAD 206903 BPP CIVIL PLANS.DWG	
JOB NO. 2069.03	SCC
TOTAL SHEETS 9	DESIGNED SCC
DATE 8/1/17	CHECKED TM
SCALE 1" = 50'	OC BNO
ENGINEER OF RECORD THOMAS MUELLER, PE PE# 58119	
PROJECT: BINKS POINT PATHWAY FM# 438306-1-58-01	TASK: GENERAL NOTES AND LEGENDS
SHEET: C3	

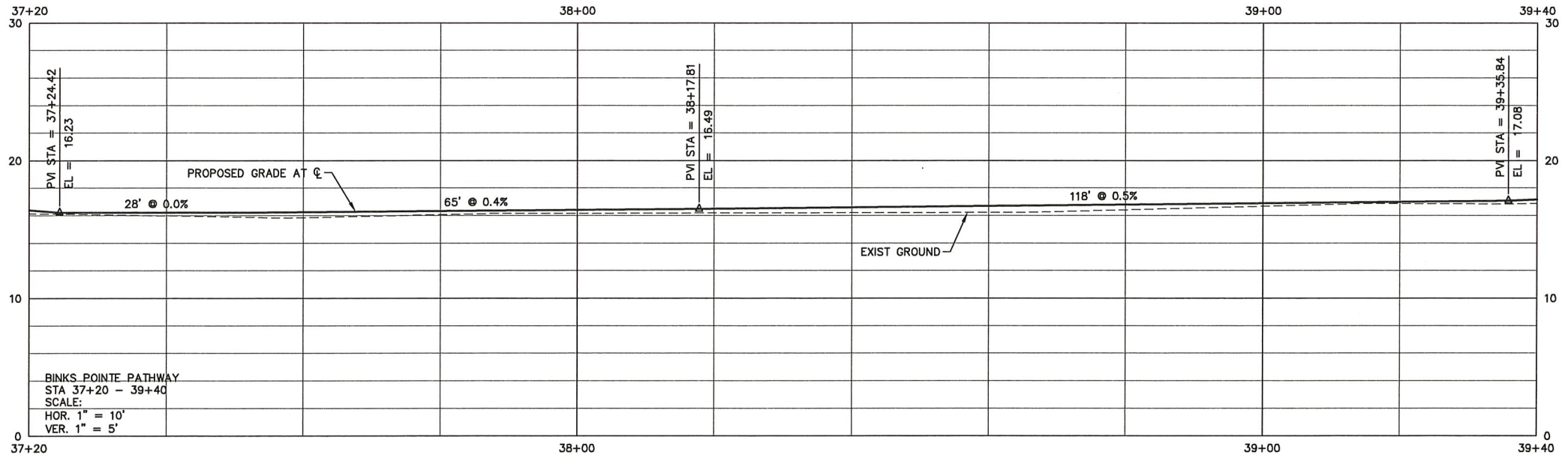
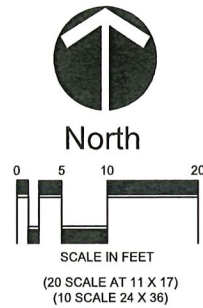
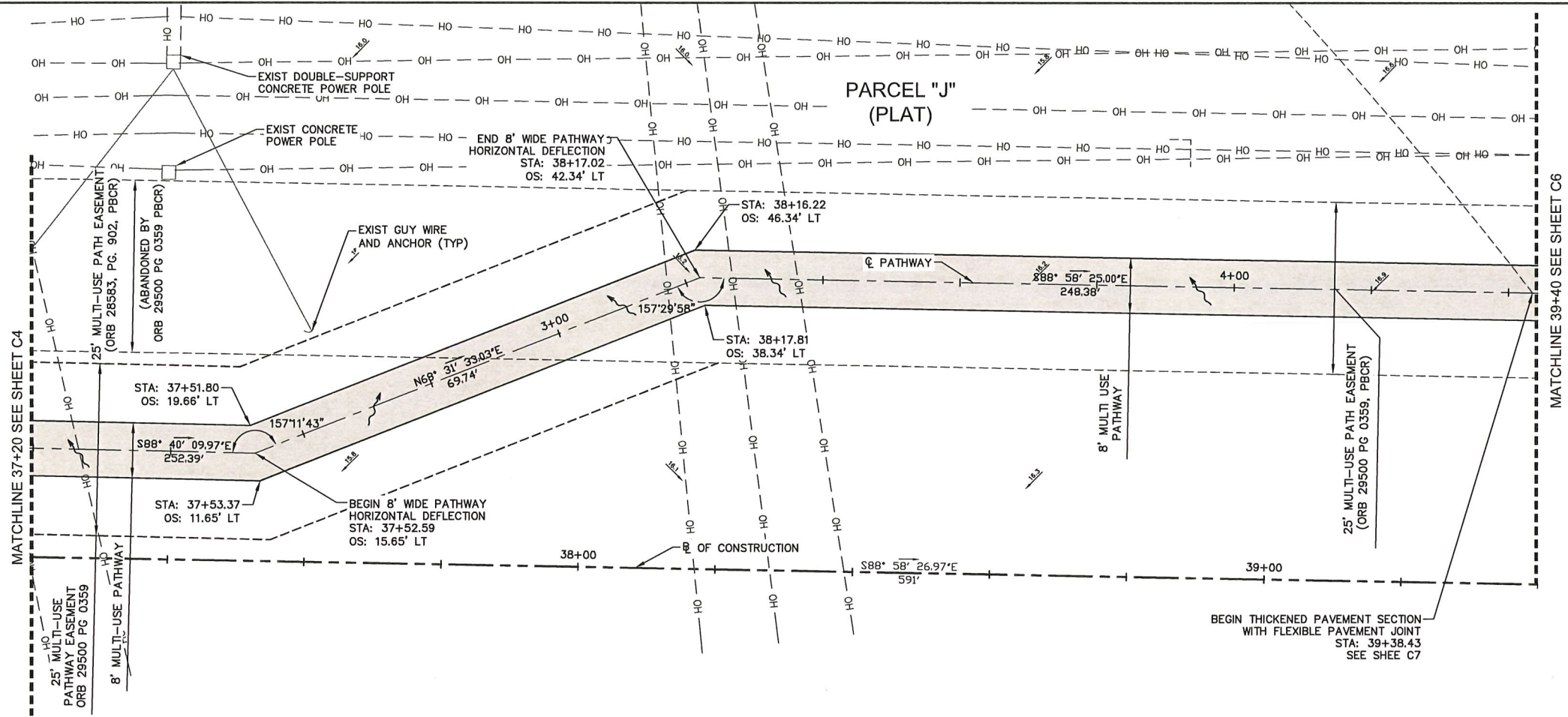

NAVD88 + 1.437' = NGVD29

WGI

2035 Vista Parkway
West Palm Beach, FL 33411
Phone No. 561.687.2220
Fax No. 561.687.1110
Cert No. 6091 - LB No. 7055

REVISIONS		BY	
NO.	DATE	DESCRIPTION	

<p>CAD 206903 BPP CIVIL PLANS.DWG</p> <p>JOB NO. 2069.03</p> <p>TOTAL SHEETS 9</p> <p>DATE 8/1/17</p> <p>SCALE 1" = 10'</p>	DRAWN	SCC	DESIGNED	SCC	CHECKED	TM	BNO

ENGINEER OF RECORD
THOMAS MUELLER, PE
PE# 58119

PROJECT: BINKS POINT PATHWAY
FM# 438306-1-58-01

TASK: PLAN AND PROFILE

SHEET: **C5**

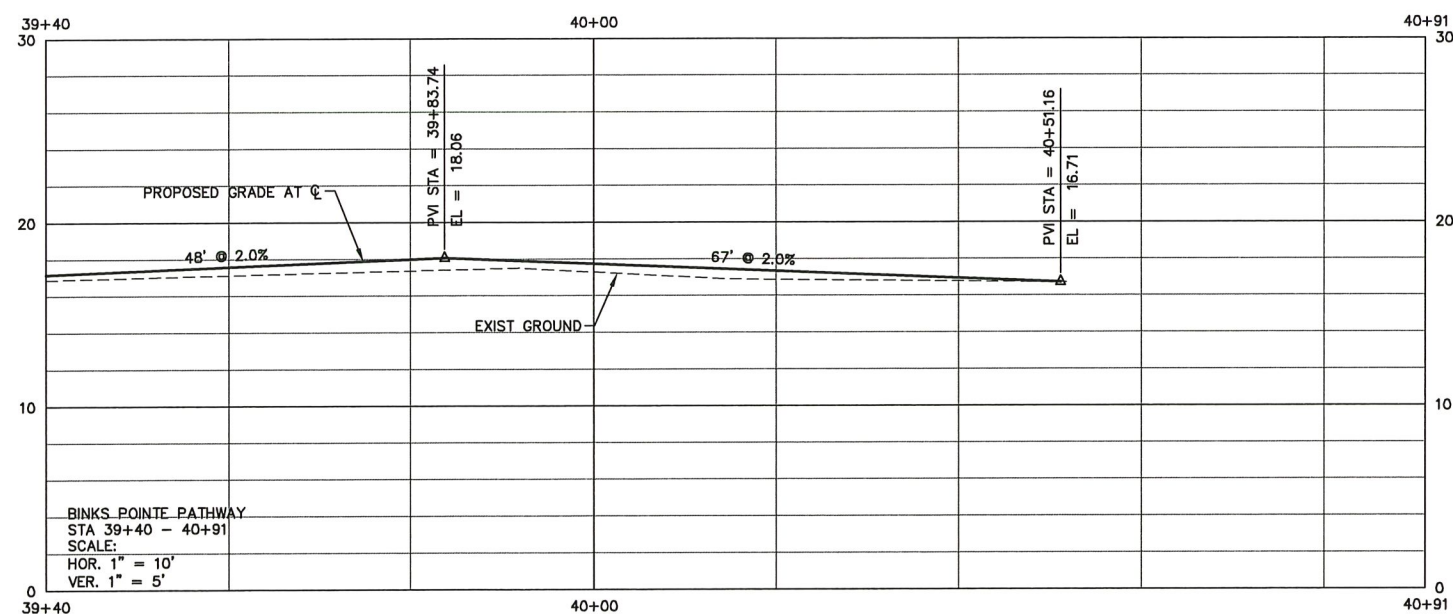
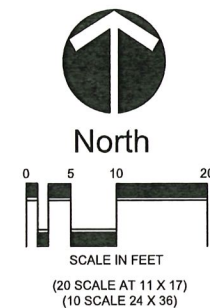
$$\text{NAVD88} + 1.437' = \text{NGVD29}$$
[illegible]

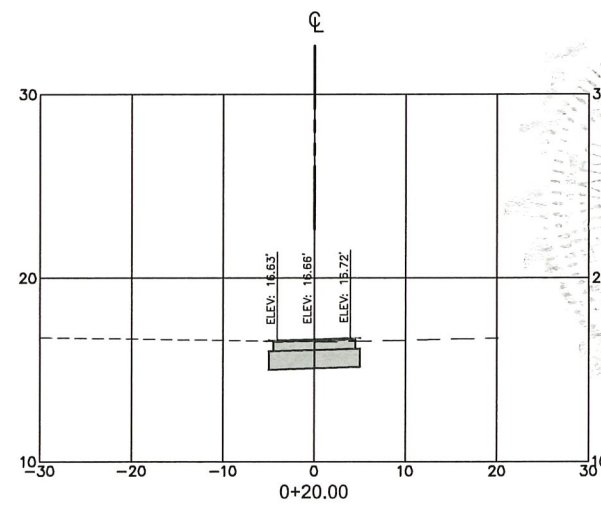
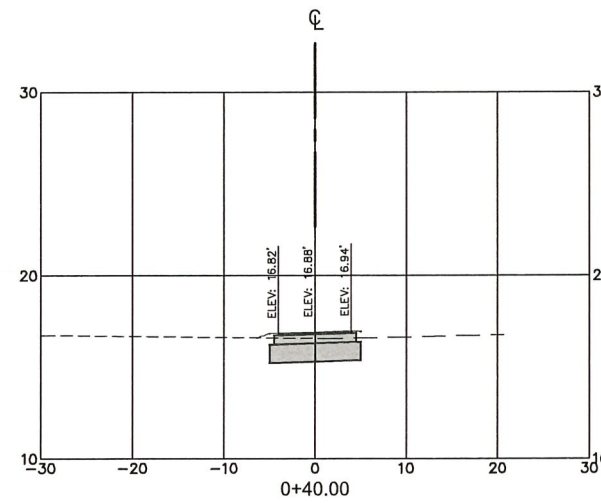
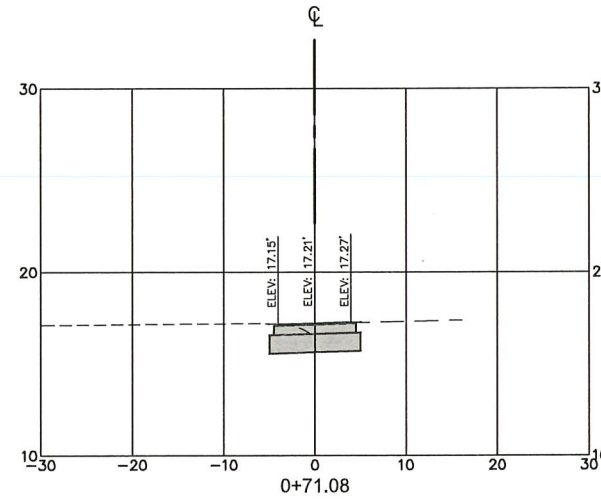
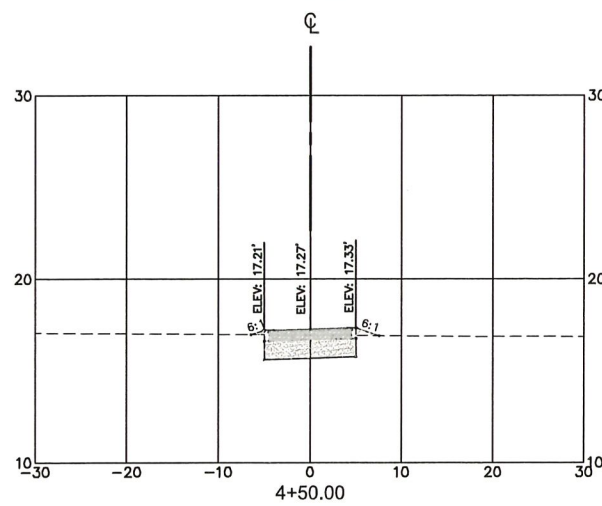
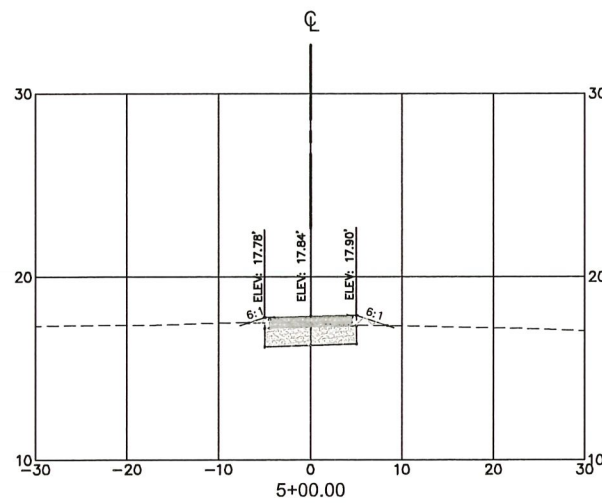
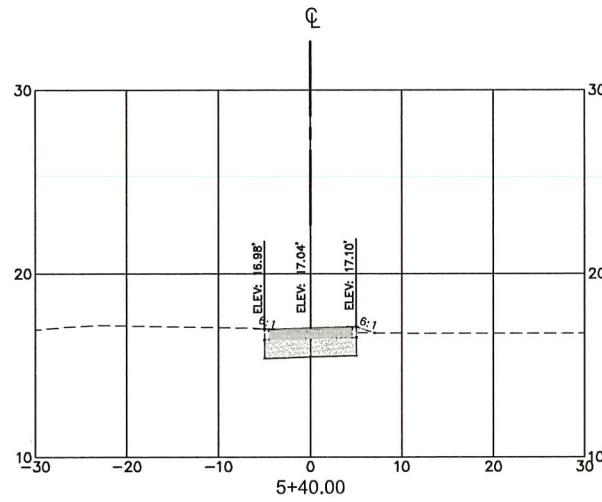
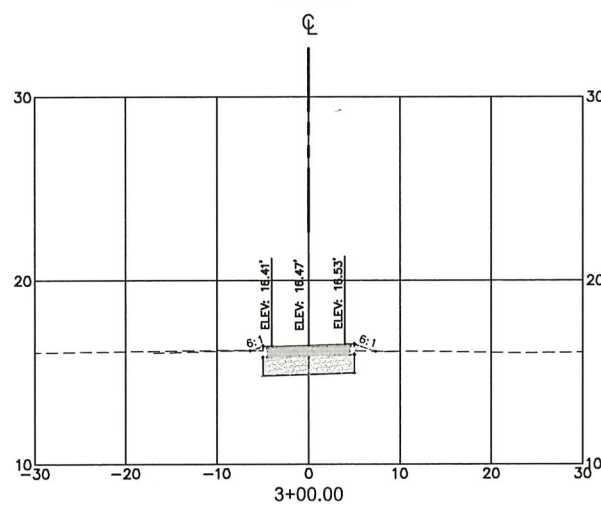
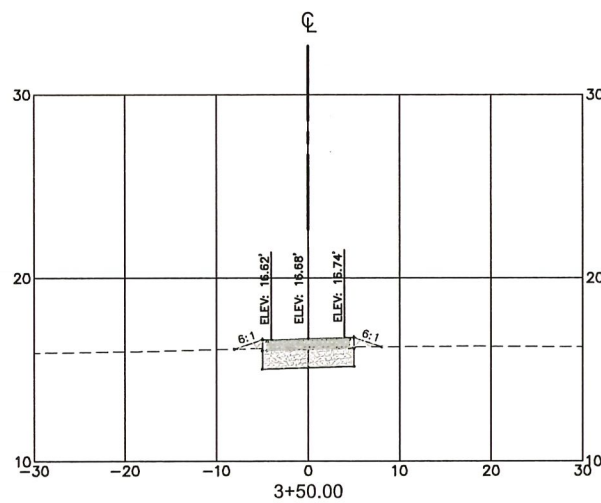
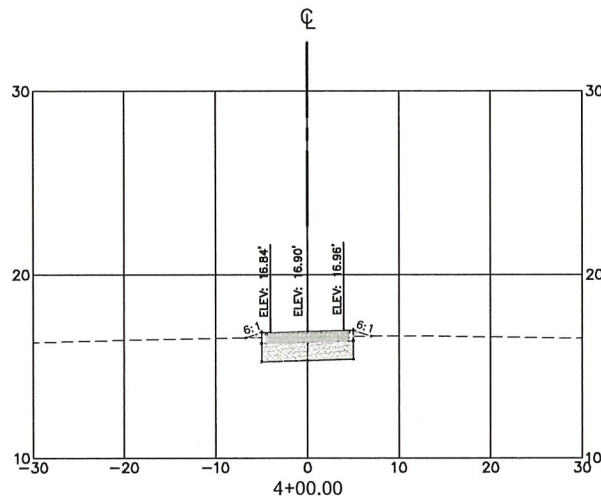
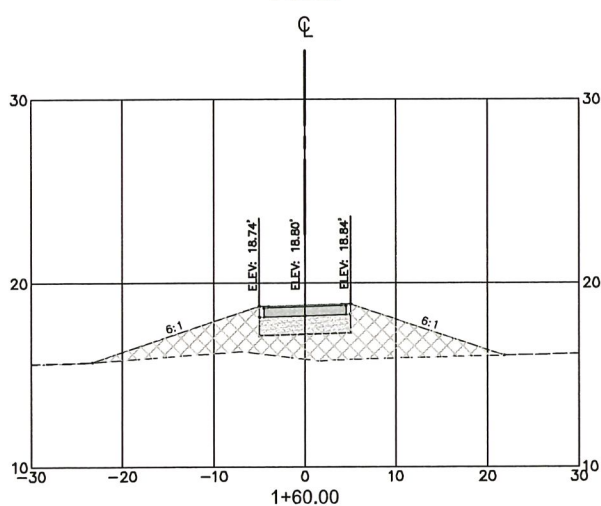
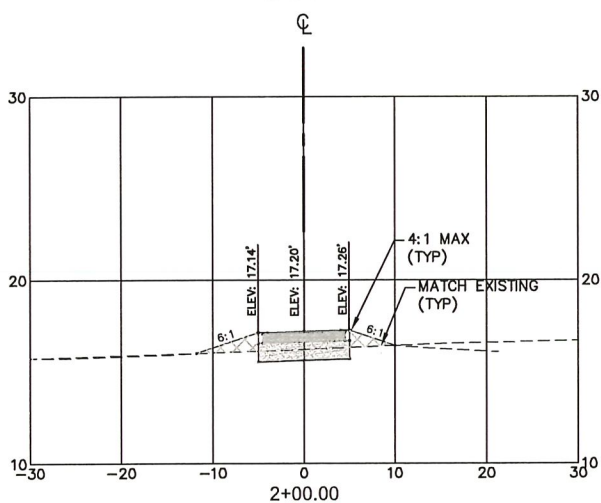
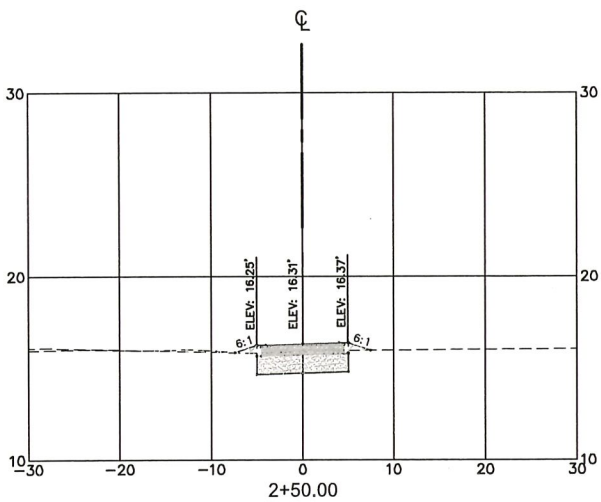

811
Know what's below.
Call before you dig.

2005 Vista Parkway
Westborough, MA 01581
Phone No. 561.687.2920
Fax No. 561.687.1110
Cert. No. 6091 - LB No. 7055

REVISIONS		BY	
NO.	DATE	DESCRIPTION	

CAD 206903 BPP CIVIL PLANS.DWG	DRAWN	SCC	DESIGNED	SCC	CHECKED	TM	QC	BNO
	JOB NO. 2069.03	TOTAL SHEETS 9						

ENGINEER OF RECORD
 THOMAS MUELLER, PE
 PE# 58119

PROJECT:
 BINKS POINT PATHWAY
 FM# 438306-1-58-01

TASK:
 GRADING SECTIONS
 EAST OF CANAL

SHEET:
 C8

Stephen Cherry C:\university\p\university\4077713\200903 BPP CIVIL PLANS.dwg 11x17 size Printed: 8/1/2018 7:46:03 AM

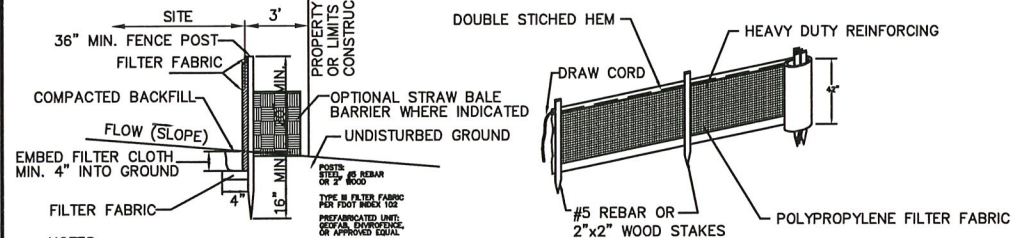
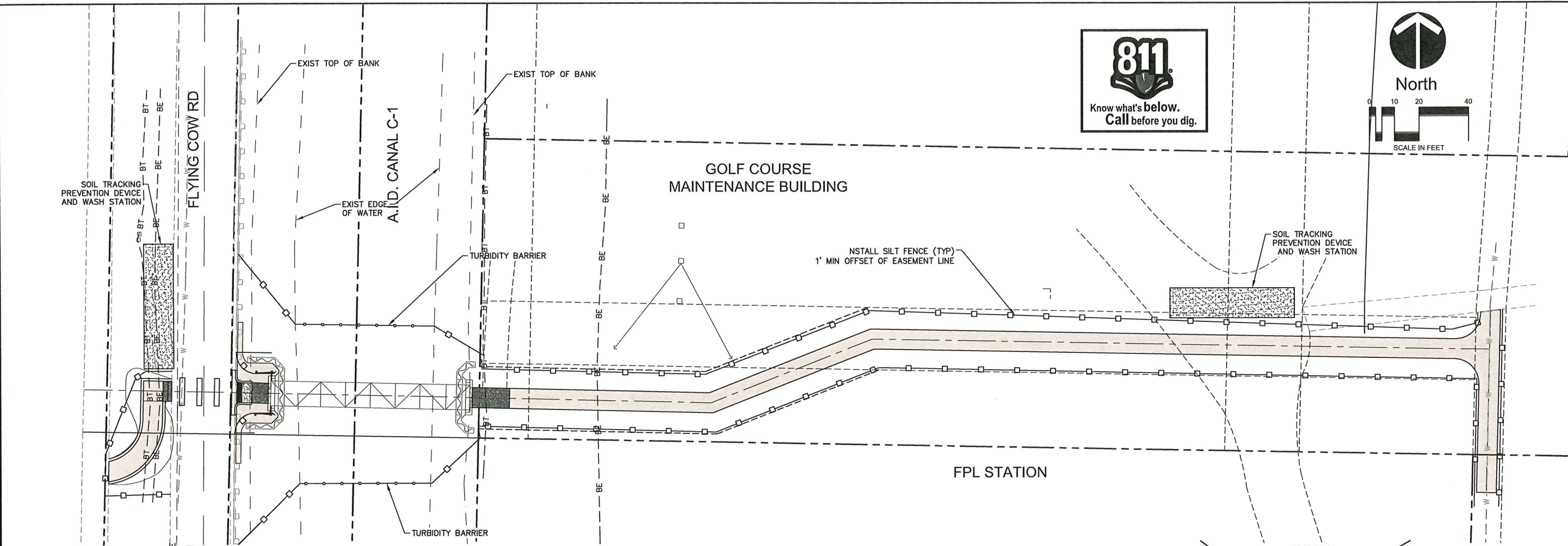
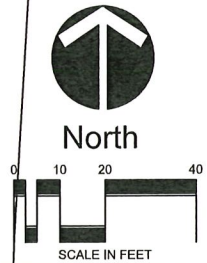

- NOTES:
1. FILTER FABRIC FENCE TO BE FASTENED SECURELY TO FENCE POSTS WITH WIRE TIES OR STAPLES SPACED EVERY 24" AT TOP AND BOTTOM.
 2. WHEN TWO SECTIONS OF FILTER CLOTH ADJOIN EACH OTHER, THEY SHALL BE OVERLAPPED BY SIX INCHES AND FOLDED.
 3. MAINTENANCE SHALL BE PERFORMED AS NEEDED AND MATERIAL REMOVED WHEN "BULGES" DEVELOP IN THE SILT FENCE OR DEPTH OF ACCUMULATED SEDIMENT REACHES 6 INCHES.
 4. SILT FENCE SHALL BE INSTALLED PER MANUFACTURES SPECIFICATIONS PRIOR TO THE START OF CONSTRUCTION AND SHALL NOT BE REMOVED UNTIL CONSTRUCTION IS COMPLETE.
 5. THE CONTRACTOR SHALL INSPECT AND REPAIR THE SILT FENCE AFTER EACH RAIN EVENT AND REMOVE SEDIMENT WHEN NECESSARY.
 6. REMOVED SEDIMENT SHALL BE DEPOSITED IN A AREA THAT WILL NOT CONTRIBUTE SEDIMENT OFFSITE AND CAN BE PERMANENTLY STABILIZED.
 7. THE SILT FENCE SHALL BE PLACED ON SLOPE CONTOUR TO MAXIMIZE ITS PONDING EFFICIENCY.
 8. IF DITCH LEVEL IS DEEPER THAN 30", THEN A FLOATING SILT SCREEN SHALL BE USED.

SILT FENCE INSTALLATION

SCALE: NONE

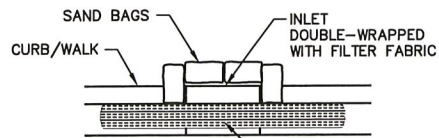

- NOTES:
1. CURB INLET SOCK SHALL NOT BE ABOVE THE SIDEWALK IF OPEN TO PEDESTRIANS.

CURB INLET PROTECTION

SCALE: NONE

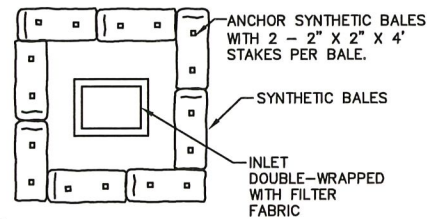

- NOTES:
1. BALES SHALL BE USED AROUND ALL INLETS UNTIL ROAD BASE AND CURBS ARE COMPLETE.
 2. BALES SHALL REMAIN AROUND DITCH INLETS UNTIL FINAL STABILIZATION.

DITCH/PAVEMENT INLET PROTECTION

SCALE: NONE

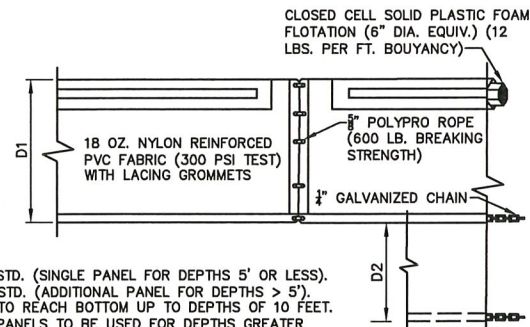

D1 = 5' STD. (SINGLE PANEL FOR DEPTHS 5' OR LESS).
D2 = 5' STD. (ADDITIONAL PANEL FOR DEPTHS > 5').
CURTAIN TO REACH BOTTOM UP TO DEPTHS OF 10 FEET.
TWO (2) PANELS TO BE USED FOR DEPTHS GREATER THAN 10 FEET UNLESS SPECIAL DEPTH CURTAINS SPECIFICALLY CALL FOR IN THE PLANS OR AS DETERMINED BY THE ENGINEER.

- NOTES:
1. TURBIDITY BARRIERS ARE TO BE USED IN ALL PERMANENT BODIES OF WATER REGARDLESS OF WATER DEPTH.
 2. NUMBER AND SPACING OF ANCHORS DEPENDANT ON CURRENT VELOCITIES.
 3. DEPLOYMENT OF BARRIER AROUND PILE LOCATIONS MAY VARY TO ACCOMMODATE CONSTRUCTION OPERATIONS.
 4. NAVIGATION MAY REQUIRE SEGMENTING BARRIER DURING CONSTRUCTION OPERATIONS.
 5. FOR ADDITIONAL INFORMATION SEE SECTION 104 OF THE STANDARD SPECIFICATIONS.
 6. FOR ADDITIONAL DETAILS SEE FDOT INDEX NO. 103.

FLOATING TURBIDITY BARRIER

N.T.S.

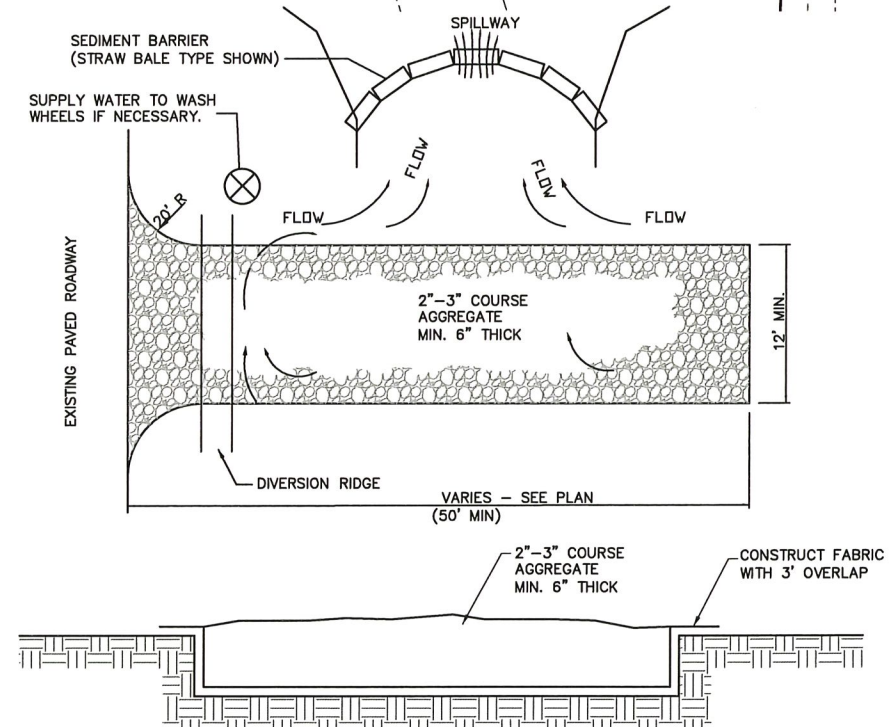

NOTES:

1. THE ENTRANCE SHALL BE MAINTAINED IN A CONDITION THAT WILL PREVENT TRACKING OR FLOWING OF SEDIMENT ONTO PUBLIC RIGHTS-OF-WAY. THIS MAY REQUIRE TOP DRESSING, REPAIR AND/OR CLEANOUT OF ANY MEASURES USED TO TRAP SEDIMENT.
2. WHEN NECESSARY, WHEELS SHALL BE CLEANED PRIOR TO ENTRANCE ONTO PUBLIC RIGHT-OF-WAY.
3. WHEN WASHING IS REQUIRED, IT SHALL BE DONE ON AN AREA STABILIZED WITH CRUSHED STONE THAT DRAINS INTO AN APPROVED SEDIMENT TRAP OR SEDIMENT BASIN.

SOIL TRACKING PREVENTION DEVICE

SCALE: NONE

2005 Vista Parkway West Palm Beach, FL 33411 Phone No. 561.687.2920 Fax No. 561.687.1110 TVA Cert. No. 6091 - LJB No. 7055		WGI		BY	
206903 BPP CIVIL PLANS.DWG		NO.		DATE	
JOB NO. 2069.03		DRAWN		SCC	
TOTAL SHEETS 9		DESIGNED		SCC	
DATE 8/1/17		CHECKED		TM	
SCALE 1" = 20'		QC		BNO	
ENGINEER OF RECORD THOMAS MUELLER, PE PE# 58119		PROJECT		BINKS POINT PATHWAY FM# 438306-1-58-01	
SHEET: C9		TASK		STORMWATER POLLUTION PREVENTION PLAN	

NAVD88 + 1.437' = NGVD29



NORTH



30 15 0 30

GRAPHIC SCALE IN FEET

Drawn: 4/19/2018 by: J. Worline, P.E. 65906
Checked: 4/19/2018 by: J. Worline, P.E. 65906
Title: ENLARGED PREFABRICATED PEDESTRIAN BRIDGE PLAN
Scale: 1"=40'-0"

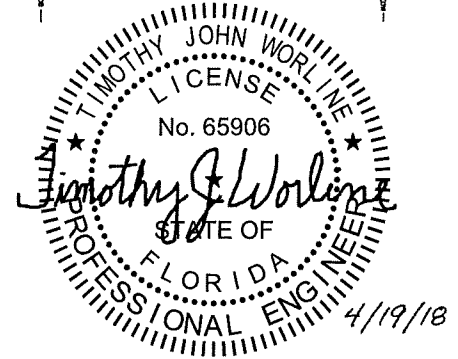
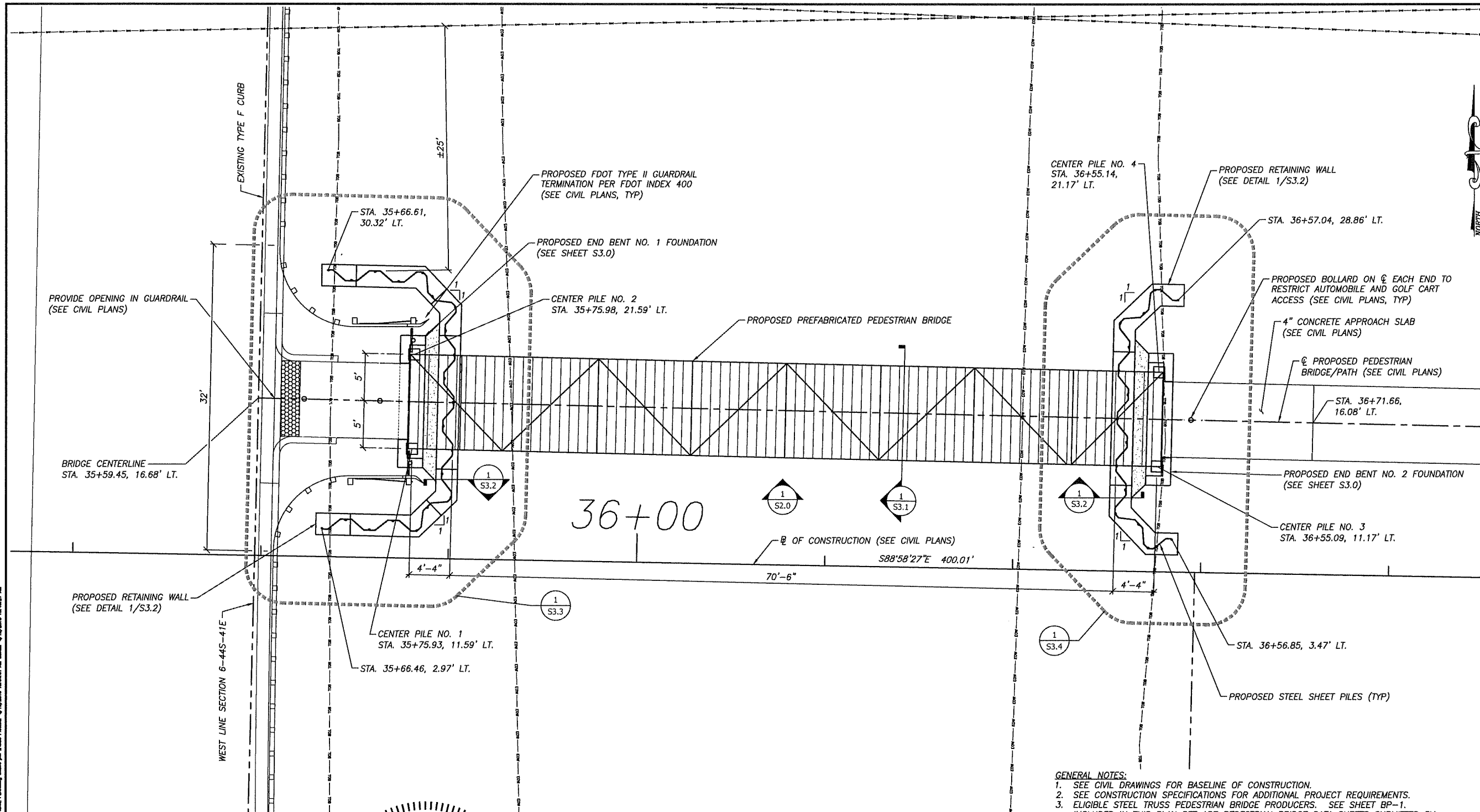

ENLARGED PREFABRICATED PEDESTRIAN BRIDGE PLAN

5 2.5 0 5
GRAPHIC SCALE IN FEET

- GENERAL NOTES:
1. SEE CIVIL DRAWINGS FOR BASELINE OF CONSTRUCTION.
 2. SEE CONSTRUCTION SPECIFICATIONS FOR ADDITIONAL PROJECT REQUIREMENTS.
 3. ELIGIBLE STEEL TRUSS PEDESTRIAN BRIDGE PRODUCERS. SEE SHEET BP-1. INCLUDED IN THIS PLAN SET ARE PEDESTRIAN BRIDGE DATA SHEETS SUBMITTED BY BRIDGE PRODUCERS ELIGIBLE TO PARTICIPATE IN THIS PROJECT. PRODUCERS WHO FAILED TO SUBMIT A DATA SHEET ARE EXCLUDED FROM PARTICIPATION. NO COST SAVINGS INITIATIVE PROPOSAL WILL BE ACCEPTED FOR THE TRUSS SUPERSTRUCTURE PORTION OF THE PROJECT. CONTACT INFORMATION FOR THE ELIGIBLE PRODUCERS IS INCLUDED IN THE DATA SHEET.
 4. SHOP DRAWING SUBMITTAL PRIOR TO FABRICATION THE CONTRACTOR'S EOR MUST SUBMIT SIGNED AND SEALED SUPERSTRUCTURE SHOP DRAWINGS, TECHNICAL SPECIFICATIONS AND DESIGN CALCULATIONS TO THE ENGINEER FOR REVIEW AND APPROVAL.
 5. PREFABRICATED STEEL TRUSS PEDESTRIAN BRIDGE SPAN PREFABRICATED STEEL TRUSS PEDESTRIAN BRIDGE SPAN WILL BE PAID FOR AT THE CONTRACT UNIT PRICE PER SQUARE FOOT OF DECK AREA UNDER PAY ITEM NO. 460-7 PREFABRICATED STEEL TRUSS PEDESTRIAN BRIDGE, SF. THIS PAY ITEM INCLUDES FURNISHING AND INSTALLING THE PREFABRICATED STEEL TRUSS PEDESTRIAN BRIDGE SUPERSTRUCTURE INCLUDING STEEL TRUSSES, FLOOR SYSTEM, DECK, BEARING ASSEMBLIES, DECK JOINTS AND BRIDGE RAILING/FENCING. PAYMENT FOR THIS PAY ITEM IS BASED ON THE PLAN QUANTITY. PORTIONS OF PEDESTRIAN BRIDGE OUTSIDE THE LIMITS OF THE STEEL TRUSS SPAN ARE PAID FOR UNDER INDIVIDUAL PAY ITEMS.

2035 Vista Parkway
West Palm Beach, FL 33411
Phone No. 561.887.2220
Fax No. 561.887.1110
e. Cert No. 6081-1B No. 7055

WGI

REVISIONS		BY	
NO.	DATE	DESCRIPTION	

CAD	JOB NO.	2069.03	DRAWN	DAM
TOTAL SHEETS	12	DESIGNED	TJW	
DATE	8/1/17	CHECKED	CBL	
SCALE	AS SHOWN	QC	BCR	

ENGINEER OF RECORD
TIMOTHY J. WORLINE, P.E.
P.E. # 65906

PROJECT:
BINKS POINTE
PEDESTRIAN BRIDGE

TASK:
ENLARGED PREFABRICATED
PEDESTRIAN BRIDGE PLAN

PRODUCTION PHASE

SHEET:
S1.1

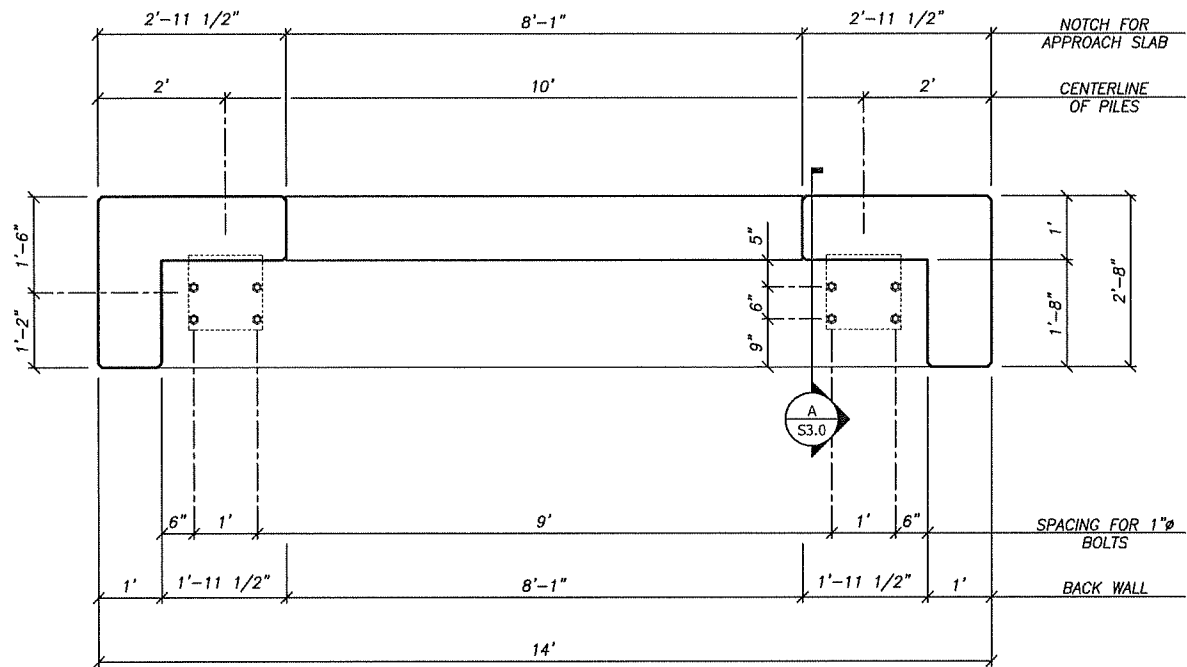

1 END BENT PLAN
(FOR WEST END) (FOR EAST END)
GRAPHIC SCALE IN FEET

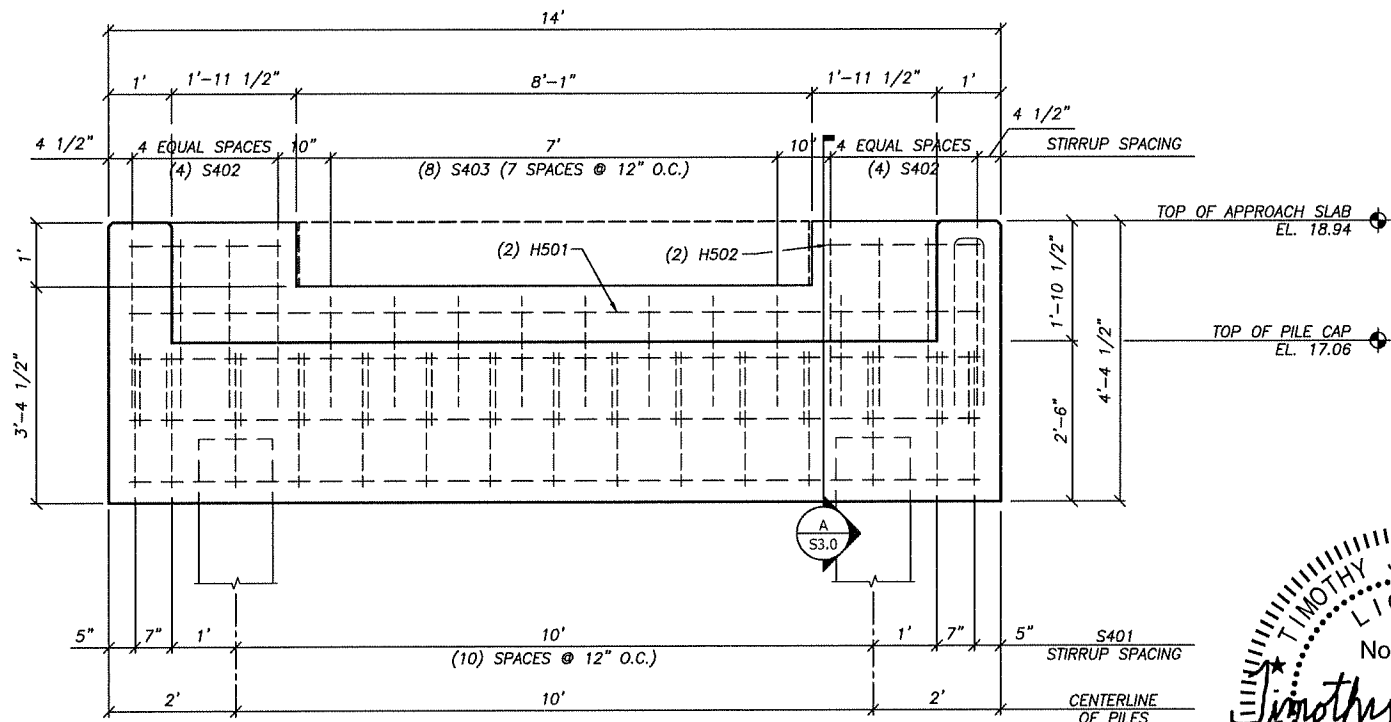

2 END BENT ELEVATION
GRAPHIC SCALE IN FEET

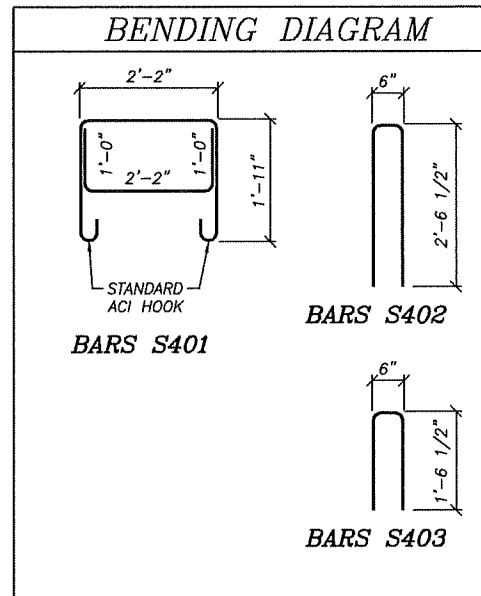

ESTIMATED END BENT QUANTITIES		
ITEM	UNIT	QUANTITY
CLASS II CONCRETE (END BENT PILE CAP)	CU. YDS.	5
REINFORCING STEEL (END BENT PILE CAP)	LBS.	499

BILL OF REINFORCING STEEL					
MARK	SIZE	NUMBER REQUIRED (1 EACH)	TOTAL LENGTH	BENDING	WEIGHT (LBS.)
H501	#5	2	13'-4"	STRAIGHT	28
H502	#5	2	2'-4 1/2"	STRAIGHT	5
T801	#8	3	13'-4"	STRAIGHT	107
M802	#8	3	13'-4"	STRAIGHT	107
B803	#8	2	13'-4"	STRAIGHT	71
S401	#4	16	10'-6"	BARS S401	112
S402	#4	12	6'-0"	BARS S402	48
S403	#4	8	4'-0"	BARS S403	21

ALL CONCRETE MIN. $f'_c = 4,000$ PSI @ 28 DAYS.
ALL REINFORCING STEEL ASTM A615 GR 60.
SEE CONSTRUCTION SPECIFICATIONS FOR ADDITIONAL REQUIREMENTS.

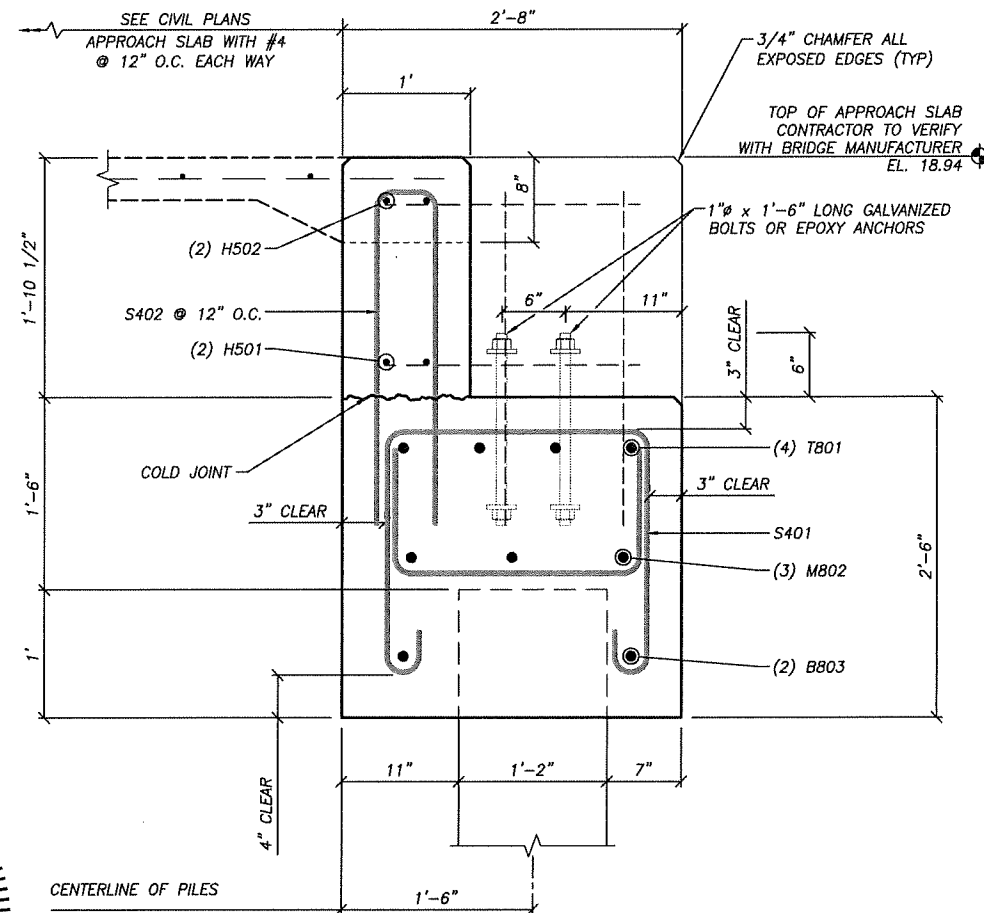

A SECTION A - A
GRAPHIC SCALE IN FEET

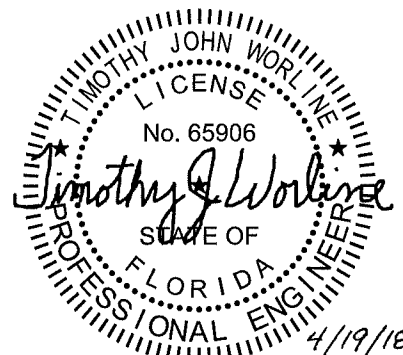

2035 Vista Parkway
West Palm Beach, FL 33411
Phone No. 561.687.2220
Fax No. 561.687.1110
e-mail: Cert No. 6891 - LE No. 7055

WGI

PROJECT: BINKS POINTE
PEDESTRIAN BRIDGE
PREFABRICATED PEDESTRIAN
BRIDGE DETAILS

CAD: JOB NO. 2069.03
TOTAL SHEETS 12
DATE 8/1/17
SCALE AS SHOWN

DRAWN: DAM
DESIGNED: TJW
CHECKED: CBL
QC: BCR

PRODUCTION PHASE

SHEET: S3.0

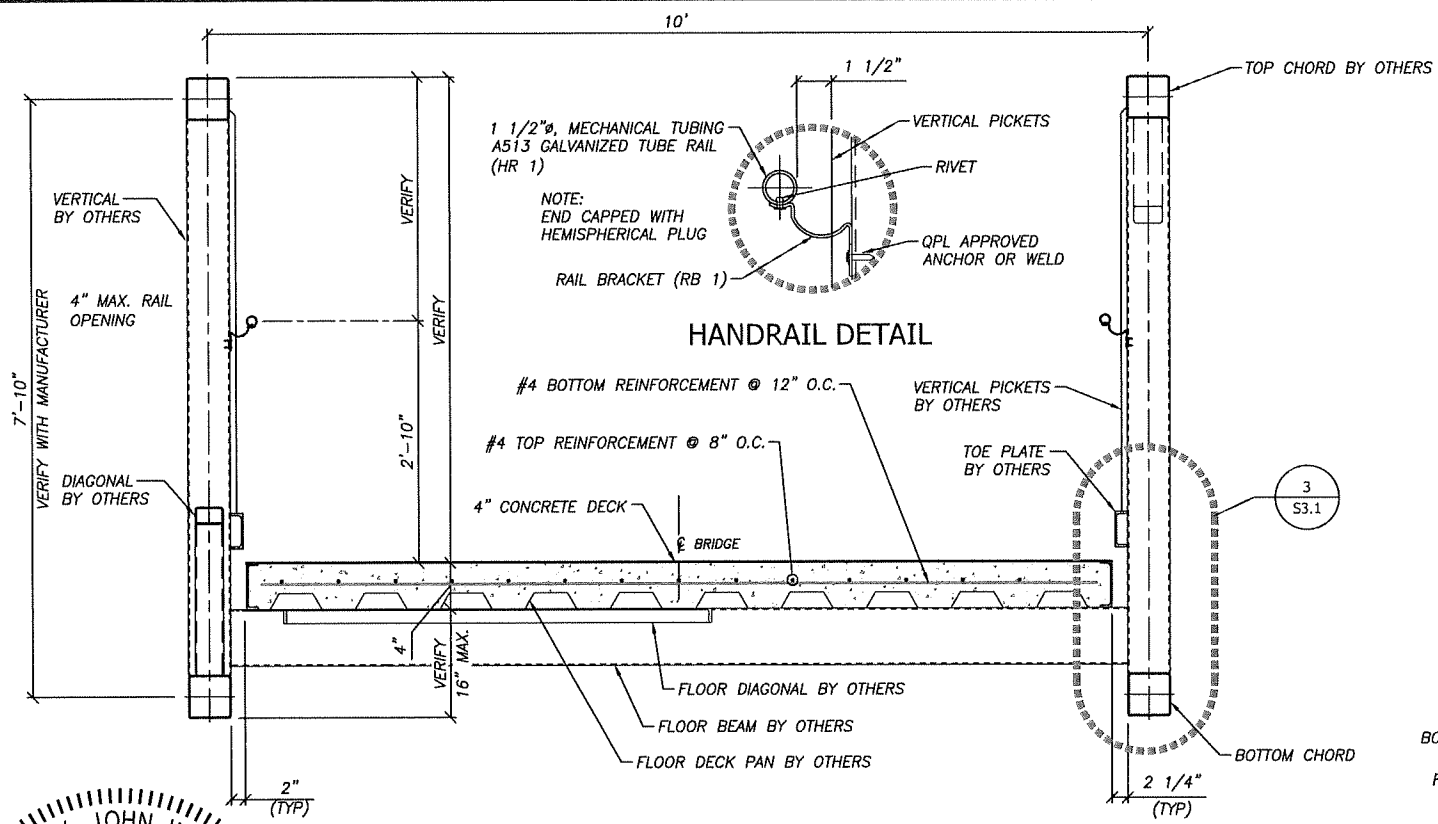
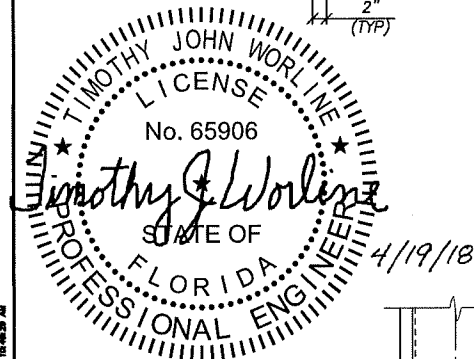

1 TYPICAL BRIDGE SECTION
S3.1 NOT TO SCALE

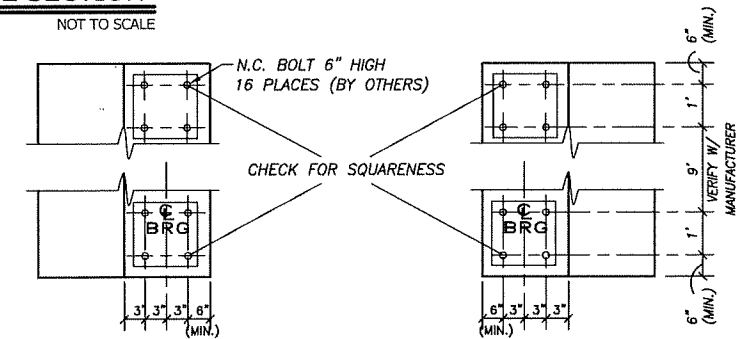

4 TYPICAL CONNECTION DETAIL
S3.1 NOT TO SCALE

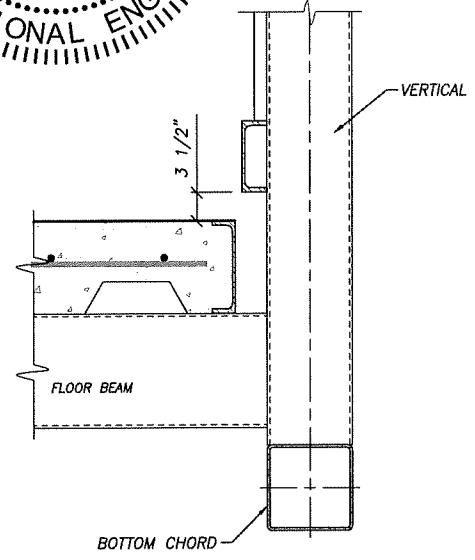

3 TYPICAL CONNECTION DETAIL
S3.1 NOT TO SCALE

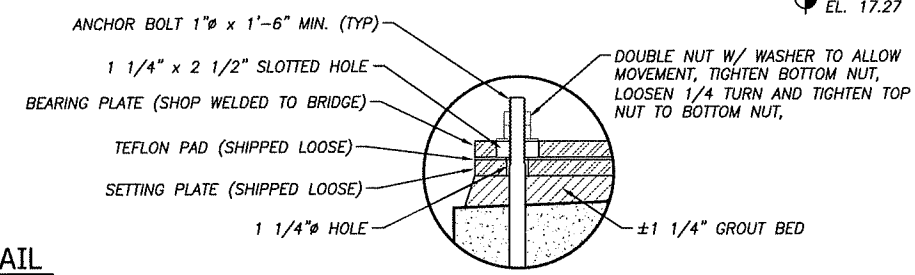

5 BEARING PLATES DETAIL
S3.1 NOT TO SCALE

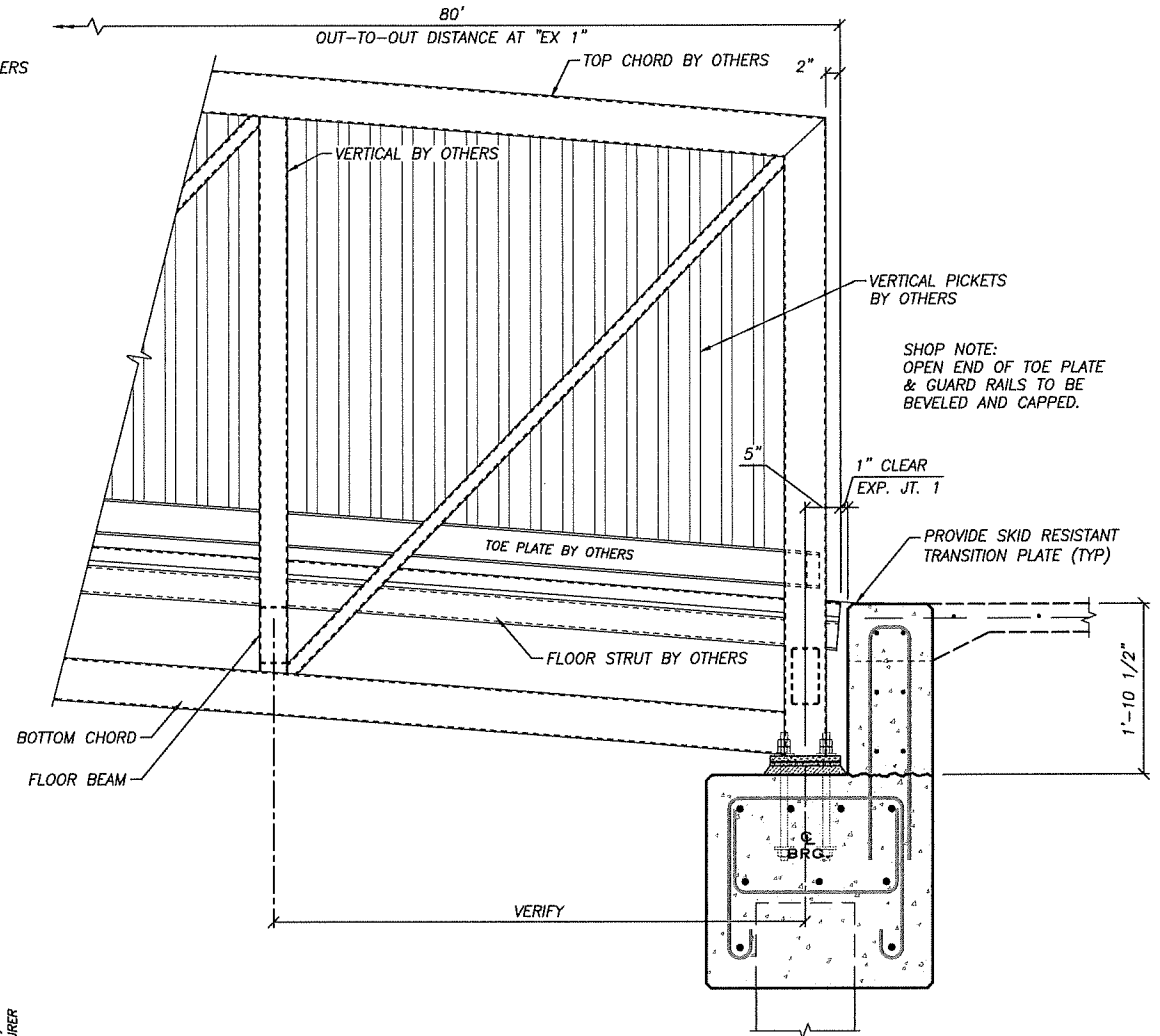

2 TYPICAL ABUTMENT ELEVATION
S3.1 NOT TO SCALE

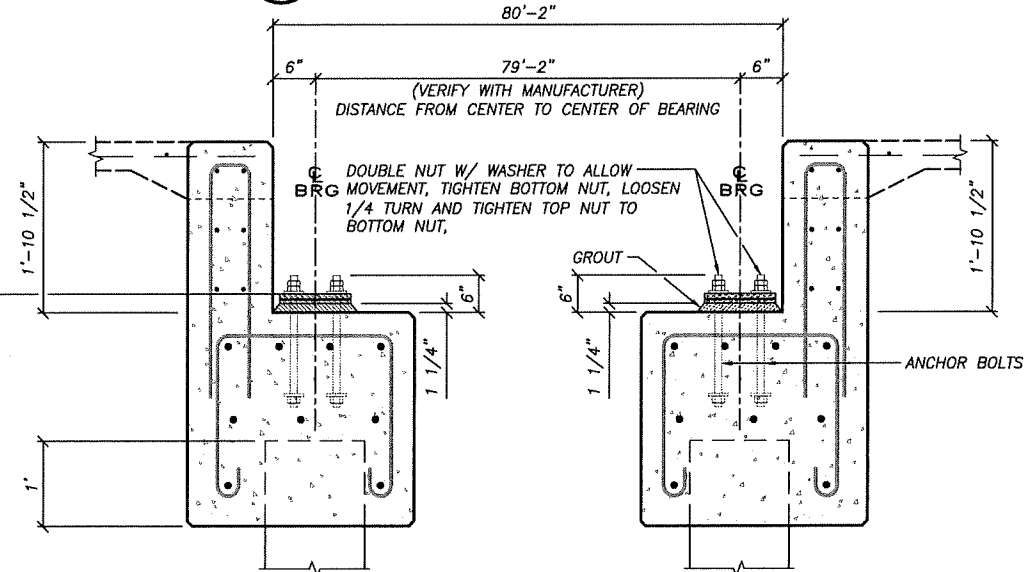

6 ABUTMENT LAYOUT SECTION
S3.1 NOT TO SCALE

2035 Vesta Parkway
West Palm Beach, FL 33411
Phone No. 561.687.2220
Fax No. 561.687.1110
Cert. No. 6591 - LB No. 7055

WGI

REVISIONS		NO.	DATE	DESCRIPTION	BY

CAD	JOB NO.	DAM	DESIGNED	CHECKED	QC	BCR
	2069.03		12	8/1/17		

ENGINEER OF RECORD	PROJECT	TASK
TIMOTHY J. WORLINE, P.E. P.E. # 65906	BINKS POINTE PEDESTRIAN BRIDGE	PREFABRICATED PEDESTRIAN BRIDGE DETAILS

PRODUCTION PHASE

SHEET:
S3.1

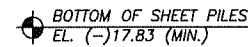

1 0.5 0
GRAPHIC SCALE IN FEET



0.5 0.25 0
GRAPHIC SCALE IN FEET

NOTE:
BOLLARD AND RAILING ASSEMBLY TO BE PAINTED. FOLLOW
PAINT SPECIFICATION FOR BRIDGE AND MATCH COLOR.

1 0.5 0
GRAPHIC SCALE IN FEET



0.5 0.25 0
GRAPHIC SCALE IN FEET

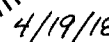

PROJECT:

SHEET:
S3.2

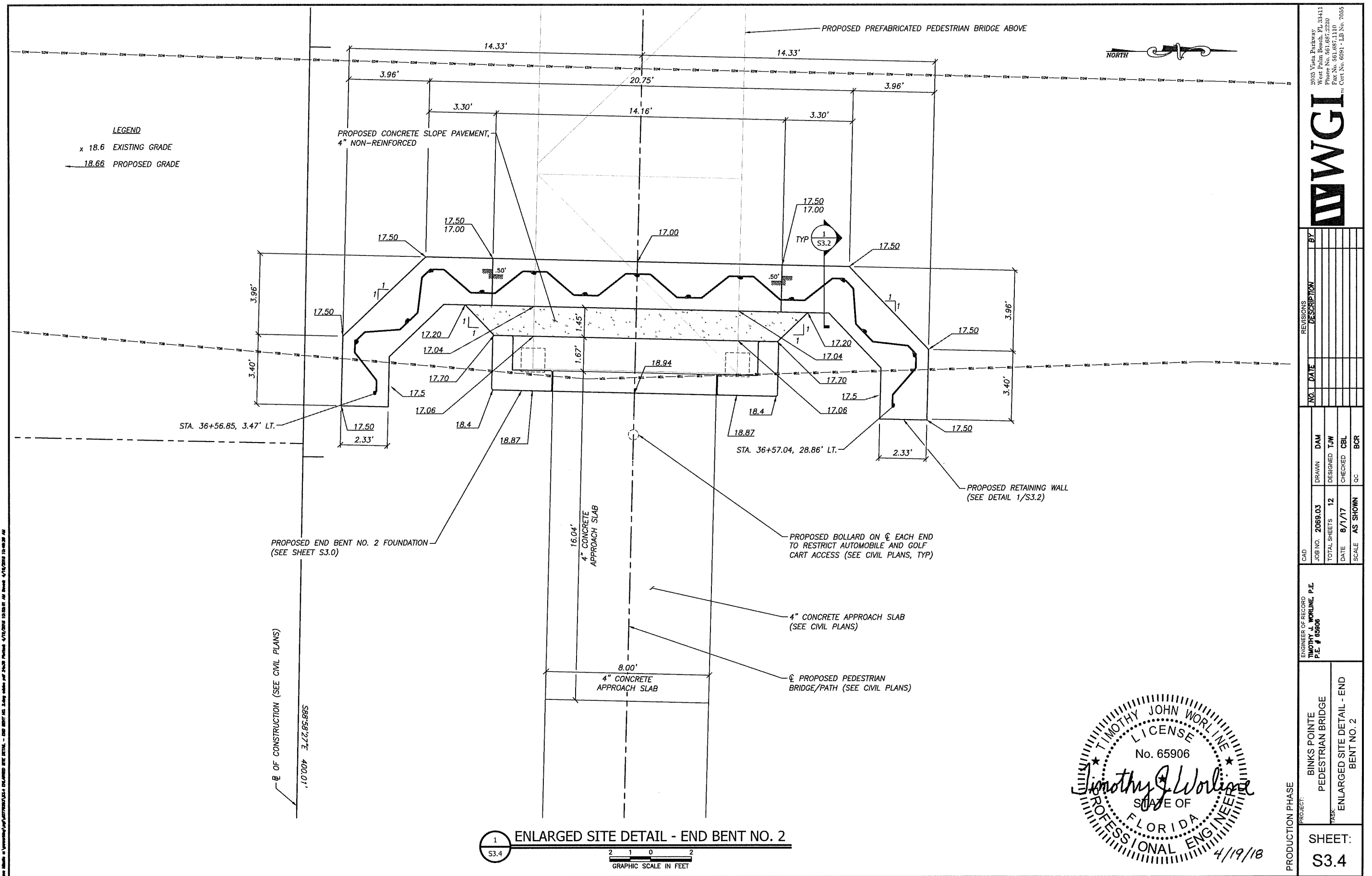



BEARING LOCATIONS & BRIDGE SEAT ELEVATIONS						
BENT/ PIER	A (m.)	B (in.)	C (ft.)	D (m.)	E (in.)	F (ft.)
1	6.75	NA	5'-0"	3.5	NA	16.61
2						
3						
4						
5						



BEARING PLATE DIMENSIONS				
SPAN	G	H	J	K
	(in.)	(in.)	(in.)	(in.)
1	6	3	15.5	11.5
2				
3				
4				

COMPANY CONTACT INFORMATION	
COMPANY	CONTECH ENGINEERING SOLUTIONS
ADDRESS	8301 STATE HIGHWAY 29 NORTH ALEXANDRIA, MN 56308
CONTACT	LEE HANSON
PHONE	513-645-7738
E-MAIL	LHANSON@CONTECHES.COM

BRIDGE REACTIONS				
		SPAN 1		
		P (KIP)	T (KIP)	L (KIP)
DEAD LOAD		14.0		
UNIFORM LIVE LOAD		18.0		
VEHICLE LOAD		2.0		
WIND UPLIFT	WINDWARD	6.7		
	LEEWARD	2.3		
WIND ¹	TRANSVERSE		12.5	
	VERTICAL ^{1/2}	5.2		
THERMAL				2.0

- 1 P - Unfactored Vertical Load each Bearing Plate (4 per Span)
T - Unfactored Transverse Load each Bent/Pier (2 per Span)
L - Unfactored Longitudinal Load each Bearing Plate (4 per Span)
- 2 Downward vertical loads are positive (+), upward vertical loads are negative (-).
- 3 The horizontal wind load acting at the c.g. of the truss creates a transverse shear and a vertical couple at the top of each pier/bearing location.
- 4 Design Specifications
 - FDOT Structures Manual, current Edition and supplements thereto.
 - American Association of State Highway and Transportation Officials (AASHTO) Load and Resistance Factor (LRFD) Bridge Design Specifications, current Edition and supplements thereto.
 - AASHTO LRFD Guide Specifications for the Design of Pedestrian Bridges, current Edition
 - FDOT Plans Preparation Manual, current Edition
- 5 Construction Specifications
 - FDOT Standard Specifications for Road and Bridge Construction, current Edition and supplements thereto

Digitally signed by
homelviga@contech-cpi.com
DN: cn=homelviga@contech-
cpi.com
Date: 2017.11.28 11:00:04
-06'00'

[illegible]