



# SEXTON ENGINEERING ASSOCIATES, INC.

Consulting Engineers and Surveyors

## SURVEYOR'S CERTIFICATION

**PLAT NAME:**

PBIEC Estates of Wellington Countryplace P.U.D.

**PROJECT SURVEYOR:**

Sexton Engineering Associates, Inc.  
110 Ponce de Leon Street, Suite 100  
Royal Palm Beach, FL 33411  
Phone: (561) 792-3122  
Fax: (561) 792-3168  
Surveying & Mapping Business No. 0006837

As a Professional Surveyor and Mapper of the State of Florida, to the best of my knowledge, information, and belief, I hereby certify that the Permanent Reference Monuments (PRM's) for PBIEC Estates of Wellington Countryplace P.U.D., have been set in accordance with the plat recordation process and the Subdivision and Development Regulation of the Village of Wellington, Florida, in effect on the date of plat approval.

By: \_\_\_\_\_

Michael F. Sexton, P.S.M.  
Professional Surveyor and Mapper #3596

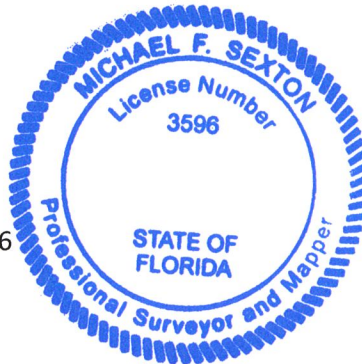

Date: May 24, 2019

Exhibit E - Surveyors Certificate re PRMs