

LAND USE	ACREAGE
COMMERCIAL HIGH (CH)	243.70 AC.
RESIDENTIAL HIGH (HR8)	49.75 52.20 AC.
RESIDENTIAL MEDIUM (MR5)	40.00 AC.
WETLANDS/ UPLAND BUFFERS	27.20 18.76 AC.*
WATER MANAGEMENT TRACTS	125.44 126.76 AC.
DRAINAGE DETENTION EASEMENTS	3.95 AC.

*INCLUDES ~~2.14~~ **16.57** ACRES OF WETLAND PRESERVES AND ~~3.64~~ **2.19** ACRES OF UPLAND BUFFERS.

LAND USE	MINIMUM ACREAGE	MAXIMUM ACREAGE
COMMERCIAL HIGH (CH)	185	250
RESIDENTIAL HIGH (HRB)	10	50 55
RESIDENTIAL MEDIUM (MRS) (CLF) USE ONLY	35	60
WETLAND/ BUFFER	22 18	N/A
ACTIVE PARK	10	10
*LAKES/ DRAINAGE CONTROL	132	N/A

*ACREAGE INCLUDES LAKES, WATER MANAGEMENT AREAS AND WETLANDS/PRESERVES.

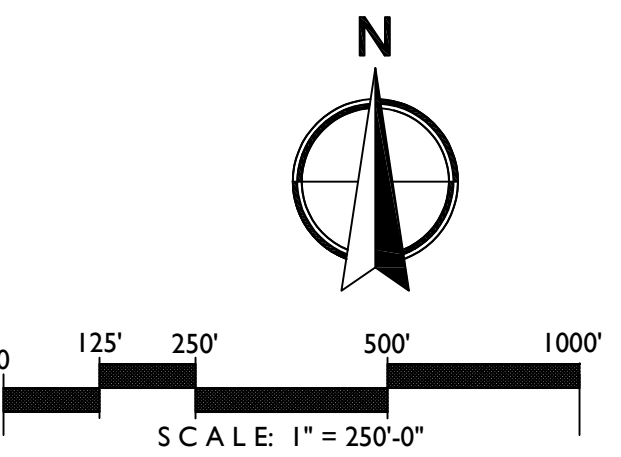
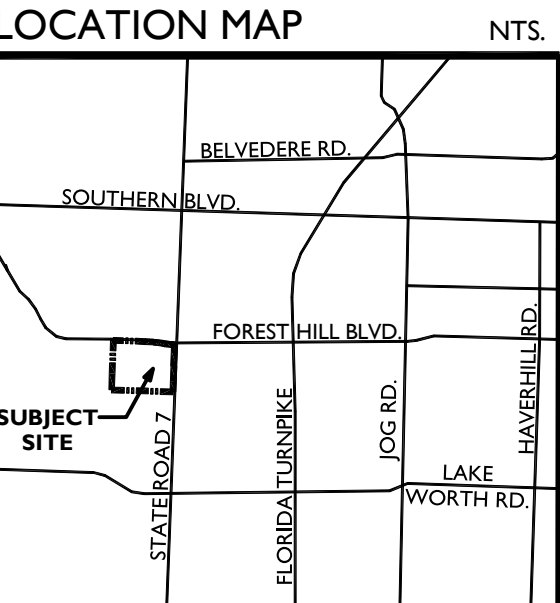

MUPD	ACREAGE	MINIMUM SF	MAXIMUM SF
A	8.67	62,546	103,546
B	29.78	87,000	163,000
C	23.92	87,000	163,000
D	22.13	80,000	148,000
E	10.30	41,000	75,000
F	35.74	98,000	221,082
G	110.96	1,310,000	1,432,000
PUD			
POD A	46.14		
POD B	26.00		
POD C	27.00		

TOTAL FOR MUPD A-G NOT TO EXCEED LEASABLE SQUARE FOOTAGE = 2,159,082

*TOTAL NOT TO EXCEED PM PEAK HOUR TRIPS = 4,296

I. MAY INCLUDE A CROSSWALK SYSTEM WITH SOLAR POWERED FLASHING LED CROSSWALK SIGNS AND IN-PAVEMENT MARKER LIGHTS. THE CROSSWALK SYSTEM MAY BE ACTIVATED VIA PUSH BUTTONS OR AUTOMATIC ACTIVATION METHODS. PER PETITION 18-66 (2018-25ASA 58).

TRACTS	WETLAND PRESERVE (ACRE)	UPLAND BUFFER (ACRE)	WETLAND PRESERVE AND UPLAND BUFFER (ACRE)
W-1	3.85	-	3.85
W-1A(1)	97.0	-	97.0
W-1B	0.07	-	0.07
W-2	0.77	-	0.77
W-3	3.26	0.63	3.89
W-5 (4)	14.61	3.01	17.62
W-6 (2)	1.15	-	1.15
W-7 (3)	0.94	-	0.94
TOTAL	24.65	3.64	28.29