

Resolution Exhibit B - Site Plan

SITE DATA

PETITION NUMBER	2021- SPR
NAME OF PROJECT	GLOBAL DRESSAGE COMPLEX AKA EQUESTRIAN VILLAGE
PROPOSED USE	
EXISTING FUTURE LAND USE DESIGNATION	COMMERCIAL RECREATION
PROPOSED FUTURE LAND USE DESIGNATION	COMMERCIAL RECREATION
EXISTING ZONING DISTRICT	PUD/EO2D
PROPOSED ZONING DISTRICT	PUD/EO2D
SECTION 16, TOWNSHIP 44, RANGE 41 EAST	
TOTAL SITE AREA	59.37 AC
PROPERTY CONTROL NUMBERS	73414416000005040 73414416000005030 73414416000005050 73414416000005060 73414416000005070

PERMANENT FACILITIES	ENCLOSED FLOOR AREA	BUILDING AREA
TIKI HUT	0 SF	1,450 SF
BARN 1 (96 STALLS)	12,295 SF	19,698 SF
BARN 2 (96 STALLS)	12,295 SF	19,698 SF
SHOW OFFICE	927 SF	1,242 SF
HORSE WASH FACILITY/RESTROOM 1	680 SF	1,715 SF
HORSE WASH FACILITY 2	0 SF	980 SF
MANURE BINS	0 SF	1,600 SF
COVERED EQUESTRIAN RING (210'X360')	0 SF	80,400 SF
CELL TOWER	717 SF	717 SF
SUBTOTAL	26,914 SF	127,500 SF

TEMPORARY FACILITIES	ENCLOSED FLOOR AREA	BUILDING AREA
EVENT TENTS	0 SF	20,861 SF
TEMPORARY STABLES	0 SF	31,768 SF
SUBTOTAL	0 SF	52,629 SF

TOTAL 26,914 SF 180,129 SF

FAR - ENCLOSED FLOOR AREA / (TOTAL SITE AREA x 43,560)
ENCLOSED FLOOR AREA 26,914 SF
FLOOR AREA RATIO (0.10 MAX.) 0.01

BUILDING COVERAGE - BUILDING AREA / (TOTAL SITE AREA x 43,560)
BUILDING AREA 175,608 SF
BUILDING COVERAGE (10% MAX.) 6.8%

TEMPORARY EVENT SEATING:
TEMPORARY SEATING (SPECIAL EVENTS) 1,065 SEATS MAX.
TEMPORARY EVENT TENT 1 235 SEATS MAX.
TEMPORARY EVENT TENT 2 200 SEATS MAX.
TOTAL 1,500 SEATS MAX.

IMPERVIOUS AREA 9.94 AC
BUILDINGS (PERMANENT) 2.94 AC
PAVEMENT/CONCRETE 7.00 AC

PERVIOUS AREA 49.43 AC
OPEN SPACE

BUILDING HEIGHT
EQUESTRIAN STABLES 35' MAX
COVERED-EQUESTRIAN RING 35' MAX

FINISHED FLOOR ELEVATION 17.50 FT NGVD MIN

PARKING CALCULATIONS:

PARKING REQUIRED:

	MIN. STANDARD	QUANTITY REQUIRED	REQUIRED
SHOW OFFICE/RESTROOMS	1 SP/300 SF	2,602 SF	9
PERMANENT STALLS	1 SP/3 STALLS	192 STALLS	64
TEMPORARY STALLS	1 SP/300 SF	24,590 SF	82
TEMPORARY EVENT TENTS	1 SP/3 STALLS	174 STALLS	58
TEMPORARY EVENT SEATING	1 SP/3 SEATS	435 SEATS	145
TEMPORARY EVENT SEATING	1 SP/EMP.	25 EMP.	25
TOTAL REQUIRED			738
HANDICAP REQUIRED			15

PARKING PROVIDED:

PERMANENT:	
PAVED PARKING	213
GRASS PARKING (BARN)	170
SUBTOTAL	383
TEMPORARY:	
SHELL ROCK	29
SAND RING	158
GRASS	319
SUBTOTAL	506
TOTAL SPACES PROVIDED	889
HANDICAP PROVIDED	18
ALTERNATE TRAILER PARKING PROVIDED	72
VENDOR TENTS	60
VENDOR TRAILERS	20

HORSE SHOW SERVICES
RETAIL COMPLEX
FLU: COMMUNITY COMMERCIAL
Z: PUD

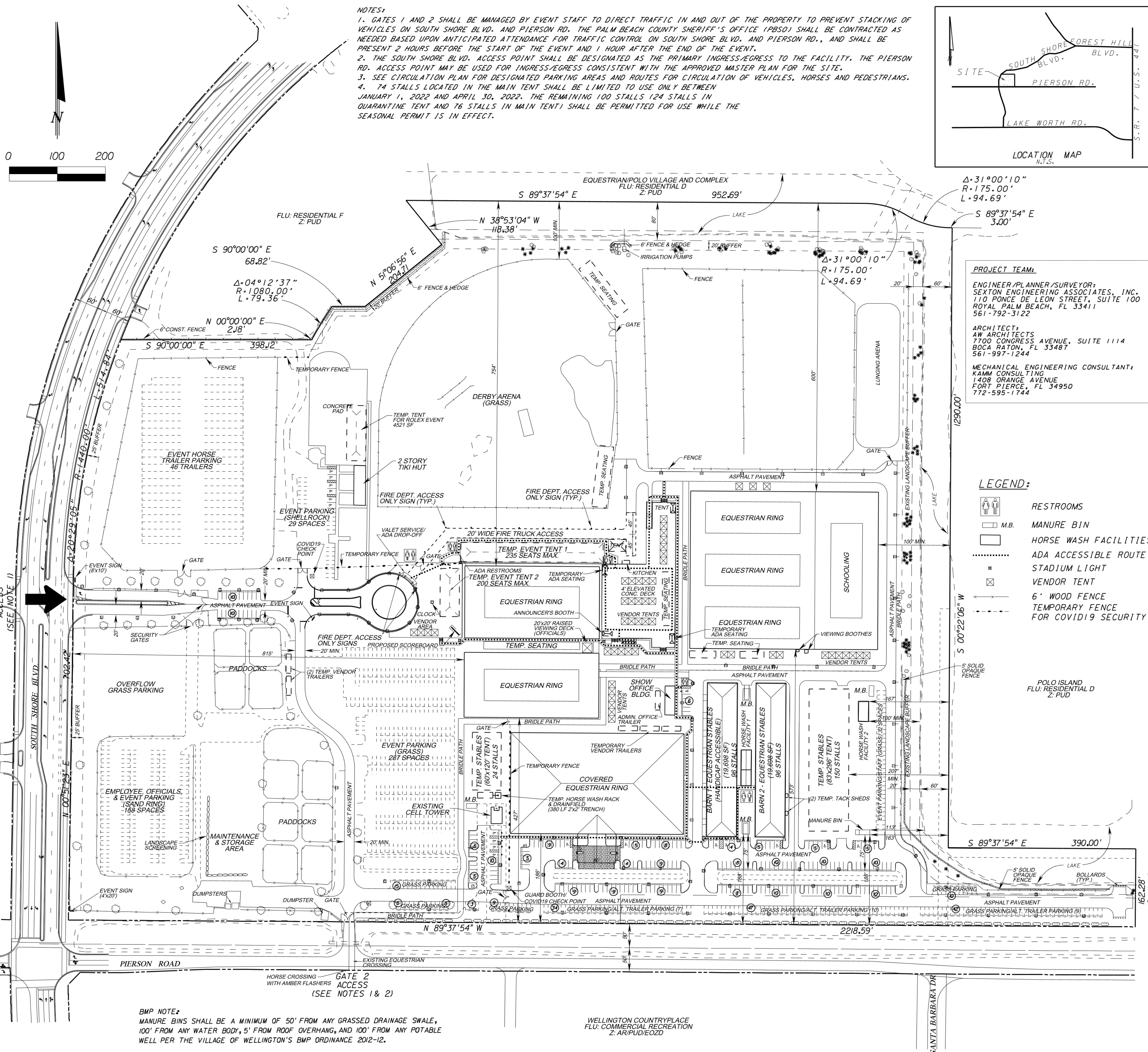

2021/ 2022
SEASONAL EQUESTRIAN PERMIT
SITE PLAN

S. SEXTON ENGINEERING ASSOCIATES, INC.

CONSULTING ENGINEERS AND SURVEYORS

110 PONCE DE LEON STREET, SUITE 100
ROYAL PALM BEACH, FLORIDA 33411

PHONE 561-792-3122 FAX 561-792-3168
FL. REGISTRATIONS: LB0006837, EB 0007864

GLOBAL DRESSAGE COMPLEX
WELLINGTON, FLORIDA

PROJ. NO. 1428740
DATE 10/11/2021
SHEET 1 OF 1
SCALE 1" = 100'